

PELLET STOVE

## Blade2 12 Up



For all updates visit [www.edilkamin.com](http://www.edilkamin.com)

The original language of this manual is Italian

EDILKAMIN S.p.A., with registered offices in Via P. Moscati 8 -  
20154 Milan - tax code and VAT number  
00192220192

Declares, under its sole responsibility, that:  
The pellet stove mentioned below is conforming with EU  
Regulation 305/2011 and harmonised EU standard EN  
14785:2006

PELLET STOVE, tradename EDILKAMIN, model BLADE2 12 UP

SERIAL NUMBER: Nameplate reference  
Performance declaration: (DoP - EK n° 216):  
Nameplate reference

And also declares that:  
the BLADE UP wood pellet stove satisfies the requirements of  
the following European directives:  
2014/35/UE - Low Voltage Directive  
2014/30/UE - Electromagnetic Compatibility Directive  
2011/65/EU - RoHS  
2009/125/EU - Ecodesign  
2010/30/EU - Labelling

Dear Sir/Madam

Congratulations on choosing our product. Before you use it, please read this manual carefully, to get the best from your new appliance in total safety.

This manual is an integral part of the product.

Keep it with care for the service life of the product.

If you lose it, you can request a copy or download it from [www.edilkamin.com](http://www.edilkamin.com)

Readers of this manual

This manual is addressed to:

- those who will use the product at home ("USER");
- the technician who will install the product ("INSTALLER").

The target person of each page is indicated in a band at the bottom of the page (USER or INSTALLER).

After unpacking the product, check the condition and completeness of the contents.

In the event of error, immediately contact the retailer where the purchase was made, providing them with a copy of the warranty booklet and the sales receipt.

The appliance must be correctly sized, installed, maintained and operated in compliance with local and national law and European regulations. For the installation, and for anything not specifically indicated in the manual, observe local regulations.

The diagrams provided in this manual are for illustration purposes only: they do not always strictly refer to your specific model, and are not binding in any way.

The product is uniquely identified by a number, the "counterfoil", which is indicated on the warranty certificate.

Please keep:

- the warranty certificate accompanying the product
- the purchase receipt given to you by the retailer
- the declaration of conformity given to you by the installer.

Check local regulations.

The warranty conditions are given in the warranty certificate accompanying the product and on the website [www.edilkamin.com](http://www.edilkamin.com).



The product's CE marking plate is located on the back.

### MEANING OF SYMBOLS

In some parts of the manual the following symbols are used:



#### PLEASE NOTE:

carefully read and understand the message in question, since failure to follow the instructions in it could cause serious damage to the product and put the safety of those using it at risk.



#### INFORMATION:





failure to comply with these requirements will compromise product use.

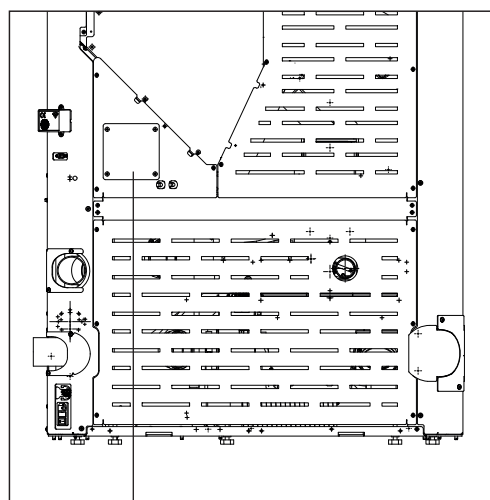

#### OPERATING SEQUENCE:

follow the instructions for the operations described



				21		DoP n. EK2 16			
 <b>EDILKAMIN</b>		Modello		12		12		12	
SIA 14720-2014		1800		12		12		12	
<b>BLADEZ 12 UP</b>		12		12		12		12	
Numero di serie: 14720-2014		12		12		12		12	
12		12		12		12		12	
12		12		12		12		12	
12		12		12		12		12	
12		12		12		12		12	
12		12		12		12		12	
12		12		12		12		12	
12		12		12		12		12	
12		12		12		12		12	
12		12		12		12		12	
12		12		12		12		12	
12		12		12		12		12	
12		12		12		12		12	
12		12		12		12		12	
12		12		12		12		12	
12		12		12		12		12	
12		12		12		12		12	
12		12		12		12		12	
12		12		12		12		12	
12		12		12		12		12	
12		12		12		12		12	
12		12		12		12		12	
12		12		12		12		12	
12		12		12		12		12	
12		12		12		12		12	
12		12		12		12		12	
12		12		12		12		12	
12		12		12		12		12	
12		12		12		12		12	
12		12		12		12		12	
12		12		12		12		12	
12		12		12		12		12	
12		12		12		12		12	
12		12		12		12		12	
12		12		12		12		12	
12		12		12		12		12	
12		12		12		12		12	
12		12		12		12		12	
12		12		12		12		12	
12		12		12		12		12	
12		12		12		12		12	
12		12		12		12		12	
12		12		12		12		12	
12		12		12		12		12	
12		12		12		12		12	
12		12		12		12		12	
12		12		12		12		12	
12		12		12		12		12	
12		12		12		12		12	
12		12		12		12		12	
12		12		12		12		12	
12		12		12		12		12	
12		12		12		12		12	
12		12		12		12		12	
12		12		12		12		12	
12		12		12		12		12	
12		12		12		12		12	
12		12		12		12		12	
12		12		12		12		12	
12		12		12		12		12	
12		12		12		12		12	
12		12		12		12		12	
12		12		12		12		12	
12		12		12		12		12	
12		12		12		12		12	
12		12		12		12		12	
12		12		12		12		12	
12		12		12		12		12	
12		12		12		12		12	
12		12		12		12		12	
12		12		12		12		12	
12		12		12		12		12	
12		12		12		12		12	
12		12		12		12		12	
12		12		12		12		12	
12		12		12		12		12	
12		12		12		12		12	
12		12		12		12		12	
12		12		12		12		12	
12		12		12		12		12	
12		12		12		12		12	
12		12		12		12		12	
12		12		12		12		12	
12		12		12		12		12	
12		12		12		12		12	
12		12		12		12		12	
12		12		12		12		12	
12		12		12		12		12	
12		12		12		12		12	
12		12		12		12		12	
12		12		12		12		12	
12		12		12		12		12	
12		12		12		12		12	
12		12		12		12		12	
12		12		12		12		12	
12		12		12		12		12	
12		12		12		12		12	
12		12		12		12		12	
12		12		12		12		12	
12		12		12		12		12	
12		12		12		12		12	
12		12		12		12		12	
12		12		12		12		12	
12		12		12		12		12	
12		12		12		12		12	
12		12		12		12		12	
12		12		12		12		12	
12		12		12		12		12	
12		12		12		12		12	
12		12		12		12		12	
12		12		12		12		12	
12		12		12		12		12	
12		12		12		12		12	
12		12		12		12		12	
12		12		12		12		12	
12		12		12		12		12	
12		12		12		12		12	
12		12		12		12		12	
12		12		12		12		12	
12		12		12		12		12	
12		12		12		12		12	
12		12		12		12		12	
12									

- The appliance is not designed for use by people, including children, with limited physical, sensory and mental capacities.
- The appliance is not intended to be used for cooking.
- The appliance is designed to burn UNI EN ISO 17225-2 category A1 wood pellets, in the amounts and manner described in this manual.
- The appliance is designed for use indoors, in normal conditions of ambient humidity.
- Keep the product in a dry place out of the weather.
- For the legal and company warranties, refer to the warranty certificate inside the product: neither Edilkamin nor the reseller are liable for damage resulting from incorrect installation or maintenance.

Safety risks may be caused by:

- installation in unsuitable conditions. In particular, conditions of fire hazard. **DO NOT INSTALL THE PRODUCT IN AREAS SUBJECT TO THE RISK OF FIRE.**
- contact with fire and hot parts (e.g. glass panel and pipes). **DO NOT TOUCH THE STOVE'S HOT PARTS;** always wear the gloves when working with the stove, even if switched off, when it is still hot. Failure to do so can result in burns.
- contact with live electrical equipment (internal). **DO NOT ACCESS THE INTERNAL ELECTRICAL EQUIPMENT WHILE THE APPLIANCE IS POWERED ON.** Electrocution hazard.
- use of improper ignition aids (e.g. alcohol). **DO NOT IGNITE OR BOOST THE FLAME WITH FLUID SPRAYS OR A FLAME TORCH.**
- use of fuel other than wood pellets. **DO NOT BURN WASTE MATTER, PLASTIC OR OTHER MATERIALS THAN WOOD PELLETS IN THE HEARTH.** The product may be soiled, the flue may catch fire, and environmental damage may ensue.
- cleaning the hearth when hot. **DO NOT CLEAN THE HEARTH WITH A VACUUM CLEANER WHILE IT IS HOT.** Risk of damage to the cleaner and smoke in the room.
- cleaning the fumes duct with cleaning products. **DO NOT CLEAN THE PRODUCT WITH FLAMMABLE PRODUCTS.** Risk of fire and blowback.
- cleaning the hot glass pane with unsuitable cleaning products. **DO NOT CLEAN THE GLASS WHILE IT IS HOT WITH WATER OR ANY OTHER PRODUCT THAN THE RECOMMENDED GLASS CLEANING PRODUCTS.** Risk of cracking and irreparable damage to the glass.
- storing flammable materials within the safety clearance indicated in this manual. **DO NOT PLACE LAUNDRY ON THE PRODUCT. DO NOT PLACE DRYING RACKS WITHIN THE SAFETY CLEARANCE.** Keep flammable fluids away from the product. Fire hazard.
- blocking the aeration vents and air intakes in the room. **DO NOT BLOCK THE AERATION VENTS OR FLUE.** Risk of smoke returning into the room with consequent damage and injury.
- use of the product as a support or ladder. **DO NOT CLIMB ONTO THE PRODUCT OR USE IT AS A SUPPORT.** Risk of damage and injury.
- use of the stove with the hearth open. **DO NOT USE THE PRODUCT WITH ITS DOOR OPEN.**
- incandescent material projected from the open door. **DO NOT throw incandescent material outside the appliance.** Fire hazard.
- use of water in case of fire. **CALL THE AUTHORITIES IF A FIRE BREAKS OUT.**

Please use all normal precautions for a household heating appliance.

If you have doubts, please do not take any action, but contact the retailer or the installer.

For reasons of safety, read the user instructions included in this manual.

The names of Edilkamin official, authorised technical assistance centres (TAC) and distributors are available **ONLY** at [www.edilkamin.com](http://www.edilkamin.com)

**Blade up**  
**ACCIAIO (cm)**

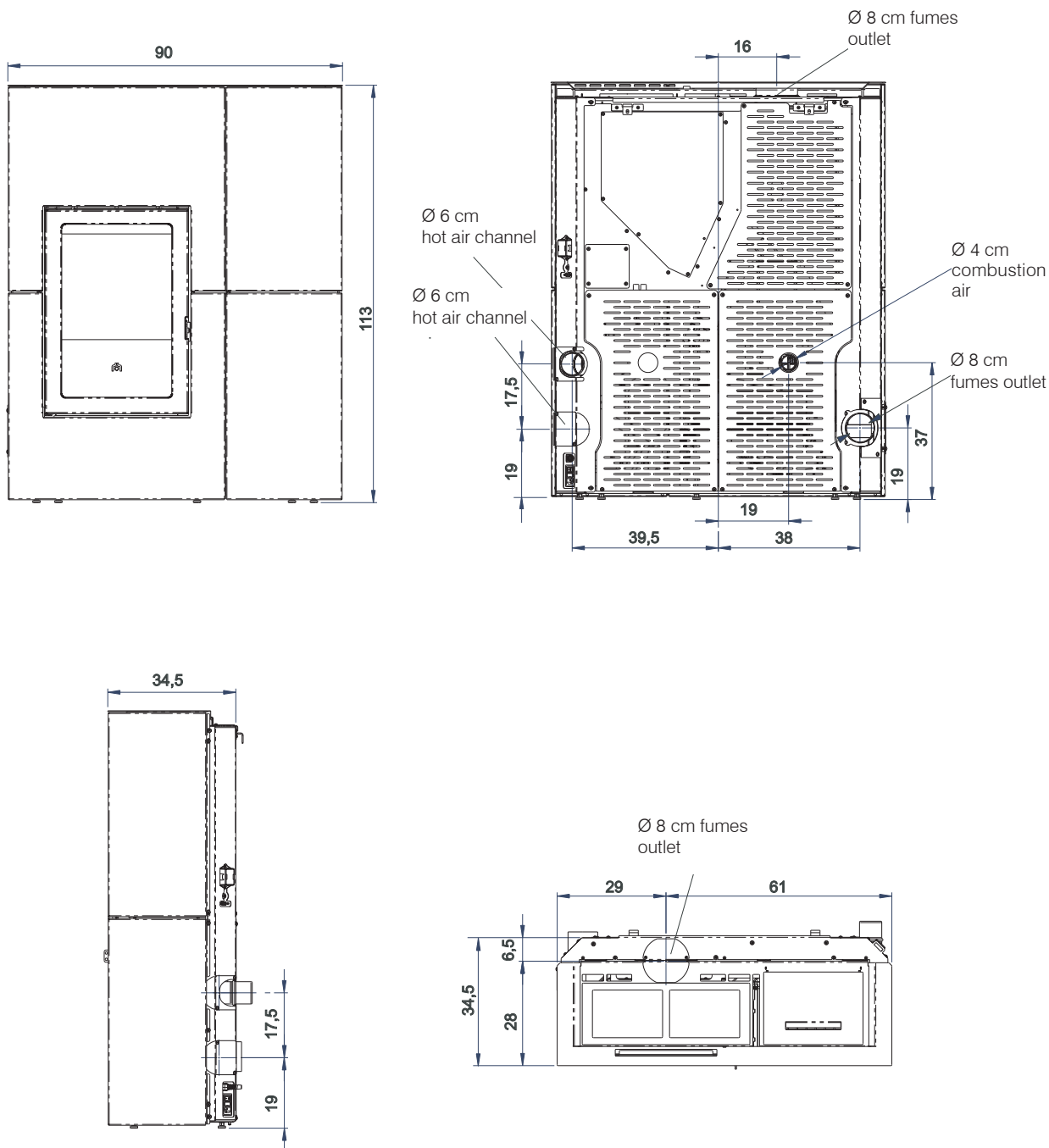

NOTE:

- The names of Edilkamin official, authorised technical assistance centres and distributors are available ONLY at [www.edilkamin.com](http://www.edilkamin.com).
- Ducting length and vent outlet temperature, depend on the conditions of use and installation. It is therefore suggested to size the ducting system.

**Blade up  
PIETRA OLLARE (cm)**

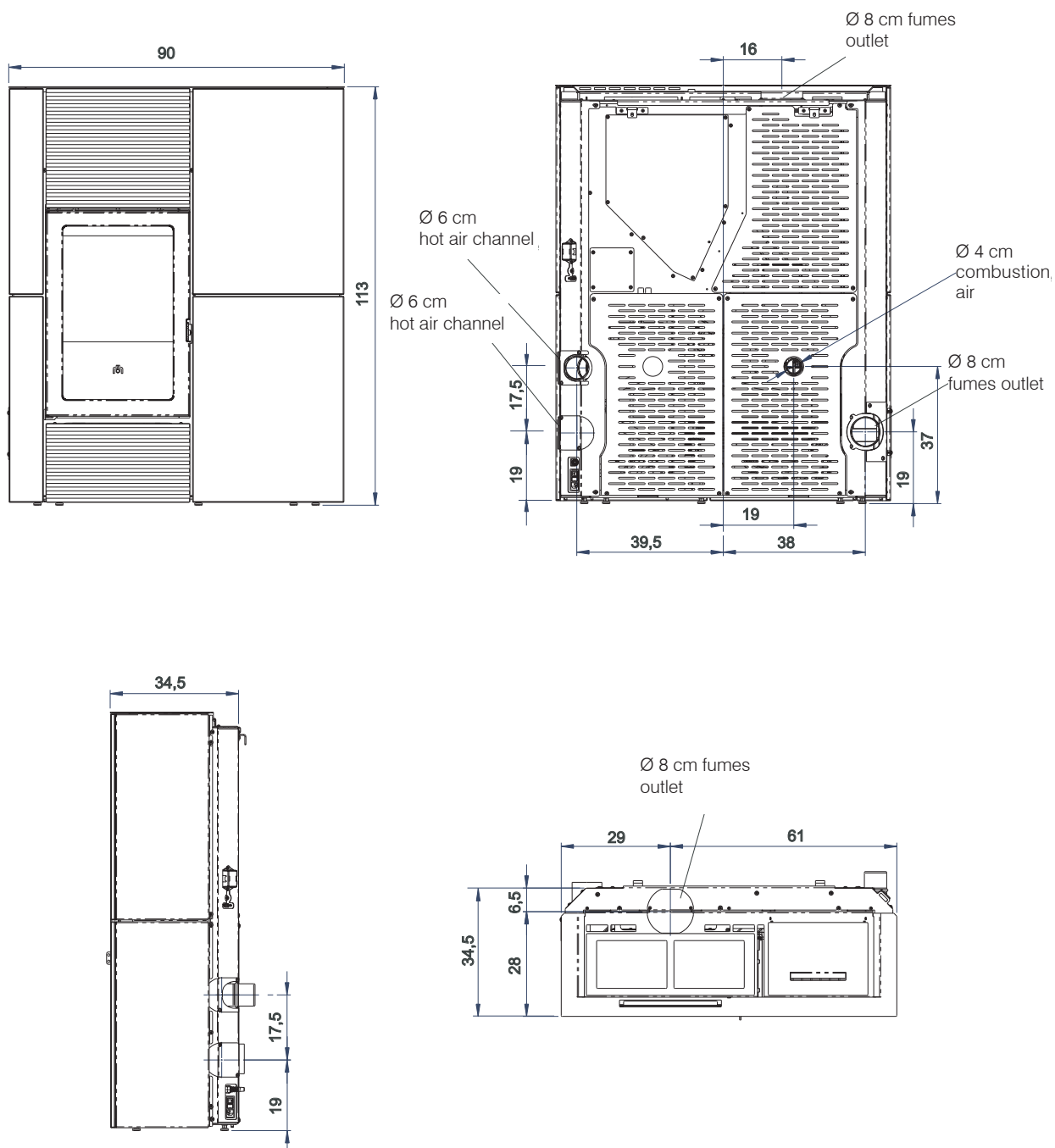

**NOTE:**

- The names of Edilkamin official, authorised technical assistance centres (TAC) and distributors are available ONLY at [www.edilkamin.com](http://www.edilkamin.com).
- Ducting length and vent outlet temperature, depend on the conditions of use and installation. It is therefore suggested to size the ducting system.

**TECHNICAL CHARACTERISTICS in accordance with EN 13229**

Best results are achieved with the clean glass system closed. Use the supplied gasket, by the installer.

	Nominal power	Reduced power	
Available power	12,1	4,3	kW
Efficiency	90,6	93,9	%
CO emissions at 13% O <sub>2</sub>	0,004	0,015	%
Fumes temperature	161	83	°C
Fuel consumption *	2,8	1	kg/h
Tank capacity	22		kg
Draw	12	10,5	Pa
Autonomy	8	22	ore
Heatable volume **	315		m <sup>3</sup>
Fumes outlet diameter (female above)	80		mm
Air intake diameter	40		mm
Hot air duct diameter	60		mm
Weight including packaging (steel - soapstone)	175 - 217		kg
Energy efficiency class according to UE 2015-1186 regulation (Class A+ +/G)	A+		

\*A calorific value of 4.8 kW/Kg has been used to calculate consumption.

\*\* The heatable volume is calculated based on the assumption of a heating demand of 33 Kcal/m<sup>3</sup> hour.

\*\*\* Accessories are available to channel hot air.

The product can be used safely even with a higher depression.

An higher depression can cause decrease in efficiency.

**NOTE: smoke outlet Ø not equal to the chimney system one, to be adjusted accordingly**

**TECHNICAL DATA FOR SIZING THE FLUE** which must in any case satisfy the requirements in this sheet and the installation instructions for the product.

	Nominal power	Reduced power	
Fumes temperature at outlet	193	100	°C
Minimum draw	0,01		Pa
Fumes flow rate	8,6	4,2	g/s

# **ELECTRICAL SPECIFICATIONS**

Power supply	230 Vac +/- 10% 50 Hz
Nominal power absorbed	160 W
Reduced power absorbed	35 W
Power absorbed in stand by	3 W
Power absorption during ignition	300 W
Remote control frequency (provided)	2,4 GHz
Protection	Fusibile 4 AT, 250 Vac 5x20

**EDILKAMIN s.p.a. reserves the right to modify the product without notification in the interests of improvement.**





Edilkamin S.p.A.  
20045 Lainate (MI), via P. Mascagni 7  
Tel. +39 02 937621  
Fax +39 02 93762 400/300  
mail@edilkamin.com  
www.edilkamin.com

Capitale € 4.100.000 int. vers.  
Sede legale:  
20154 Milano, Via P. Moscati 8  
Reg. Imp. di Milano 00192220192  
REA n° 878888  
Cod. Fiscale e Partita IVA 00192220192

**INFORMAZIONI PER APPARECCHI DI RISCALDAMENTO D'AMBIENTE LOCALE A COMBUSTIBILE SOLIDO - REGOLAMENTO (EU) 2015/1185 E 2015/1186**

Produttore **Edilkamin S.p.A.**  
Marchio **Edilkamin**  
Identificativo del modello **Blade2 12 Up**  
Descrizione **Stufa e pellet di legno**  
Funzione di riscaldamento indiretto **no**  
Potenza termica diretta **12,1 kW**  
Norma di riferimento **EN 14785**  
Organismo Notificato **Acteco srl (Via Amman 41, 33084 Cordenons-PN-Italy) NB1880**

Combustibile	Combustibile preferito (unico)	Emissioni dovute al riscaldamento d'ambiente alla potenza nominale				Emissioni dovute al riscaldamento d'ambiente alla potenza termica minima			
		Necessario solo se si applicano i fattori di correzione F(2) o F(3)							
		PM = particolato, OGCs = composti gassosi organici, CO = monossido di carbonio, NOx = ossidi di azoto							
		PM	OGC	CO	NOx	PM	OGC	CO	NOx
		mg/m3 at 13%O2				mg/m3 at 13%O2			
Legno compresso con tenore di umidità ≤ 12 %	si	9	3	45	114	14	13	184	110

Rispettare le specifiche precauzioni per installazione, assemblaggio, uso e manutenzione indicate nel manuale e le regole nazionali e locali vigenti.

$\eta_s$ [%]	87,3
EEI [%]	128
Classe di efficienza energetica	A+

Calcoli in accordo ai regolamenti (EU) 2015/1186 e 2015/1185

Caratteristiche quando l'apparecchio è in funzione unicamente con il combustibile preferito

$$EEI = (\eta_{s,om} \cdot BLF) - 10\% + F(2) + F(3) - F(4) - F(5)$$

BLF = 1,45

$$\eta_{s,om} = \eta_{th, nom}$$

$$\eta_s = \eta_{s,om} - 10\% + F(2) + F(3) - F(4) - F(5)$$

F5 non di pertinenza

Potenza termica			
Voce	Simbolo	Valore	Unità di misura
Potenza termica nominale	$P_{nom}$	<b>12,1</b>	kW
Potenza termica minima indicativa	$P_{min}$	<b>4,3</b>	kW

Efficienza utile (NCV ricevuto)			
Voce	Simbolo	Valore	Unità di misura
Efficienza utile alla potenza termica nominale	$\eta_{th, nom}$	<b>90,6</b>	%
Efficienza utile alla potenza termica minima (indicativa)	$\eta_{th, min}$	<b>93,9</b>	%

Consumo ausiliario di energia elettrica			
Voce	Simbolo	Valore	Unità di misura
Alla potenza termica nominale	$e_{l, max}$	<b>0,160</b>	kW
Alla potenza termica minima	$e_{l, min}$	<b>0,035</b>	kW
In standby	$e_{l, sb}$	<b>0,003</b>	kW

Tipo di potenza termica/controllo della temperatura ambiente	
con controllo elettronico della temperatura ambiente e temporizzatore settimanale	<b>SI</b>

$$F(4) = CC \cdot \frac{0,2 \cdot e_{l, max} + 0,8 \cdot e_{l, min} + 1,3 \cdot e_{l, sb}}{P_{nom}} \cdot 100[\%]$$

F (2) **7,0 %** dal 2022

Altre opzioni di controllo (possibile selezione multipla)	
Controllo della temperatura ambiente con rilevamento di presenza	<b>NO</b>
Controllo della temperatura ambiente con rilevamento di finestre aperte	<b>NO</b>
con opzione di controllo a distanza	<b>SI</b>

F (3) **1,0 %** dal 2022

**Contatti**  
Nome e indirizzo del fabbricante  
EDILKAMIN S.p.A.  
Via Mascagni 7  
20045 Lainate (MI) – ITALY

www.edilkamin.com  
mail@edilkamin.com  
**Direttore Generale**  
**Paolo Gusella**

**PREPARATION AND UNPACKING**

The packaging materials are neither toxic nor noxious and do not require special disposal.

The user is responsible for storing, disposing or and recycling them in a regulatory fashion.

Edilkamin offers Blade in three versions:

SOAPSTONE BLADE Up

STEEL BLADE Up

Inside the product you will find: the remote control, warranty certificate, this manual, desiccating salts, power cable, two wall-mounting brackets and two cable glands for mounting optional sensors to the back of the product.

The lever for opening the door is also on the pallet.



Always move the stove vertically with suitable equipment and in observance of safety regulations.

Take care not to tip the product over

Package materials such as plastic and films may be dangerous for children. Suffocation hazard. Keep packages away from children.

**TO REMOVE THE PALLET (ALL MODELS)**

The stove is secured to the pallet with four brackets: two at the front and two at the back.

Undo the two screws on each bracket

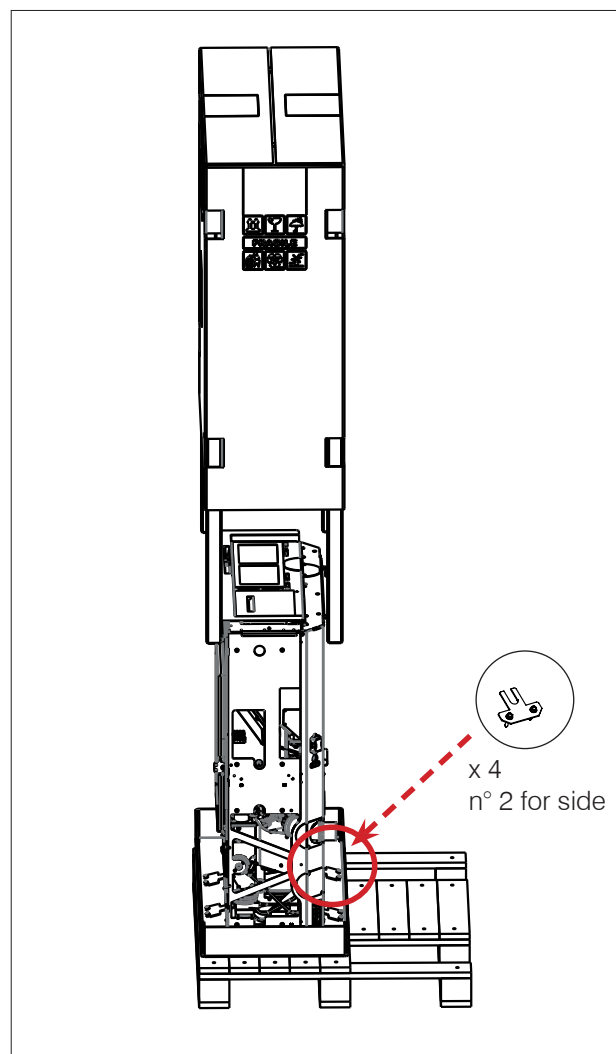

**POSSIBLE CONFIGURATIONS:**

**FUMES DISCHARGE (Ø 8 cm) AND AIR DUCT (Ø 6 cm)**

**STEEL BLADE AND OILSTONE:**

**POSSIBLE FUMES DISCHARGE POSITIONS**

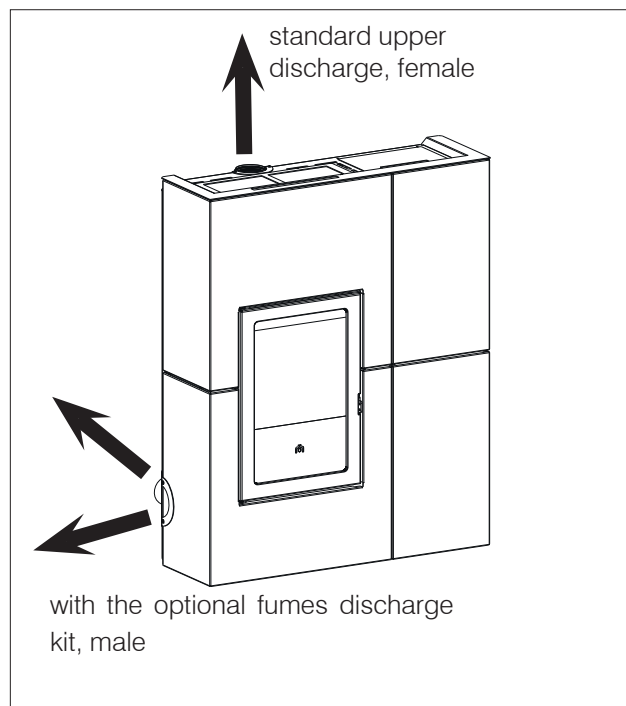

**STEEL BLADE AND OILSTONE:**

**POSSIBLE AIR DUCT POSITIONS.**

Unducted air exits the stove from the top \*

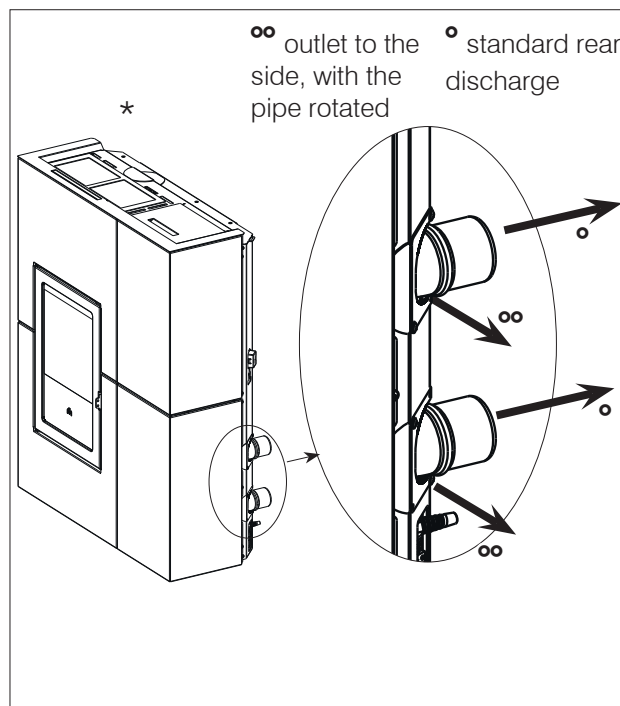

### WALL MOUNTING

Mount the stove to the wall with the provided plates (a) and the brackets (b) already installed onto the product, or use an alternative mounting which ensures that the product is stable and secure. Fix the plates to the wall with rawl plugs.

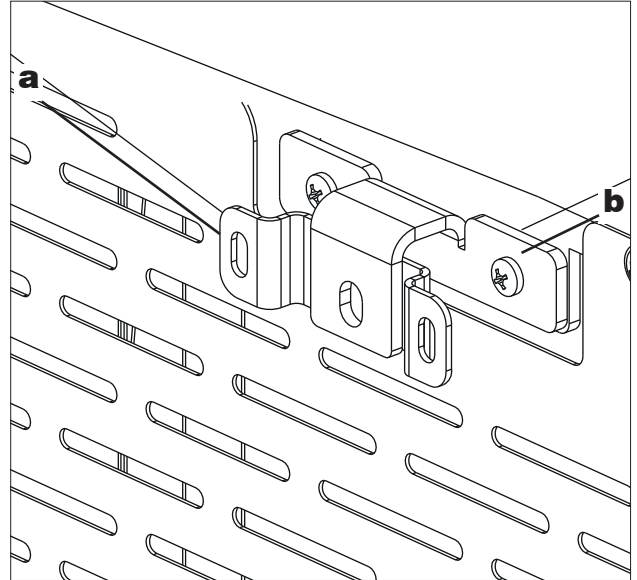

## CHANGING THE DIRECTION OF THE HOT AIR DUCT

To change the direction of the ducting from rear to side (summary of operations shown in figures):

1. remove the rear cover plate (1) (two bolts)

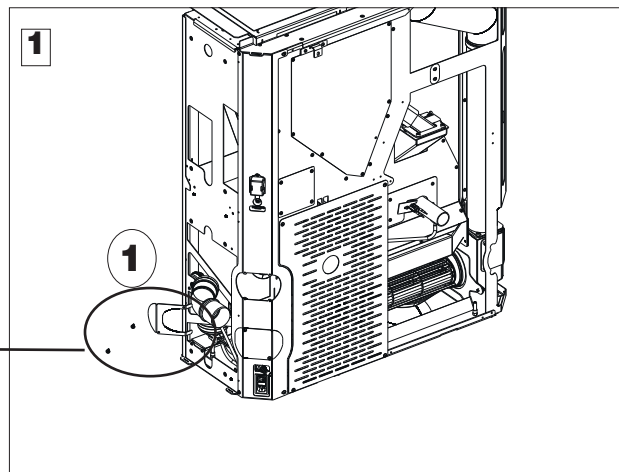
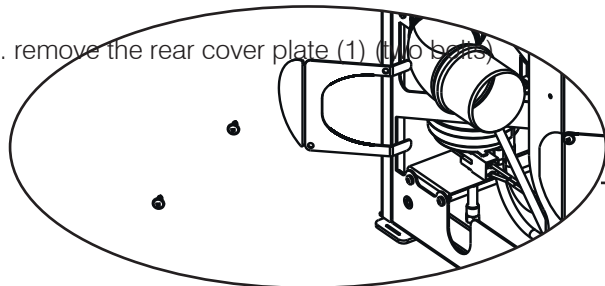

2. remove and re-fit the white bend (2) (dia. 6 cm towards the side (it locates into place))

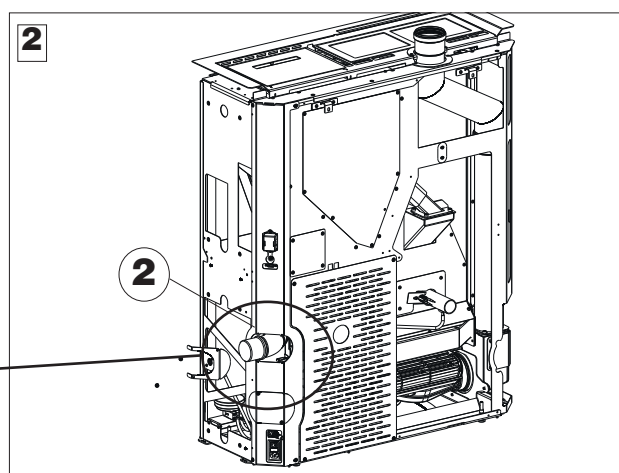
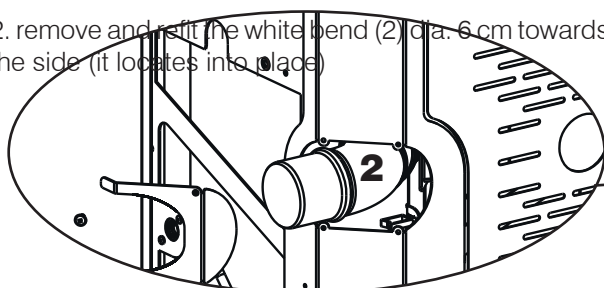

3. reposition the plate in the correct orientation.

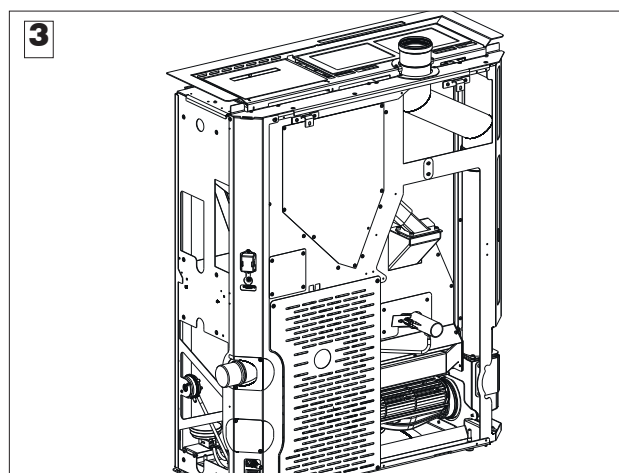

# STEEL CLADDING

EDILKAMIN

Description	Reference in the figures below	Quantity
Top left-hand side	(1)	n°1
Top left-hand side panel with pre-cutting for side fume discharge	(2)	n°1
Upper right side	(3)	n°1
Lower right side	(4)	n°1
Upper central profile	(5)	n°1
Lower central profile	(6)	n°1
Left outline	(7)	n°1
Left front outline	(8)	n°1
Right depth	(9)	n°1
Side smoke outlet rosette	(10)	n°1
<b>Small hardware</b>		
Countersunk hex screw M5x16	(a)	n°15
Self-tapping screw 4,2x9,5	(c)	n°9

“Right” and “left” refer to the product when viewed from the front.

The above-mentioned elements, once they have been mounted, will be positioned (“exploded”) as shown in the figure below. The mounting operations are described in the figures appearing on the following pages.

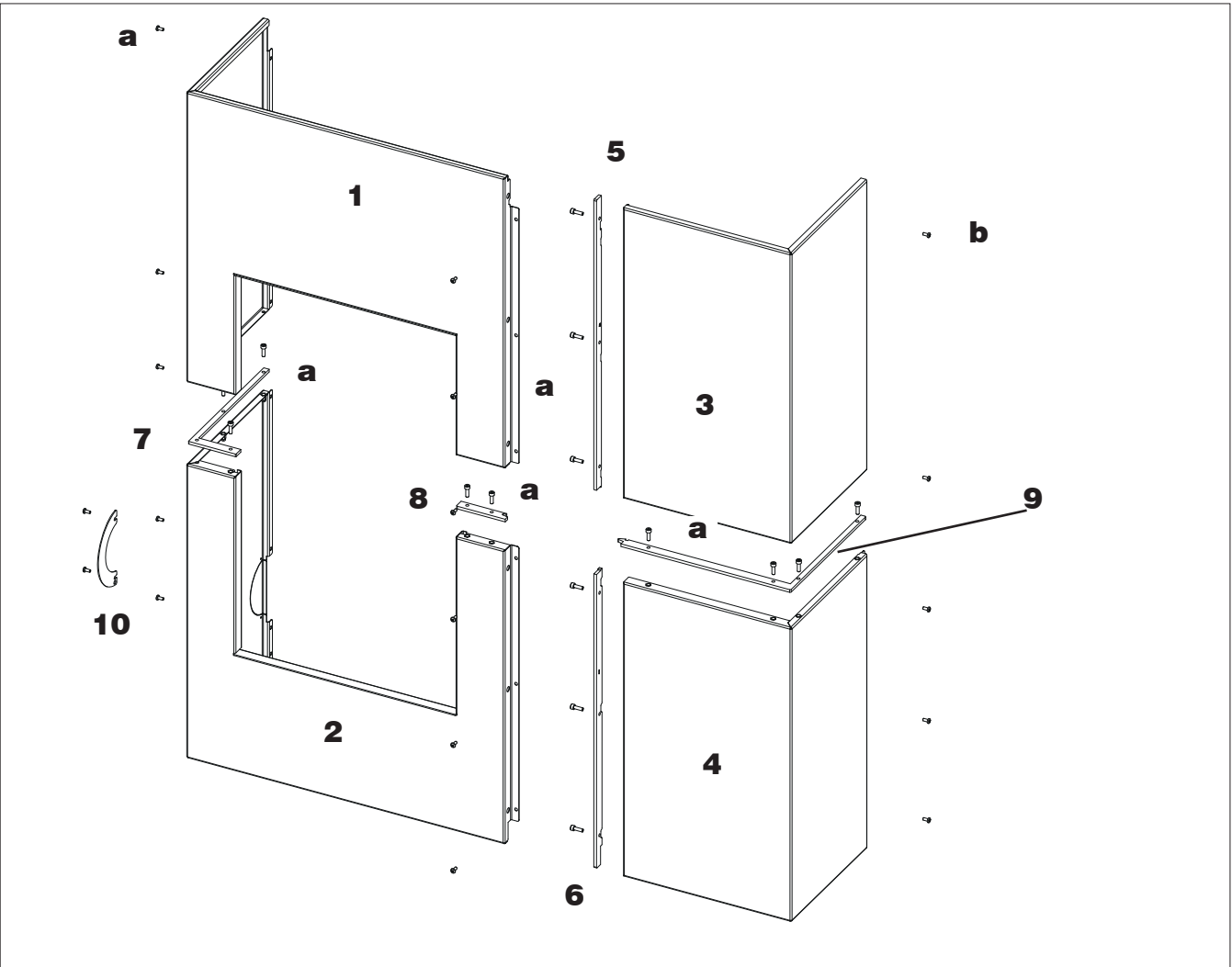

INSTALLER

**Levelling feet**

The product is equipped with feet that can be adjusted with a screwdriver from inside the product BEFORE mounting the claddings, or by slightly raising the product.



BEFORE INSTALLING THE CLADDING, SECURE THE PRODUCT TO THE WALL WITH THE BRACKETS PROVIDED TO MAKE SURE IT DOES NOT TIP OVER.

**Left side fitting (1 and 2)**

Screw lower left side, left outline, left front outline, inserting then the upper left side (screws are used to fix the top side panel) for a complete left side assembly.

Use screws (a) and inner hexagonal screw M5x16.

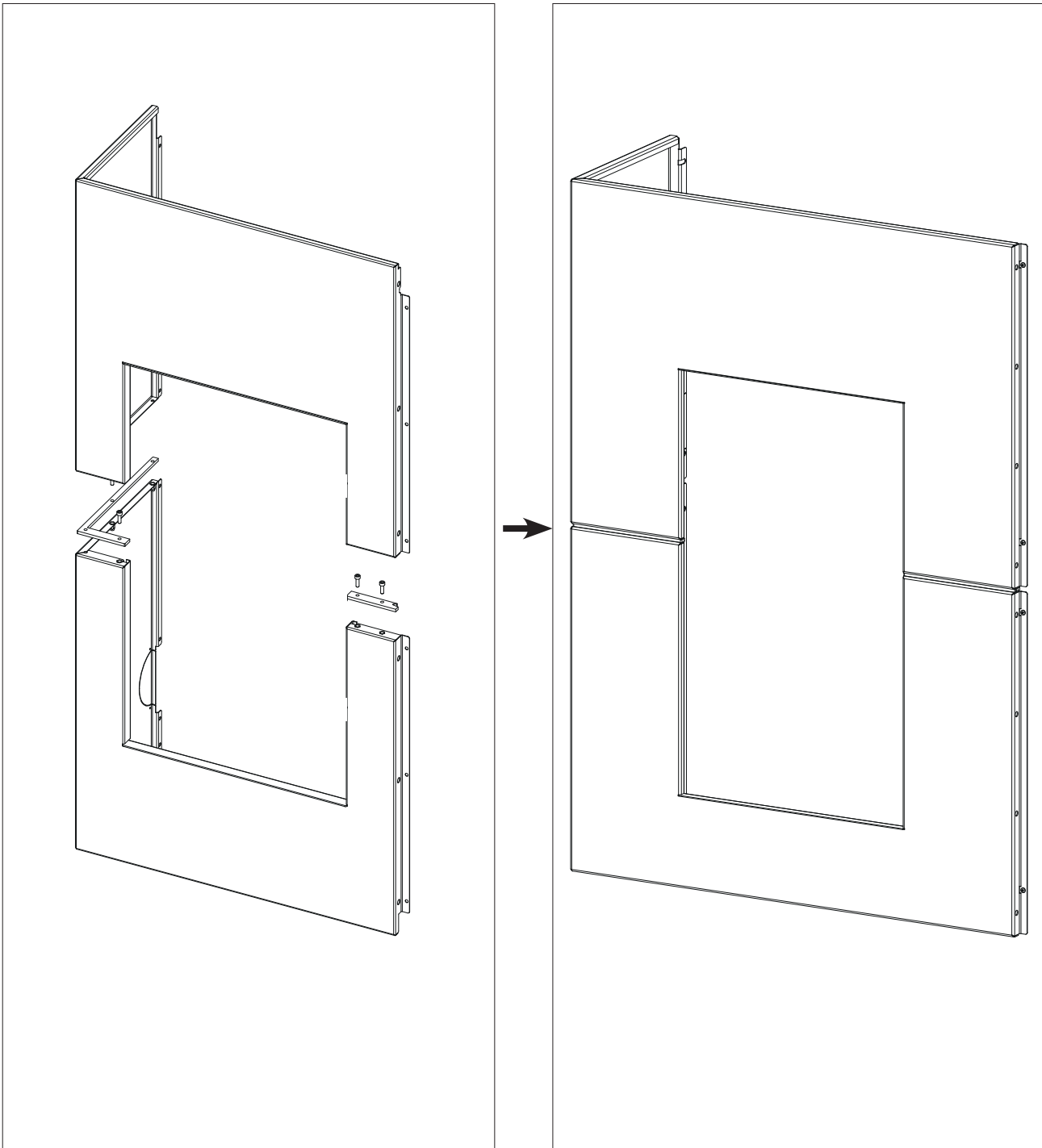

Remove the just laid down top before mounting to ease job if necessary.

Drawings are just a guideline, useful for installing, but not always related to the specific model.

### Fitting of the bottom-left side panel

Tight then 3 screws on the left side and 4 screws on the front of the structure.

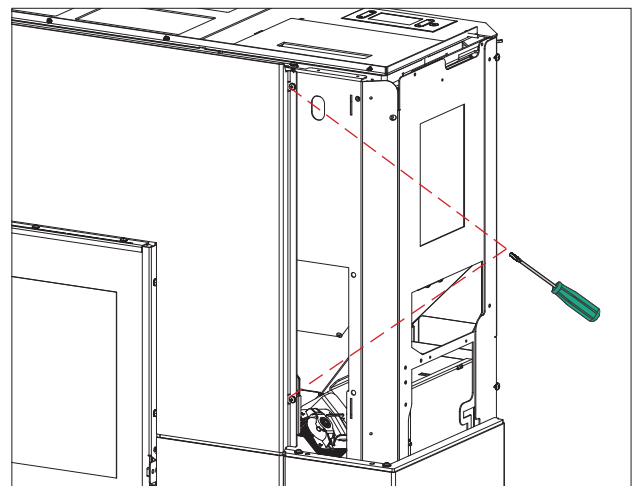
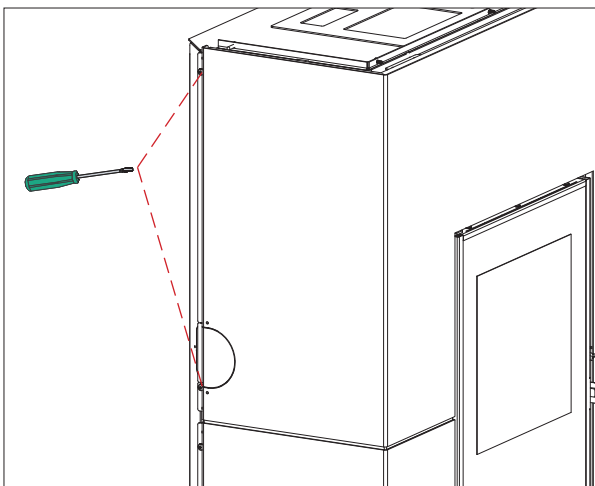



**Assembling the right-hand side panel (3 and 4)**

Screw on the top right-hand side panel, the external right-hand profile and the right-hand front profile. Slot the top right-hand side panel. Screw on the central spacers until obtaining the complete right-hand side panel.

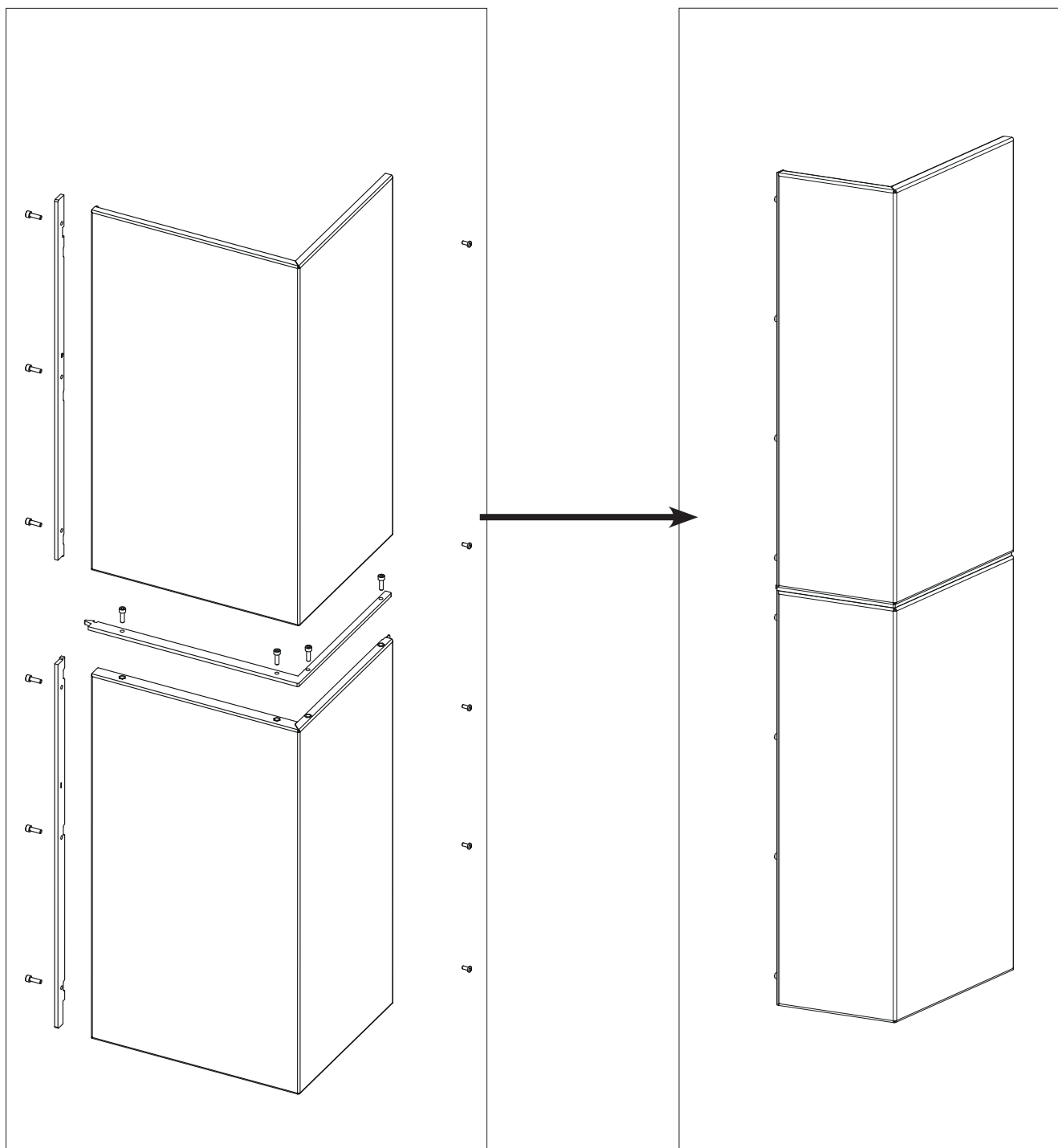

Insert the assembled right-hand side panel.

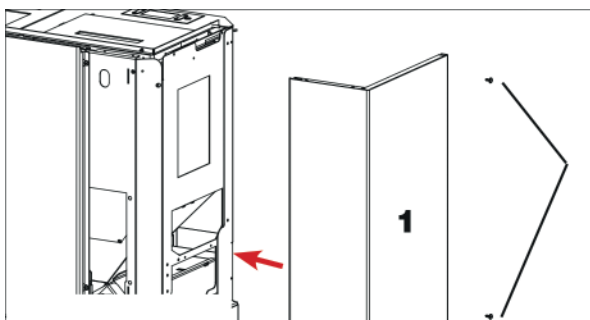

Fasten it to the top and right-hand sides with a screw.

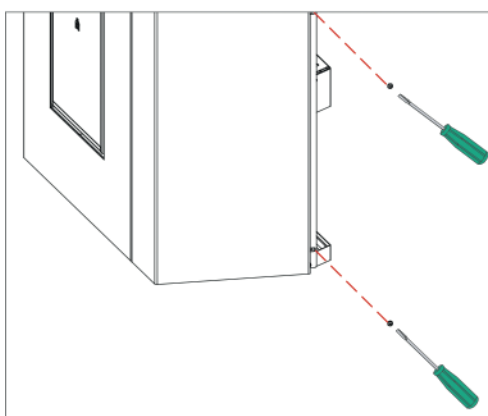
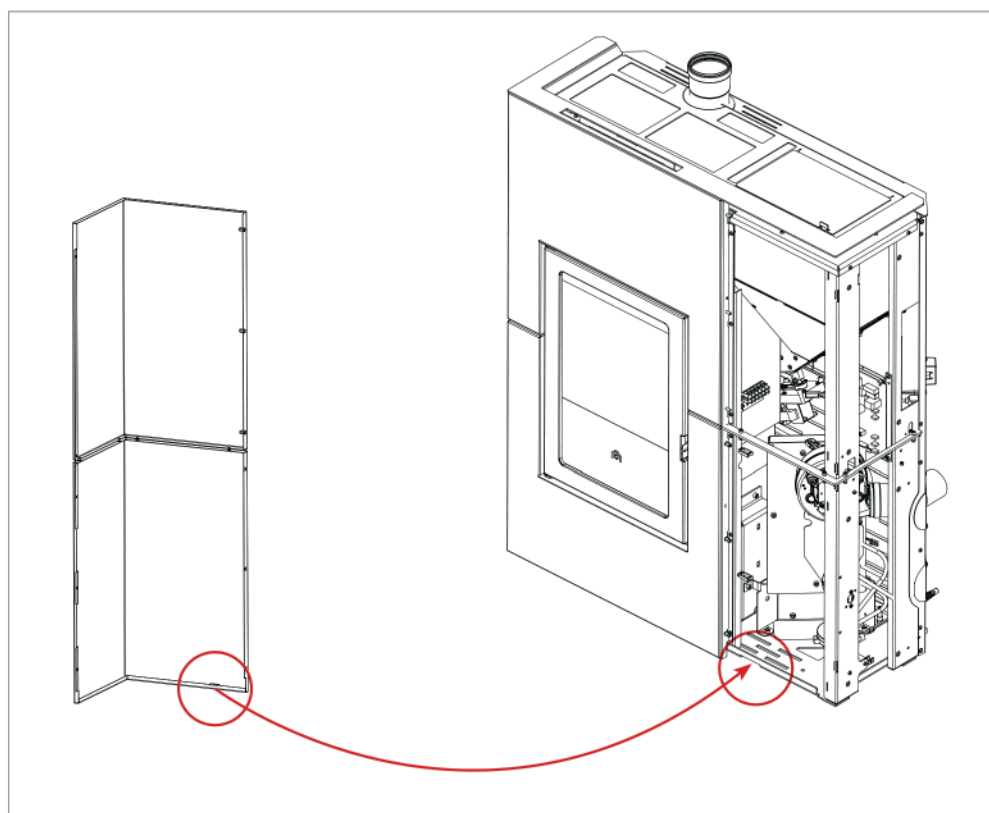

### CONTENTS OF CLADDING BOX (STONE BLADE)

- 6 stone elements: (1, 2, 3, 4, 5, 6) with applied metal frame. The elements are not interchangeable (with the exclusion of 1 with 2 / 3 with 4).
- 4 metal side elements (7, 8, 9, 10), not interchangeable
- 1 upwards air deflector (11)
- 1 rose for the side fumes discharge
- 1 bag of fasteners
- 4 washers (in case to adjust the top).

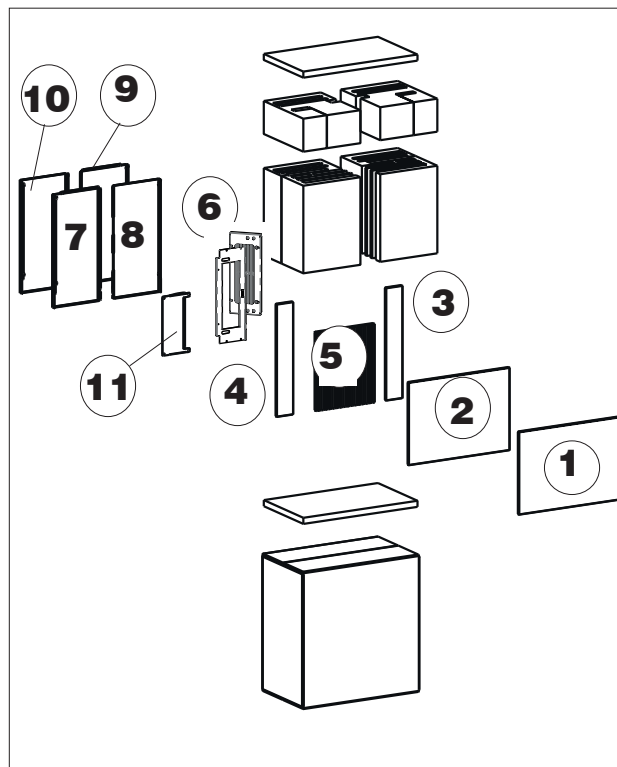

**Remove the just laid down top before mounting to ease job if necessary.**

The assembly operations are described in the diagrams on the following pages, for the achieving the component positions shown in the diagram to the side.



#### Levelling feet

The product has 5 feet which can be adjusted with a screwdriver from inside the appliance BEFORE the cladding is fitted.



BEFORE INSTALLING THE STONES, SECURE IT TO THE WALL WITH THE PROVIDED BRACKETS TO MAKE SURE IT DOES NOT TIP OVER

# COATING FITTING SEQUENCE

Remove product outline, replacing it with the new one as illustrated below .

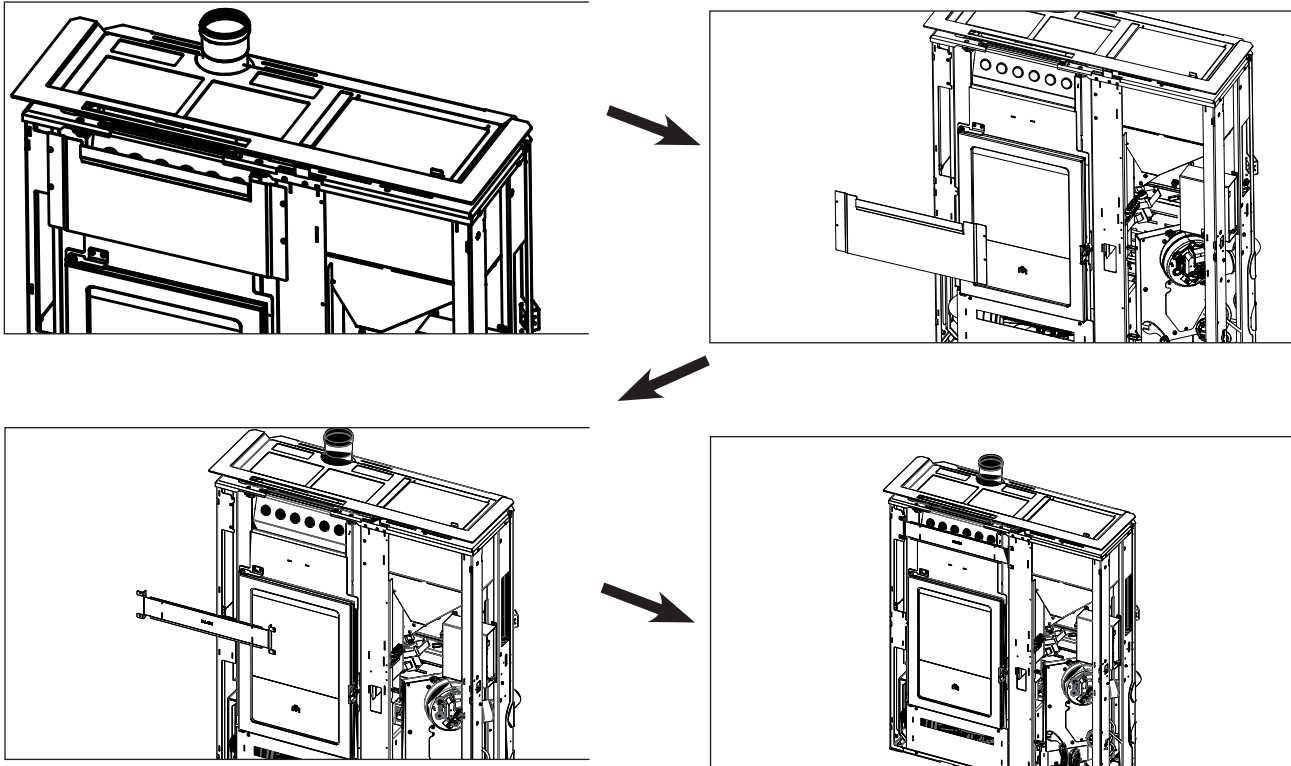

Position the four metal side elements (7, 8, 9, 10) from the bottom.  
Each element snaps into place and then bolts on

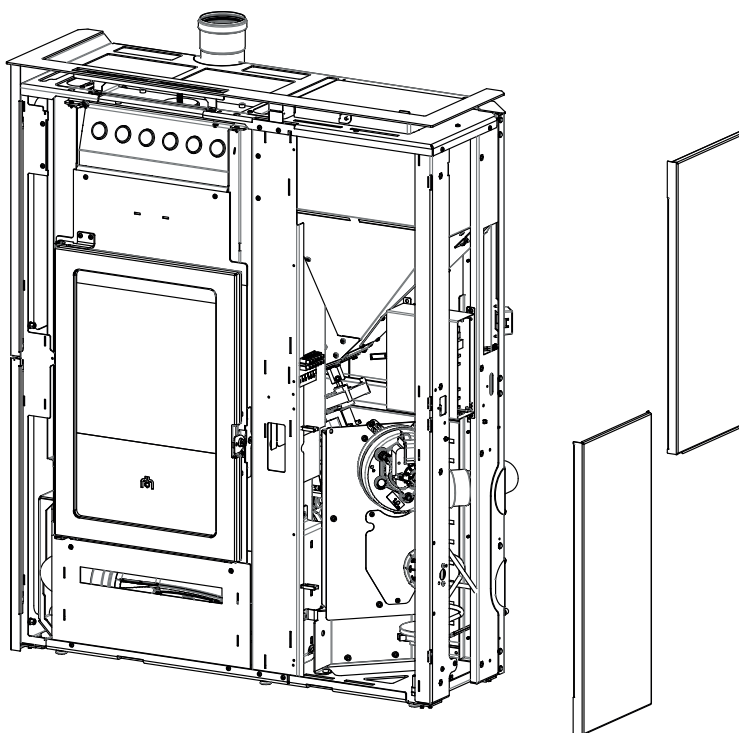

Locate the six stone components (see figure below). They are not adjustable.

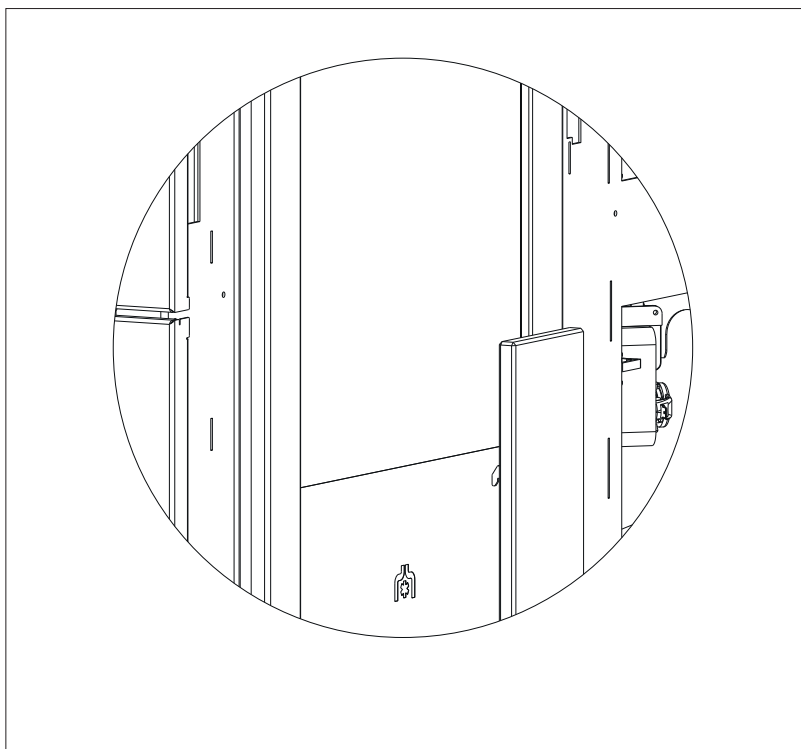

## REMARKS ON INSTALLATION

Note that:

- The appliance may only be installed by a qualified technician authorised to issue the declaration of conformity.
- The appliance must be installed and operated in compliance with local and national law and European regulations. The applicable Italian regulation is UNI 10683.
- If installed in a condominium, the appliance must be approved by the administrator.

We give some general instructions below, however these do not obviate the need to comply with local regulations and do not affect the installer's liability for the installation.

## Checking the suitability of the installation space

- The room must have a volume of at least 20 m<sup>3</sup>
- The floor must be able to bear the weight of the product and its accessories.
- Level the appliance
- The appliance may not be installed in a bedroom, bathroom or in the same room as other equipment which draws air for combustion from the room itself, or in any area with an explosive atmosphere. Any extraction fans operating in the same room or area as the product, may affect its draw.
- In Italy, check the compatibility pursuant to UNI 10683 and UNI 7129 in the presence of gas fired products.

## Levelling feet

The product has 6 feet (3 at the front and 3 at the back) which can be adjusted with a screwdriver from inside the appliance BEFORE the cladding is fitted.

## Protection from heat and safety clearances

The surfaces of the building adjacent to the product must be protected against overheating.

The insulation to be used will depend on the type of surface in question.

The product must be installed in observance of the following safety instructions:

- minimum clearance at the sides and back of 10 cm from flammable materials.

If the material is not flammable, the minimum clearance is provided by the wall-mounting brackets (pre-installed).

- no flammable materials may be kept closer to the front of the appliance than 80 cm.

If connected to a wooden or otherwise flammable wall, the flue must be insulated appropriately.

If installed on a flammable or combustible floor, or which is not capable of bearing its load, use steel or glass plates under the stove to distribute the load. Contact the retailer for such optional equipment.

## Positioning the product

The product is designed to operate in all climatic conditions. In special circumstances, such as strong wind, its safety equipment may switch the stove off. Contact the authorised Edilkamin Technical Assistance Centre.



## NOTE

The flue outlet Ø is not that of the chimney system, which must be sized in accordance with national and local standards and in particular, but not limited to, EN 13384, EN 1443, EN 1856, EN 1457.

## FLUE SYSTEM

### (Fumes duct, flue and chimney pot)

This chapter has been drawn up pursuant to European regulations EN 13384, EN 1443, EN 1856 and EN 1457. The installer must observe both these and any other local regulations. This manual does not in any way substitute such regulations.

The product must be connected to a flue system which ensures that the fumes produced by combustion are exhausted in complete safety.

Before positioning the product, the installer must check that the flue pipe is properly rated.

## FUMES DUCT, FLUE

The fumes duct (which connects the hearth's fumes outlet with the flue) and the flue itself must, among other regulatory requirements:

- receive the fumes from a single product (the outlets of multiple appliances may not be conveyed into a single flue)
- be routed vertically for the most part
- have no downwards sloping sections
- preferably have a circular internal cross section, or with a ratio of the sides of less than 1.5
- terminate at roof level with a proper chimney pot: the flue may not discharge directly from the wall or into an enclosed space, even if the space in question is open to the sky
- be made of material rated fire reaction class A1 per UNI EN 13501 or analogous national regulations.

- be certified, with a chimney plate if metal
- be of uniform cross section or vary in cross section only immediately after the outlet, not at some mid point of its length

## THE FUMES DUCT

Further to the general prescriptions for the fumes duct and flue, the fumes duct:

- may not be made of flexible metal material
- must be insulated, if routed through unheated areas or outdoors
- must not be routed through rooms in which the installation of combustion heat generators is prohibited, or subject to fire hazard, or which cannot be inspected.
- must enable the recovery of soot and be open for inspection
- must have at most 3 bends, through an angle of no more than 90°
- must have a single horizontal section of length no more than 3 metri, depending on the draw. Note in any case that long sections promote the accumulation of dirt and are harder to keep clean.



Avoid infiltration of condensate water through the flue. If necessary, mount an anti-condensate ring – ask your chimney sweeper for details.

Damage caused by condensate water is not covered by the warranty.



\*

In some nations, installations with multiple flues are permitted under certain conditions. Depending on regional regulations, additional safety systems are necessary in case of connection to multiple flues. Your chimney sweeper/technician will be able to provide further details.

### THE FLUE:

Further to the general prescriptions for the fumes duct and flue, the flue:

- must serve solely to exhaust fumes
- must be correctly sized to satisfy the requirements of fumes exhaust (EN 13384-1)
- should preferably be insulated, in steel with a circular internal section. If rectangular, the corners must have a radius of not less than 20 mm, with a ratio of the internal dimensions of  $<1.5$
- must normally be at least 1.5 metres in vertical length
- must have a constant cross section
- must be waterproof and thermally insulated to ensure a good draw
- must preferably have a collection chamber for
- If pre-existing, must be clean, to prevent the fire hazard.
- in general, we recommend fitting a tube inside the existing masonry chimney if its diameter is greater than 150 mm.

### INTUBATED SYSTEM:

Further to the general prescriptions for the fumes duct and flue, the intubated system:

- must operate in negative pressure;
- must be open to inspection
- must observe local regulations.

### THE CHIMNEY POT

- must be windproof
- must have an internal cross section equivalent to that of the flue and a fumes outlet at least double that of the interior of the flue
- for dual flues (which should be spaced at least 2 m apart) the chimney pot receiving the fumes from the solid fuel appliance or that from the higher storey, must be at least 50 cm higher than the other
- it must extend beyond the back flow zone (in Italy, refer to UNI 10683 point 6.5.8.)
- it must allow for maintenance of the chimney

### EXTERNAL AIR INTAKE

In general, we suggest two ways for ensuring a proper flow of combustion air.

#### Indirect air intake

Install an intake at floor level with effective area (net of the mesh or other protective equipment) of at least 80 cm<sup>2</sup> (10 cm dia.).

To prevent draughts, we recommend installing the intake behind the stove or behind a radiator.

Installing it in front of the appliance will create unpleasant draughts.

#### Direct air intake

Install an air intake of effective area (net of the mesh or other protective equipment) at least equal to that of the air intake at the back of the product.

Connect the air intake to the appliance's air intake with a tube (which may also be flexible).

We recommend not exceeding a 5 m length and curving the tube at most 3 times, depending on the draw of the flue.

The air may be drawn from an adjacent room only if:

- the flow is taken from permanent and unobstructed openings communicating with the outdoors;
- the adjacent room is never in underpressure relative to the outdoors;
- the adjacent room is not a garage, subject to fire hazard, a bathroom or bedroom
- the adjacent room is not a shared room in the condominium.



## CHECKING THE ELECTRICAL CONNECTIONS (the power socket must be located in an easy-to-access position)

The stove is equipped with an electrical power cord or connection to a 230V 50 Hz socket, preferably with an electromagnetic switch.

Variations in voltage of more than 10% can compromise the operation of the stove.

The electrical system must be compliant; check the operation of the earth in particular.

Edilkamin is not responsible for malfunctions resulting from an improperly earthed system.

The power line must be of adequate section for the power of the appliance.

The power cable must not come into contact with the flue pipes or other hot parts of the stove.

Power up the stove by shifting its switch from 0 to 1.

There is a 4 A fuse on the socket with switch located at the rear of the stove.

In certain countries specific regulations apply: it is the installer's duty to ensure that the local regulations have been observed.

The technician who sizes the system must assess the relevant situation.

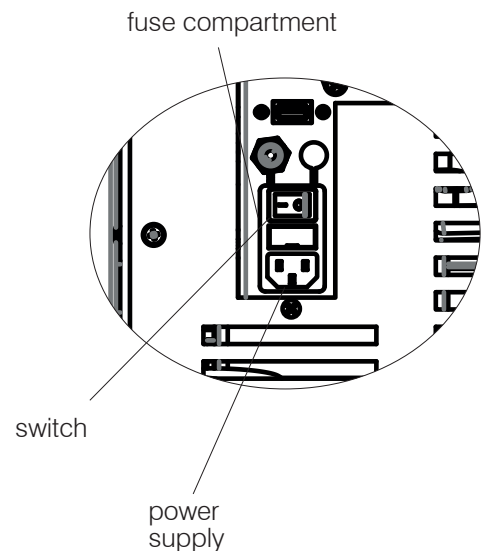

## HOOKING UP OPTIONAL COMPONENTS

There is a terminal board on the product (visible after removing the right-hand side panel) to which the installer may connect a home-automation probe or an O.T.A. room probe for ducted versions. The number of probes that can be connected is equal to the number of ductable fans.

1-2	3-4	5-6
3 ducting room probe	2 ducting room probe	AUX

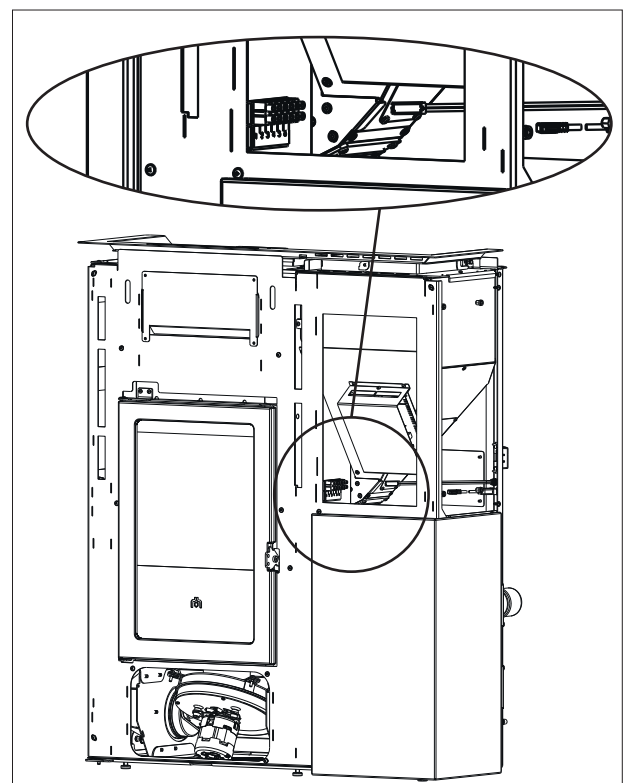

### FIRST IGNITION PROCEDURE

- Make sure you have read and understood this manual
- Remove all flammable materials from the appliance (manuals, labels, etc). Make sure to remove the labels on the glass.

There may be a slight smell of paint the first few times it is ignited, however, this will disappear quickly.

### LOADING THE PELLETS INTO THE PELLET TANK

To access the tank, open the lid \*



**1) When doing so, DO NOT rest the bag of pellets on the top grille, since the plastic bag may melt and damage the appliance's paint.**

**2) Use the gloves when loading the stove while it is operating and hence hot to the touch.**

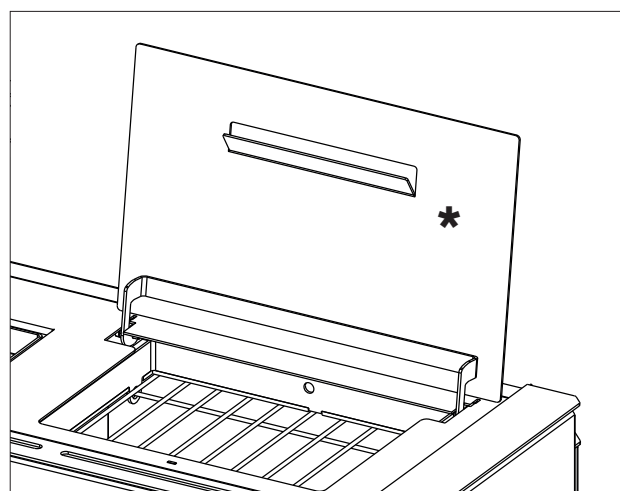

Use UNI EN ISO 17225-2 category A1 wood pellets or similar regulatory products with the following characteristics.

diameter 6 mm;

length 3-4 cm

humidity <10 %

For reasons of safety and environmental compatibility, DO NOT burn plastic, painted wood, coal, bark or other such materials in the stove.

Do not use the stove as an incinerator



#### Caution

Using fuels other than those specified can damage the appliance

## OPERATION

Mode	Settable parameters
MANUAL	<ul style="list-style-type: none"> <li>power level</li> <li>ventilation level (if there are two or more fans, they can be adjusted separately)*</li> </ul>
AUTOMATIC	<ul style="list-style-type: none"> <li>desired room temperature</li> <li>ventilation level *</li> </ul>
CRONO	<ul style="list-style-type: none"> <li>desired room temperature, selected per day of the week</li> <li>ventilation level*</li> </ul>

\* by lowering ventilation, the product can also automatically modulate the power to maintain maximum performance and avoid overheating. Where necessary, a safety function is provided: if for reasons of use or installation the set ventilation does not allow the necessary heat dissipation, the maximum ventilation is automatically started.

The product also has the following supplementary functions.

Function	Modes in which it can be activated	What it does
Stand-By	automatic crono	when the desired temperature is reached, the product switches off and then back on again when the temperature drops
RELAX (not provided for some types of products)	manual automatic crono	enables natural convection mode (fan off), thus reducing the power
EASY TIMER	manual automatic	can be used to programme the switching off/on after a set number of hours (maximum 12 hours)



## INTERFACE

The product can be managed alternatively as follows

### STANDARD

- **Bluetooth REMOTE CONTROL:** can be used for all functions, near the product
- **The Mind APP**  : useful for all functions at home with direct connection or outside the home with internet connection and registration

By purchasing the Edilkamin **optional elements:**

- **VOICE CONTROL SYSTEMS:** Alexa or Google Home

If necessary, a few functions can also be managed from a

- **SAVE PANEL:** placed on the product

## REMOTE CONTROL

The remote control has specific functions for three distinct figures:

- **USER** of the product (operations not protected by password)
- **INSTALLER** (operations with dedicated password because any errors can jeopardise the product's operations and SECURITY)
- **EDILKAMIN TECHNICAL ASSISTANCE CENTRE (TAC)** (operations with dedicated password because any errors can jeopardise the product's operation and SECURITY).

## Characteristics:

Module for RF transmission and reception with 2.4 GHz frequency - Recommended power supply 3 x AA slimline 1.5 VDC batteries (with at least 1600 mAh capacity).



Risk of explosion if the batteries are replaced with other unsuitable batteries.

## REMOTE CONTROL POWER SAVING

After 20" of non-use the backlighting decreases and after a further 10" the display switches off. If any button is pressed with the display on, the counter resets. If any button is pressed while the display is off, the display and the backlighting will switch on and the counter will reset.

This only refers to the remote control, not the product itself.

In normal use, the remote control's batteries should last a year. This duration is for illustrative purposes only. Edilkamin and the reseller will not consider claims for battery life under any circumstances.

**If on the initial start-up** the language was not set, the screen for setting the language will appear. Choose the language with the +/- buttons and confirm with OK.



Current room  
temperature

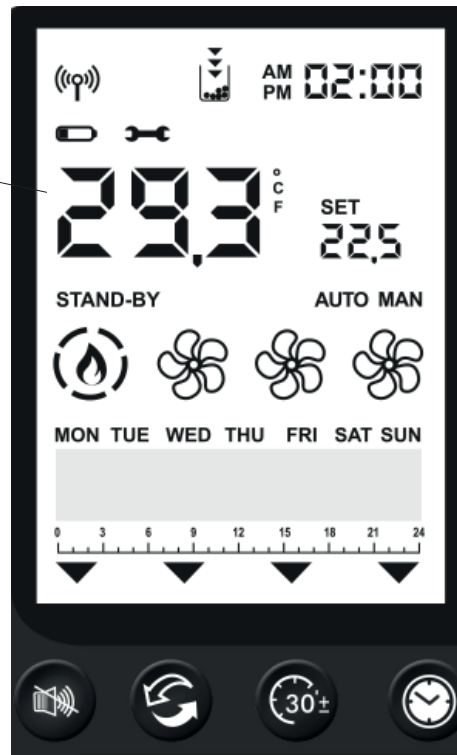

Target room  
temperature



Bluetooth communication present between the product and the PCB. If there is no communication, the symbol disappears.



On only if the battery is running out.



Maintenance necessary symbol.

Appears after a certain number of hours of operation. In some models the symbol may be linked to a fuse problem on the board. In any case, contact the TAC.



The relative function is active (Relax – airKare – EasyTimer – Crono).

**EasyTimer and Crono cannot be activated simultaneously.**



Reserve indicator. It switches on if the function is active. The arrows switch on in sequence to signal that the tank must be filled.



Presence of flame and stove power

POWER ON

POWER LEVEL 1

POWER LEVEL 2

POWER LEVEL 3

POWER LEVEL 4

POWER LEVEL 5





Visualisation of the status of the fan(s).

If the product has not heated up, no symbol will appear.

FAN OFF:	
SPEED 1	
SPEED 2	
SPEED 3	
SPEED 4	
SPEED 5	
AUTOMATIC	

#### STAND-BY

Indicates that the product has switched off after the target has been reached with stand-by mode active. DOES NOT indicate that the function is enabled.

#### AUTO MAN

Automatic or Manual mode: the product's air power depends on the room temperature or is set by the user.

#### SET

Setting. Indicates that the remote control is in the setting mode.  
The settable value will appear in the bottom bar.



Digits for SET-POINTS. Setting of the various SET-POINTS: temperature, power, fan speed.

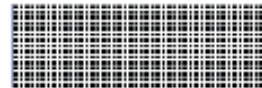

Bottom bar for  
"Weekly Hour Schedule" and "Messages".

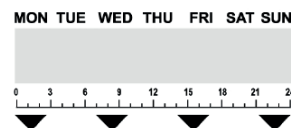

Days of the week and time bar.  
They only appear if the timer (Crono) has been activated.

**POWER ON/POWER OFF**

These operations will take a few minutes, during which the flame must appear or extinguish. Simply wait without taking any action.

The ON/OFF button is used to manually start the on or off phase.

**During the switch-on,**

the display will show the status (CLEANING; SWITCH-ON; etc.)

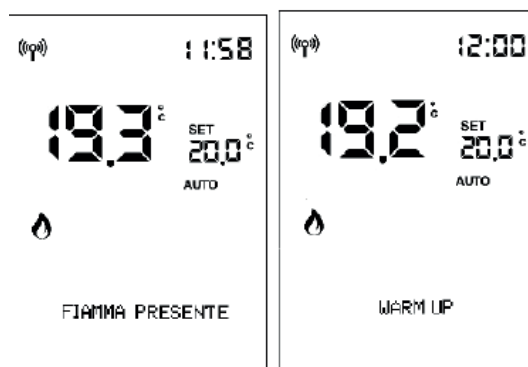
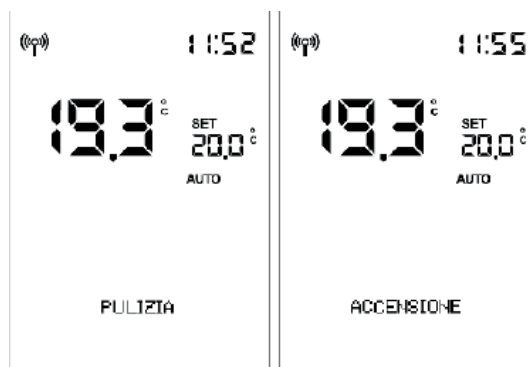
**During switch-off,**

the display shows the message "SHUTDOWN".

**If time programming is active,**

the status and programming are displayed alternately (3 seconds) on the status bar:

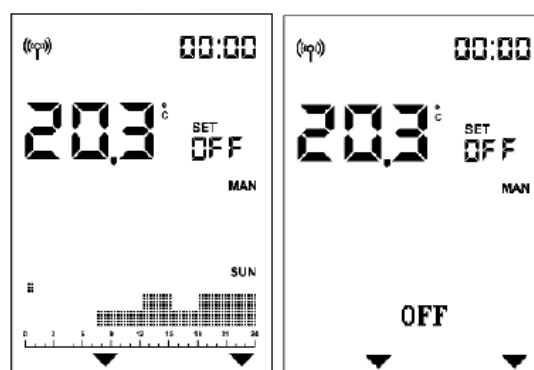



### AUTOMATIC and MANUAL setting

Press the AUTO/MAN button to switch from manual to automatic mode or conversely.

#### AUTOMATIC



#### MANUAL

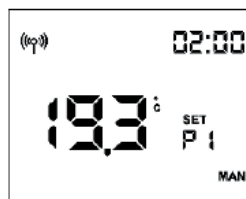

### In AUTOMATIC mode:

**Setting the room temperature** (read by the remote control, which should be in the room where the product is installed).

Example: press a button and activate the display, then press the  button

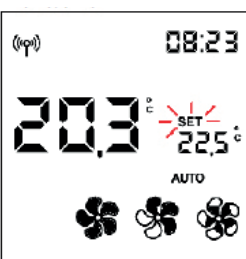
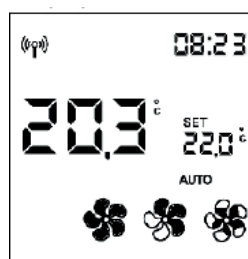

### In MANUAL mode:

#### Setting of the power

Modify the power level (displayed by the flame symbol) using the “+” and “-” buttons.

For example: press any button and the display will activate, then press the  button

“flame”  
symbol

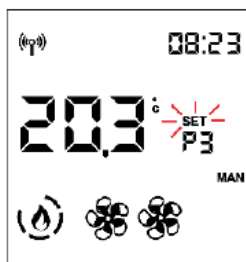
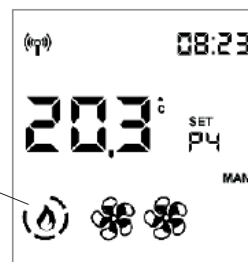



The setting can be confirmed with the  button or by waiting 5” without pressing any button. After confirming, SET will stop flashing.



### NOTE:

**With the timer active and the product switched off**, neither the temperature nor the power can be adjusted.

## - FAN ADJUSTMENT

The setting can be made with the stove turned OFF or ON.  
If the backlight is switched off, it can be activated by pressing any button.

Then by pressing the button  or  SET flashes and instead of the environment Set, the indication of the number of the fan being edited appears (F1).

The fan speed can be increased or decreased with  or  in the following sequence:

1 -2 - 3 - 4 - 5 - AUTO - for the front fan (1)

OFF-1-2-3-4-5- AUTO for ducted fans (2 and 3)

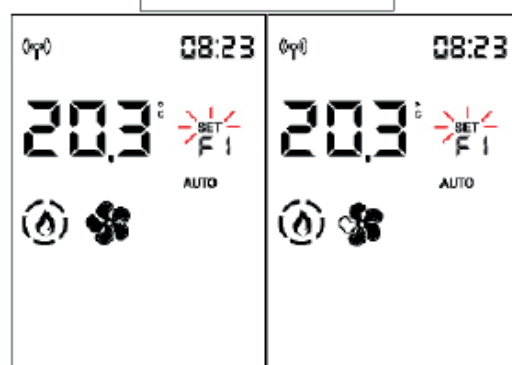

with button 

with button 

You can confirm the setting with the  button and then move to the next fan, if present (only for PLUS ducted versions), otherwise you can exit the fan setting page and "SET" will stop flashing.

Wait 5" without pressing any button to exit the fan setting, and SET will stop flashing.

Pressing the  button to confirm will take you to the next fan (Fan 2), if present.



Pressing the  or  button modifies the fan speed.

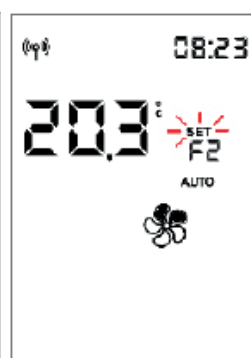

You can confirm the setting with the  button and then move to the next fan, if present, otherwise you can exit the fan setting page and "SET" will stop flashing. Alternatively, wait 5" without pressing any button to exit the fan setting, and "SET" will stop flashing, even if there are other fans.

Pressing the  button to confirm will take you to the next fan (Fan 3), if present. Waiting 5" without pressing any button takes you back to the home page with the modified SET.



## WITH OPTIONAL ROOM PROBE

### DUCTED ZONES 2 AND 3 ROOM SET-POINT

The setting can only be made with ducted-air stoves. If two or more optional room probes are connected and activated, it is possible to set the relative room set-point and display the room temperature.

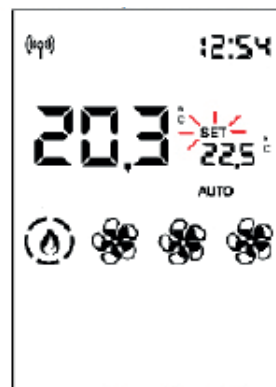

After setting the installation room temperature (or with the room power in manual mode), wait 5" without pressing any button and "SET" will flash then you will exit the settings page.

Otherwise, if you confirm with the  button, you can set the room set-point for zone 2 (if the probe is present and active) indicated on the bottom bar.

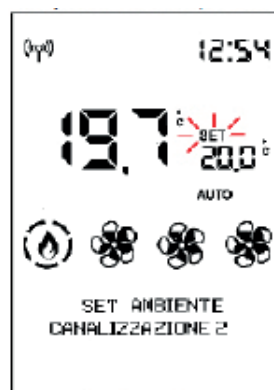

Press OK to move to the next zone (zone 3), if present, or exit.

## - RELAX FUNCTION

Natural convection function (without ventilation) with automatic power limiting.

This function is available in all modes: automatic, manual and crono.

Press the  button to activate the Relax function.

Its activation on the display will be signalled by the arrow relative to the Relax button

Again by prolonged pressing of the  button, the function is disabled.

The product reduces its power output and after a few minutes switches the fan off too.

### NOTE:

While the Relax function is active, it is not possible to increase the power to level P5.

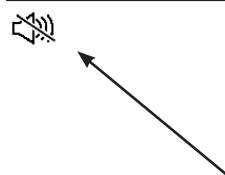
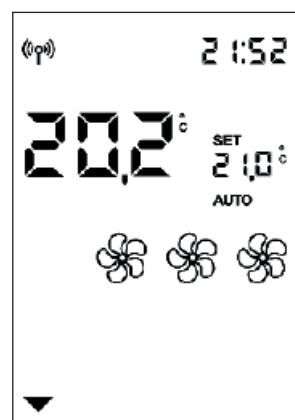

## - AIRKARE FUNCTION



This function is available as a standard feature on certain models and as an optional feature on other models: check which model you have.

The function, if available, can be activated with the product either on or off, in any mode (except in alarm mode).

The airKare can be activated or deactivated by pressing the dedicated  button

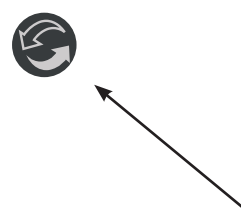
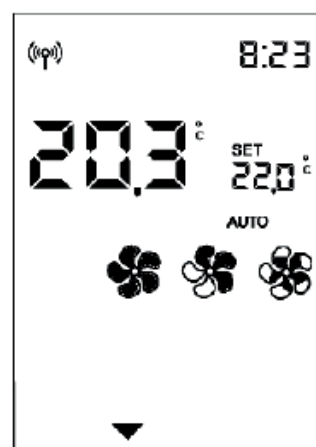

Its activation on the display will be signalled by the arrow relative to the airKare button.

## - EASY TIMER FUNCTION (delayed switching off and on)

This function switches the product on/off after a set period from activation of the function.

This is convenient if you go to bed and want the product to switch on/off after a few hours (maximum 12 hours).

### The Easy Timer function can be activated by pressing the dedicated button



By activating the Easy Timer function with the product on, the switch-off time can be set with ½ hour intervals.

By activating the Easy Timer function with the product off, the user sets the switch-on time.

Pressing the OK button or after 5" without pressing any button, the countdown will start with 5-minute intervals.

Example: Switch-ON in 1/2 hours' time.



The bar will continue to show the countdown which decreases until the product switches on or off.

The Easy Timer function can be deactivated by pressing the dedicated button.

The display will show an arrow above the button and the countdown.

To vary the timer before the switching on or off, it must be deactivated and then reset.

## CRONO

**After setting the times, temperatures or power levels in the CRONO MENU**, if the product is in automatic mode, the timer will work at room temperature, otherwise at the power setting.

Pressing the  button allows for switching from Crono in Temperature and Crono to Power and vice versa.



Briefly pressing the  button activates or deactivates the timer (programmed in advance from the app or remote control).

## NOTE

The timer is programmed from the MENU. The timer button is only used to activate/deactivate the function.

## - MENU

It can be accessed by pressing the  button and the first Menu item will appear.

You can scroll the menu items with the  and  buttons, and enter the item with the  button

The menu items appear in the following order:

**STAND-BY**  
**PELLET LOAD**  
**CRONO**  
**TEMP. CRONO**  
**DATE-HOUR**  
**LANGUAGE**

The following functions must be taken into account only following indications from the technician.  
 Therefore, we do not report the complete explanation in this document

**DISPLAY**  
**INFO**  
**SOFTWARE**  
**DATA**  
**ALARMS**  
**PELLET FALL**  
**PELLET SENSOR**  
**TECHNICAL MENU**  
**SET TEMPERATURE**

The set-point digits contain the progressive number of the menu item, while the status bar includes the description of the menu item in large letters.

### NOTE

Depending on the version, the order of the items may vary.



**We recommend, at the end of installation and commissioning, to check all the daily operations and useful documents with the technician.**



To exit the menu, press







## STAND-BY



When the Stand-by function is active, in the automatic and crono modes, the product switches off once the temperature set-point is reached and turns on again when the room temperature drops below the chosen value.

When the Stand-by function is not active, the product sets itself to minimum power when the temperature set-point is reached.

To access the function from the main menu (as indicated in the Menu section above), press the MENU button.

You can scroll the menu items with the  and  buttons, and enter the item with the  button

After entering the Stand-by function, the display will show the name of the function on the first line of the status bar and the current value on the second line (OFF if deactivated, ON if active).

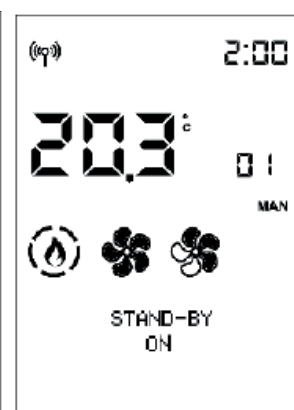
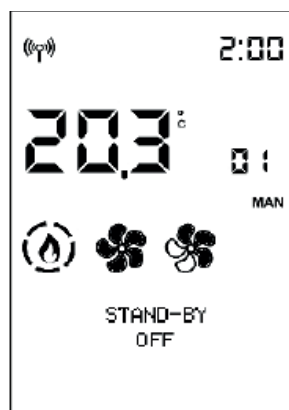

The  and  buttons can be used to modify the value from Off (function deactivated) to On (activated) and the  button can be used to confirm.

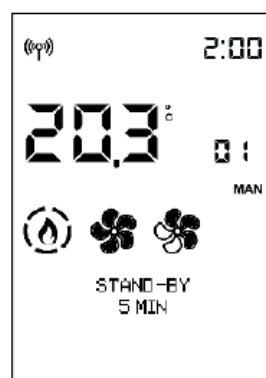

Pressing the  button with the value ON activates the function and the display will propose to choose how many minutes must pass before the device switches off in stand-by mode.

(example 5 minutes)



The  and  buttons can be used to modify the time, and the button  to confirm

Pressing the  button automatically takes you to the first level.





## PELLET LOADING

Allows you to load pellets after the pellet tank has been completely emptied.

Useful for the technician during the initial start-up.





Available only in the OFF status. Any attempt to activate the function in other statuses will not be allowed.

To access the function from the main menu (as indicated in the Menu section above), press the MENU button.

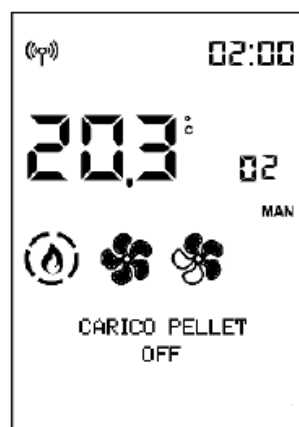
You can scroll the menu items with the  and  buttons, and enter the item with the  button

Once you have entered the **PELLET LOAD** function, the display shows the name of the function on the first line of the status bar and the current value on the second line (OFF if disabled, ON if enabled).









The  and  buttons can be used to modify the value from Off (deactivated) to On (activated) and conversely, while the  and  buttons are used to adjust it.

Pressing the  button automatically takes you to the first level.

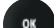
## - CRONO



To access the function from the main menu (as indicated in the Menu section above), press the MENU button.

You can scroll the menu items with the  and  buttons, and enter the item with the  button

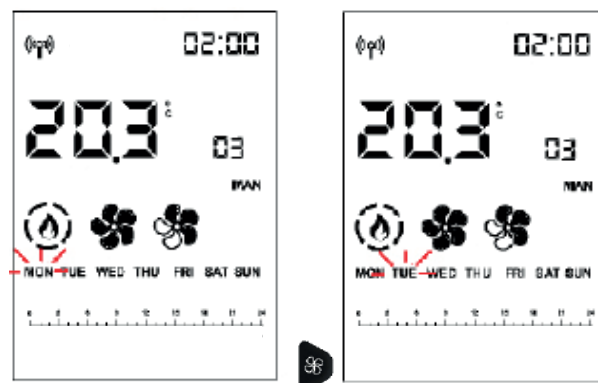
Choose the day of the week by scrolling the  and  buttons (you will simultaneously see the programme for that day) and confirm with the  button.





The cursor (rectangular) positions itself on 00:00.  
The time at the top RH shows the start of the time slot

Use the  and  buttons to scroll the time with 1/2-hour steps, by moving the cursor and displaying the pre-set level.





## USER INSTRUCTIONS

**EDILKAMIN**

The  and  buttons can be used to modify the temperature levels (OFF – T1 and T2) or the power levels (OFF – P1 and P5).



After reaching 23:30 you must go backwards.

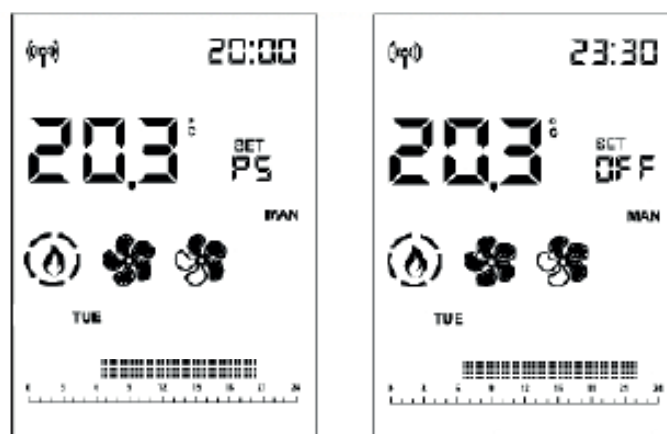

If you shift by pressing and holding the  or  buttons for more than 2", you copy the previous level onto the next level with a 1/2 h frequency per second.

The level can be copied also with backward shifts.



After setting the entire day, confirm with the  button



The copied day of the week flashes and you can shift to the next day using the  and  buttons

Confirm with the button



Briefly pressing the  button allows you to exit the programming mode, but the programme will not activate.

To activate it, you must briefly press the  button again from the main page.

## NOTES



The switching on and off of the product can be forced with the timer active, by pressing the ON/OFF button for 2".

Only with the Stand-by function active will the product switch off once the set temperature has been reached.



## TEMP. CRONO (T1-T2)

Temperature setting for timer T1 – T2



To access the function from the main menu (as indicated in the Menu section above), press the MENU button.

You can scroll the menu items with the  and  buttons, and enter the item with the  button

After entering the T1-T2 function, the display will show the name of the function on the first line of the status bar and the current value of T1 on the second line. T1 is the lowest temperature, T2 the highest.

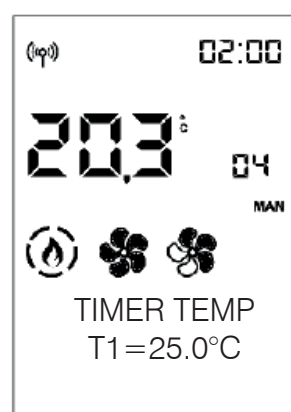
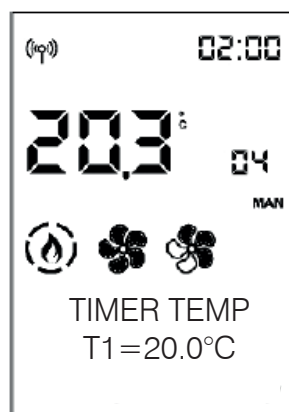
Use the  and  buttons to move to set-point T2 setting.



Modify the values with the  and  buttons and confirm with the  button

Pressing the  button automatically takes you to the first level.



## DATE-HOUR

Can be used to set the current date and time.

To access the function from the main menu (as indicated in the Menu section above), press the MENU button.

You can scroll the menu items with the  and  buttons, and enter the item with the  button

After entering the Date-Time function, the display will show the name of the function on the first line of the status bar and the current value of the first setting (12/24 hours) on the second line.

You can switch from 12 to 24 hours using the  and  buttons and confirm with the  button



You reach the AUTO SUMMER TIME item (OFF if deactivated ON if activated)

You reach the WEB SYNC item (OFF if deactivated ON if activated)

At the end the item SET HOUR will appear and it will be possible to modify the hours first with buttons + and - and confirm with the  button

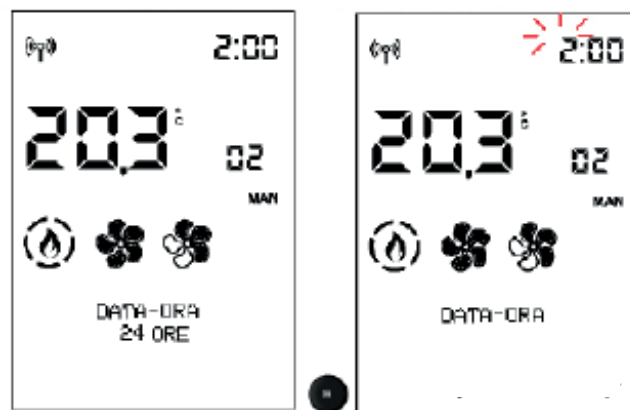
The minutes will then flash



The hours will then flash and can be modified using the  and  buttons, then confirmed with the  button

The minutes will then flash.





If the product is connected to the cloud, the date and time can be set from the web.

If the product is connected to a smartphone, the date and time can be set using the app.

## LANGUAGE

Selects the language.



To access the function from the main menu (as indicated in the Menu section above), press the MENU button.

You can scroll the menu items with the  and 

buttons, and enter the item with the  button

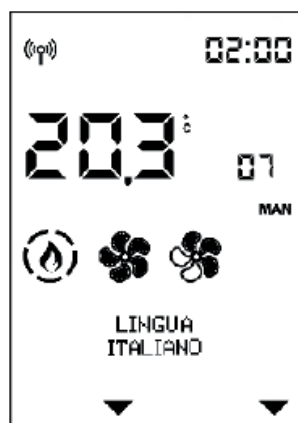
After entering the Language Menu item, the name of the function appears on the first line of the status bar and the current value on the second line (ENGLISH)



Modify the language using the  and  buttons then exit and confirm with the  button

Pressing the  button automatically takes you to the first level.

**The following functions must be taken into account only following indications from the technician.  
Therefore, we do not report the complete explanation in this document.**



**DISPLAY**

Allows you to change the brightness of the display and an acoustic signal when the keys are pressed

**BRIGHTNESS ON**

Indicates the backlight percentage of the display.

You can switch from one percentage to the other with buttons + and - and confirm with OK button

**STBY BRIGHTNESS**

Indicates the backlight percentage of the display before entering energy saving mode

**TIME ON**

Indicates the time the display remains illuminated

**STANDBY TIME**

Indicates the amount of time the display remains illuminated before entering power saving mode

**BEEP**



Allows to enable an acoustic signal when the buttons are pressed (OFF if deactivated ON if activated)

**INFO**

These readings should only be done when requested by the technician.

The technician understands the diagnostic meaning of the messages and values, and may ask you to read them to him/her if you experience problems.

To access the function from the main menu (as indicated in the Menu section above), press the MENU button.

You can scroll the menu items with the  and  buttons

Pressing the  button automatically takes you to the first level.

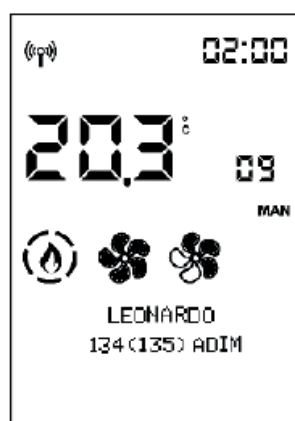
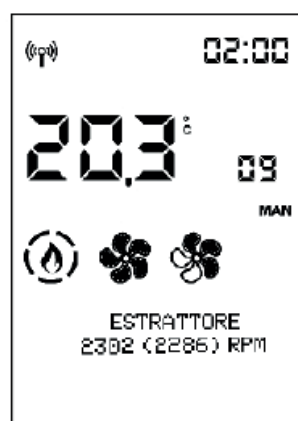
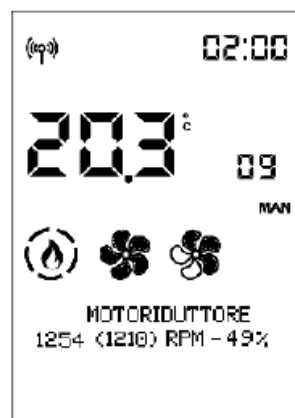
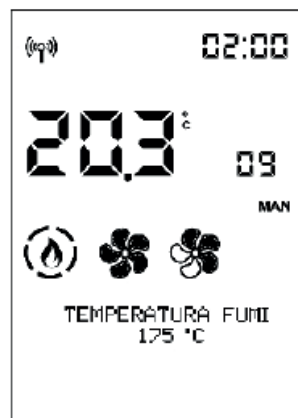

**- INFO (info for INSTALLER continues)**

They provide instant situation values.

**Flue temperature** indicates the value of the temperature read inside the product. To be read only under the guidance of the Technical Assistance Centre

**Auger motor**: indicates the speed set and read. Useful for understanding any anomaly in the motor that loads the pellets. To be read only under the guidance of the Technical Assistance Centre

**Extractor**: indicates the speed set and read. Useful for understanding any anomaly in the engine that creates depression in the combustion chamber. To be read only under the guidance of the Technical Assistance Centre

**Leonardo**: indicates the target value set and read. To be read only under the guidance of the Technical Assistance Centre

**Fan1**: indicates the output voltage. To be read only under the guidance of the Technical Assistance Centre

**Ignition plug (spark plug)**: indicates whether the ignition component is on or off. Useful in the ignition phase to understand functionality.

**Home automation contact**: indicates whether ON or OFF. Useful for understanding functionality.

**Radio signal**: indicates the signal strength in milliwatt decibels. Admissible values from 0 to -95dB

**- SOFTWARE**

Indicates:



- the firmware version of the electronic board (basic board)
- the firmware version of the control panel
- the database (associated by the Technical Assistance Centres with the products)

To be read only under the guidance of the Technical Assistance Centre

## DATA

Information of the product's operation log can be scrolled with the  and  buttons



To access the function from the main menu (as indicated in the Menu section above), press the MENU button.

You can scroll the menu items with the  and  buttons, and enter the item with the  button



Pressing the  button automatically takes you to the first level.

## ALARMS

Information of the product's operation log can be scrolled with the  and  buttons.

Readings to be carried out under the guidance of a technician. The meaning of the abbreviations is in the dedicated paragraph  
The alarms are arranged from the most recent to the oldest.

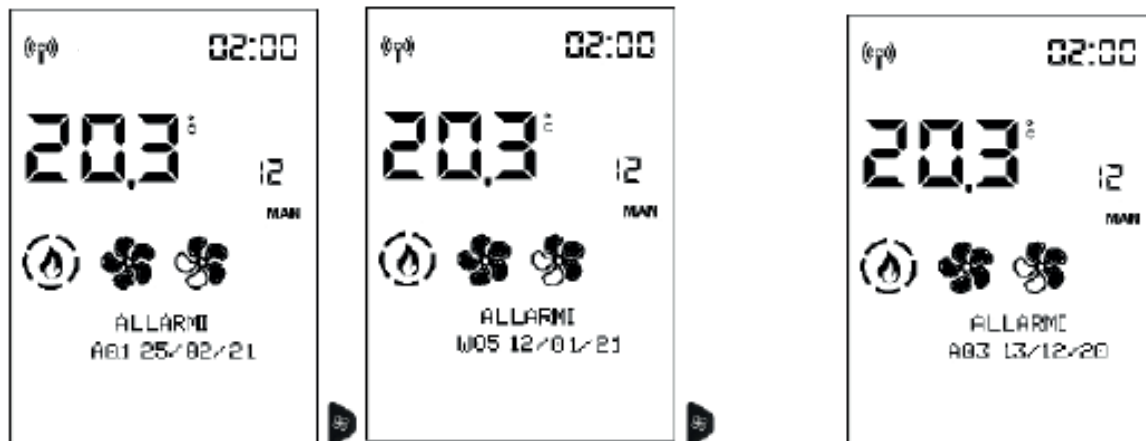

Exit with the button 

## PELLET FALL

Allows to set the auger motor in continuous cycle or in steps. To be carried out **ONLY UNDER THE GUIDE OF A TECHNICIAN**.

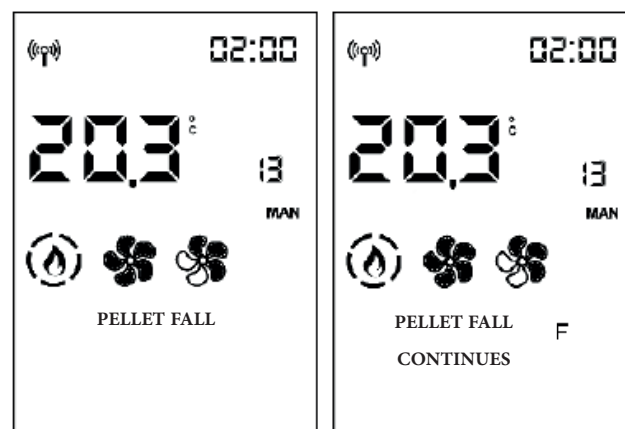

## PELLET SENSOR

Allows you to set ON or OFF of the pellet level sensor.

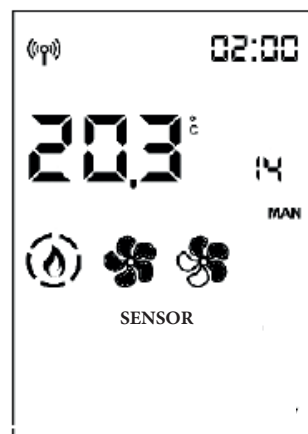

## TECHNICAL MENU (for TECHNICIANS ONLY)

Accessible only by technicians with password (1111). Once the password has been entered, confirm with the  button

If you enter with the installer password (1111) you will only access the following installer parameters/settings:

- **FLAME TYPE**
- **PELLET TYPE**
- **PARAMETERS**



### - **FLAME TYPE (for the TECHNICIAN ONLY)**

In correct installation conditions, with the Service Centre parameters appropriately adjusted, with quality pellets, the intensity of the flame is adjusted:

STANDARD  
ECO  
PLUS

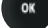
After entering the Technical Menu, the first item, "FLAME TYPE", will appear

You can enter the Flame Type setting using the  button

while the  and  buttons can be used to modify the correction value.

Pressing the  button automatically takes you to the first level.





## NOTES

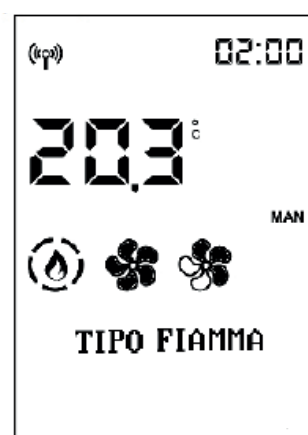

inappropriate changes can cause the product to seize up

Information on how to use these functions is only available to technicians in the appropriate web area.

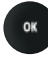

### - PELLET TYPE

You can scroll the Technical Menu items with the  and  buttons until you reach "PELLET TYPE"

Enter the Pellet Type (%) setting with button  and the value can be modified with button  and 

Use the  button to exit and return to the Technical Menu

In correct installation conditions, with the Service Centre parameters appropriately adjusted, with quality pellets, the pellet load is adjusted

MEDIUM

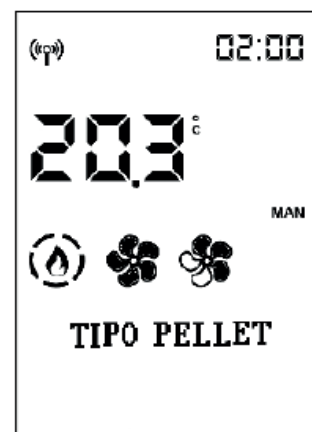

HIGH

LOW







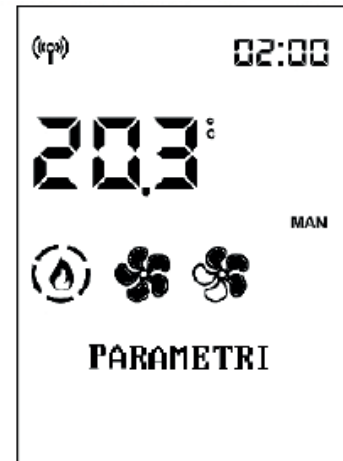

## - PARAMETERS

Scroll through the items of the Technician Menu with buttons  and  up to the item "PARAMETERS".

You enter the Parameters with button , the first parameter is displayed.



Scroll through the parameters with  and  and the value can be modified with buttons  and .

If you entered the Technician Menu with the Installer Password, only the Installer parameters appear, otherwise all the parameters appear.

## PARAMETERS (continue PARAMETERS for INSTALLER)

**SENS. PLT LEVEL:** enables or disables the possibility for the end customer to view and choose the status of the pellet reserve indicator

**AIRKARE FUNCTION:** allows to select IF Airkare is active and on which room size (SMALL, less than 30 m<sup>3</sup>, or BIG) or not active (OFF)

**AIRKARE RESET :** allows to reset the working hours of airKare

**DUCTING 2:** allows you to activate the speed of the ducting fan at maximum (ON-OFF)

**DUCTING 3** allows you to activate the speed of the ducting fan at maximum (ON-OFF)

**NUMBER OF FANS:** enables or disables the possibility for the end customer to operate the fan if present.

**ROOM INPUT:** allows to choose which item the end customer reads and adjusts on the Home display. It depends on the type of plant:

- PROBE: room probe, standard in the product
- THERMOSTAT: enables the thermostat, which can be installed in place of the room probe.

**ROOM2/CYL.INPUT:** defines the item to be enabled according to the connected component.

- NO INPUT: default
- PROBE
- THERMOSTAT

**IN. AMB3/CYL/SE:** defines the item to be enabled according to the connected component.

- NO INPUT: default
- PROBE
- THERMOSTAT

**CRONO SYNCHR.:** synchronises the timer

**UNPAIR BLUETOOTH:** enable

**SET TEMPERATURE**

Allows the correction of the reading of some temperature probes. To be carried out ONLY UNDER THE GUIDE OF A TECHNICIAN.

- ADJ ROOM1
- ADJ TEMP.RADIO



### NOTES FOR THE MAINTENANCE

- **Before doing any maintenance, disconnect the appliance from the mains.**
- **Regular maintenance is essential to keeping the appliance in good working order.**
- **Failure to service the product properly will prevent it from working properly.**
- **Any problems due to failure to service the stove will void the warranty.**
- **Do not dump the cleaning residue into the pellet tank.**
- **Do not make unauthorised modifications.**
- **Use original spare parts. Using non-original parts voids the warranty.**
- **Use a vacuum cleaner to clean the stove. The entire procedure takes only a few minutes.**
- **Using the stove without cleaning the grate can cause the gas in the combustion chamber to ignite and detonate.**
- **Do not vacuum up hot ash; this damages the vacuum cleaner and may cause a fire.**

### DAILY MAINTENANCE (figure 1, facing page)

**This must be done with the appliance switched off and cold.**

- Open the door and extract the two-part grate (1) and ash drawer.
- Empty out the ash drawer (2) and grate into a non-flammable container.
- Vacuum out the interior of the hearth, the bed, and the compartment around the grate into which the ash falls.
- Use the cleaning brushes (3) under the styling grille. **MAKE SURE THEY ARE COLD OR USE GLOVES TO DO SO.**
- Scrape the grate and clean out any obstructed holes.
- If necessary, clean the glass (when cold) with a suitable product.

### MONTHLY INSPECTION (figure 2, facing page)

**This must be done with the appliance switched off and cold.**

Open the door and inspect the condition of the interior. If the stove is being used frequently, consider whether to remove and clean the deflector (4). As shown in the sectional view on the facing page, make sure to reposition it properly at the top. Positioning it improperly can cause irregular combustion and blacken the glass.

The deflector positioning procedure is given in the section on seasonal maintenance (two pages below)



**Make sure the grate is seated properly, without ash or uncombusted matter trapped around its border.**



**ATTENTION:**  
**make sure the ash tray is correctly positioned in its housing**  
**Take care not to bang the door when closing it**

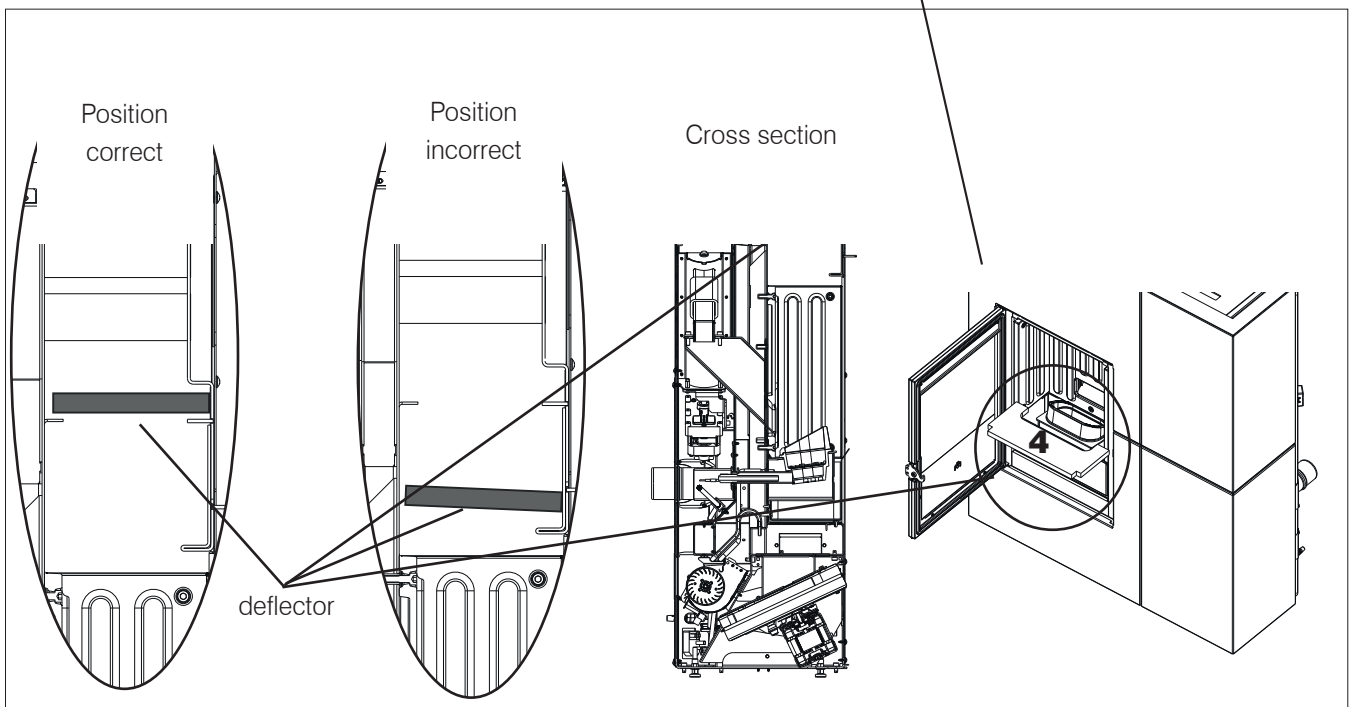
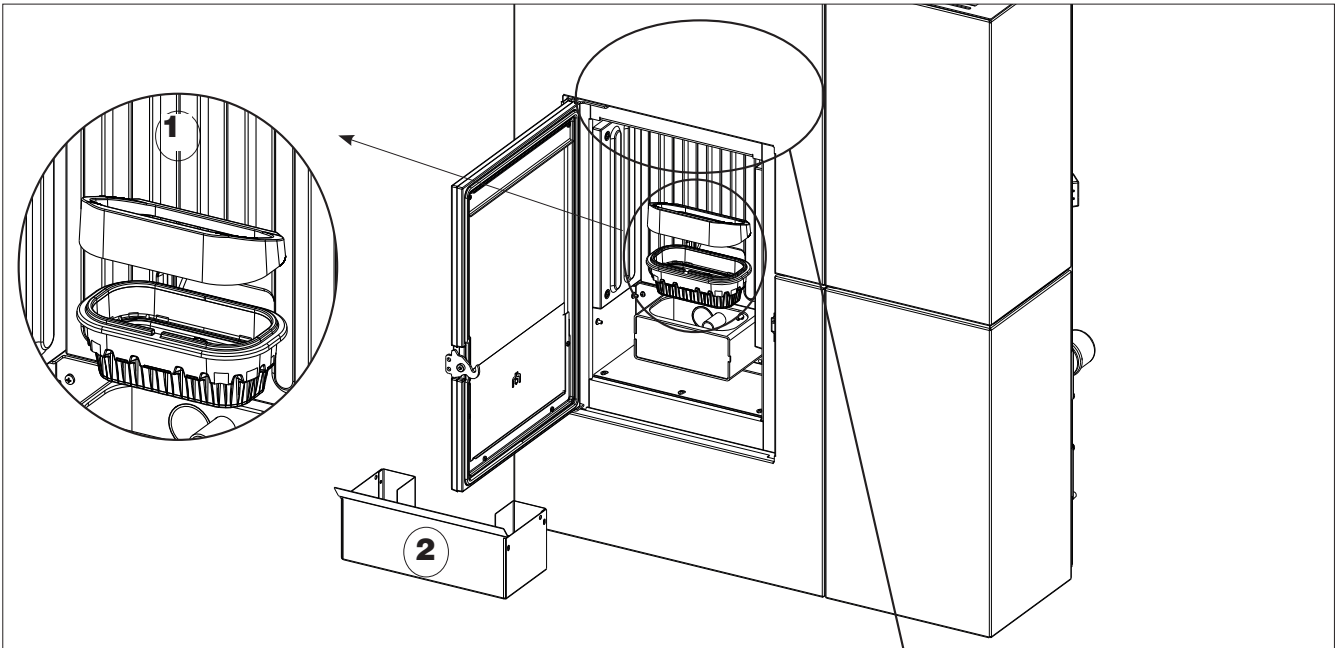

### SEASONAL MAINTENANCE (implemented by the DEALER)

Clean the stove internally and externally

**In the event of very frequent use of the oven, it is advised cleaning of the smoke passage duct and smoke channel every 3 months.**

You should clean the chimney system at least once a year (check local regulations for details).

If you fail to regularly clean and inspect the system, there is an increased risk of the chimney pot catching fire.

We remind you not to use compressed air during the seasonal maintenance for cleaning the air inlet pipe.

### REPAIRS

To be performed only by Edilkamin technical assistance centres/authorised distributors. The names of Edilkamin technical assistance centres (TAC) and official, authorised distributors are available ONLY at [www.edilkamin.com](http://www.edilkamin.com)

### SUMMER SHUTDOWN

During the period of disuse, keep the doors, hatches and lids closed.

In particularly humid areas, it may be necessary to disconnect the air intake and fume connector.

### SPARE PARTS

For any spare parts, contact your dealer or technician.

The names of Edilkamin technical assistance centres (TAC) and official, authorised distributors are available ONLY at [www.edilkamin.com](http://www.edilkamin.com)

Using non-original spare parts may damage the appliance and relieves Edilkamin of all liability for any resulting damages. This also invalidates the warranty on the basis of tampering.

Do not make unauthorised modifications.

### DISPOSAL

At the end of its service life, dispose of the product as required by regulations.



In accordance with art. 26 of Legislative Decree no. 49 of 14th March 2014, "Implementation of Directive 2012/19/UE on the disposal of electrical and electronic devices (RAEE)".

The crossed-out dustbin symbol displayed on equipment or its packaging indicates that the product at the end of its life must be collected separately from other waste.

At the end of its useful life, the user should therefore deliver the product to a suitable local sorted collection centre for electrical and electronic devices.

Sorted collection for recycling, treatment and environmentally compatible scrapping contributes to the prevention of negative effects on the environment and health, and promotes the re-use and recycling of the materials of which the equipment is made.

If problems occur, the product shuts itself off automatically.

The display will show the reason (see below).

Do not disconnect from the power supply.

To restart the product, wait for the switch-off sequence to terminate and then press the ON/OFF button



of the remote control or the simplified switch-on button.

Before starting the product up again, check the reason for the shutdown and CLEAN the burning pot.

The product is equipped with the necessary safety devices but, if the burning pot is not cleaned regularly as explained above, ignition may involve a slight detonation. If white smoke forms in the combustion chamber for a long time, disconnect the mains supply and wait 30 minutes before opening the door and emptying out the burning pot.

### SHUTDOWN MESSAGES AND THEIR SOLUTIONS:

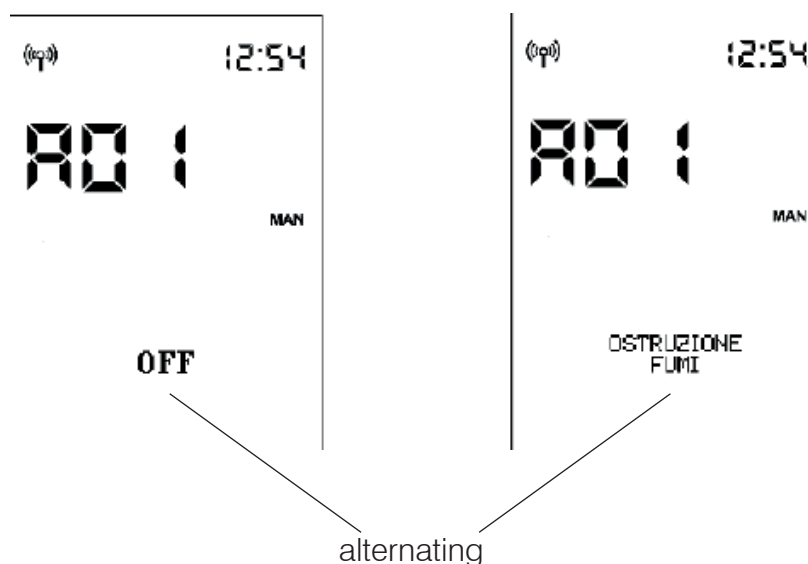

In case of an alarm, an alarm code will appear instead of the room temperature.

While the product switches off, the status bar will alternately show "OFF" in large letters and the description of the alarm in small letters.

If the alarm occurred with the timer active, only the timer's activation arrow will remain displayed, while the day's time schedule will disappear.

Once the switch-off sequence terminates, only the alarm description will remain.

## IN THE EVENT OF PROBLEMS

EDILKAMIN

MESSAGE	PROBLEM	SOLUTION
<b>A01</b>	displays when the combustion air intake is below the set level	<ul style="list-style-type: none"> <li>• Check that the combustion chamber door is closed</li> <li>• Check the regular maintenance of the product</li> <li>• Check that smoke discharge and combustion air ducts are clean.</li> </ul>
<b>A02</b>	displays when the logic board is not detecting the right fumes fan speed	<ul style="list-style-type: none"> <li>• Contact the technician</li> </ul>
<b>A03</b>	displays when the thermocouple detects a fume temperature lower than the set value and interprets this as the absence of flame	<ul style="list-style-type: none"> <li>• Check that there are pellets in the tank</li> <li>• Contact the technician</li> </ul>
<b>A04</b>	displays when ignition times out unsuccessfully	<p>There are two possibilities: NO flame:</p> <ul style="list-style-type: none"> <li>• Check that the burning pot is seated properly and clean</li> <li>• Check that there are pellets in the tank and burning pot</li> <li>• Try switching it on with a solid ecological igniter (contact the technician beforehand and follow the instructions of the igniter supplier very carefully).</li> </ul> <p>The operation must be regarded purely as a trial under the technician's guidance.</p>
<b>A05</b>	Shutdown due to air flow rate sensor breakage	<ul style="list-style-type: none"> <li>• Contact the technician</li> </ul>
<b>A06</b>	displays when the logic board determines that the fumes thermocouple is broken or disconnected	<ul style="list-style-type: none"> <li>• Contact the technician</li> </ul>
<b>A07</b>	Shut-down due to exceeding maximum fumes temperature.	<ul style="list-style-type: none"> <li>• Check the type of pellet (contact the technician if in doubt)</li> <li>• contact the technician</li> </ul>
<b>A08</b>	Switching OFF due to excessive overheating of the product	<ul style="list-style-type: none"> <li>• see A07</li> </ul>
<b>A09</b>	Shutdown due to gearmotor failure.	<ul style="list-style-type: none"> <li>• Contact the technician</li> </ul>
<b>A10</b>	Switching OFF due to circuit board overheating.	<ul style="list-style-type: none"> <li>• Contact the technician</li> </ul>
<b>A11</b>	Switching OFF due to the intervention of the safety pressure switch.	<ul style="list-style-type: none"> <li>• Ensure the product and flue are clean</li> <li>• Contact the technician</li> </ul>



MESSAGE	PROBLEM	SOLUTION
<b>A12</b>	Room temperature probe failure. The product is operating in manual mode.	<ul style="list-style-type: none"> <li>• Contact the technician</li> </ul>
<b>A14</b>	Ducting room temperature probe (if present) fault. The product is operating in manual mode.	<ul style="list-style-type: none"> <li>• Contact the technician</li> </ul>
<b>A20</b>	Gearmotor fault switch-off	<ul style="list-style-type: none"> <li>• Contact the technician</li> </ul>

**MESSAGES WHICH DO NOT SHUT THE STOVE DOWN, BUT ARE SIMPLY WARNINGS****LOW REMOTE CONTROL BATTERY LEVEL:**

The battery symbol displays on the remote control display if the battery is low.

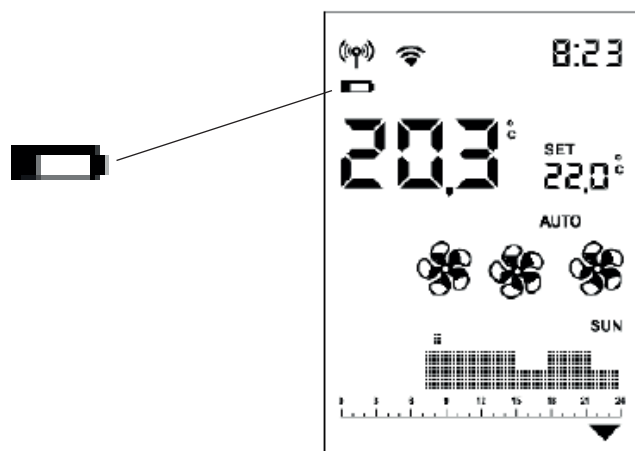
**MAINTENANCE:**

A spanner symbol will appear on the display after 2,000 hours of operation.

The product is working, but it must be serviced by an authorised Edilkamin technician.

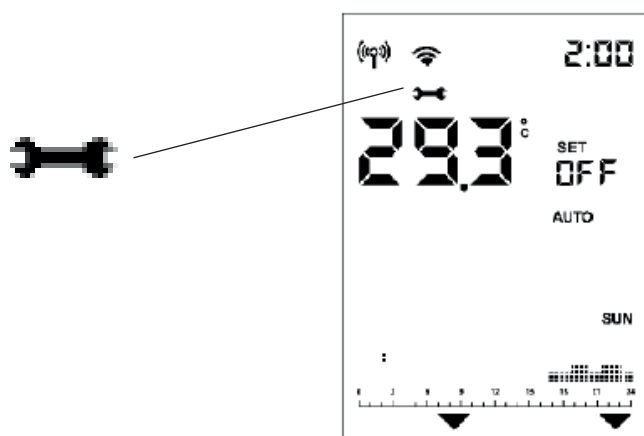
**LACK OF COMMUNICATION:**

In case of a prolonged lack of communication between the stove and the remote control, the Bluetooth transmission icon will disappear as well as the icons transmitted by the circuit board to the remote control. Only the room temperature and the time will remain visible.



The Wi-Fi transmission icon will only be present if there is a connection between the circuit board and the Wi-Fi router.

**PELLETS RESERVE INDICATOR:**

The function is only available if the pellet level sensor is installed and has been activated.

When the level sensor intervenes, the circuit board emits a single “beep” (in any switch-on or work status) and the moving reserve symbol will appear on the display.

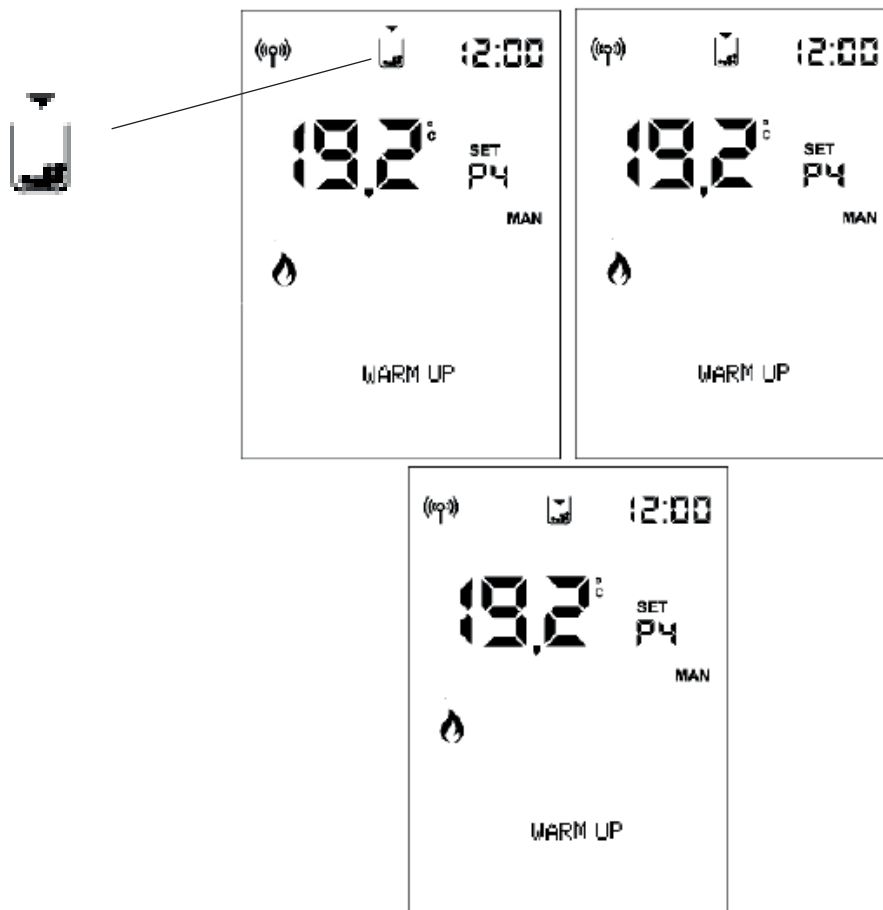

The arrows will light up in sequence to signal the need for pellet loading.

The ignition frequency is roughly 0.5 seconds.

After an interval of roughly 20/30 minutes, which varies depending on the model, the stove switches off due to a shortage of pellets.

If the user reloads the stove before the start of the switch-off procedure, the symbol disappears and the stove resumes its normal operation.

If the user fails to reload the stove before the start of the switch-off procedure, the stove switches off and the tank symbol remains steady lit with the 3 arrows on until the next reloading operation.

When the reserve symbol is present, the stove cannot be restarted.

After reloading the pellets, the stove must be restarted manually.

If the pellets are reloaded and there is an ignition request coming from the timer, the stove will restart.

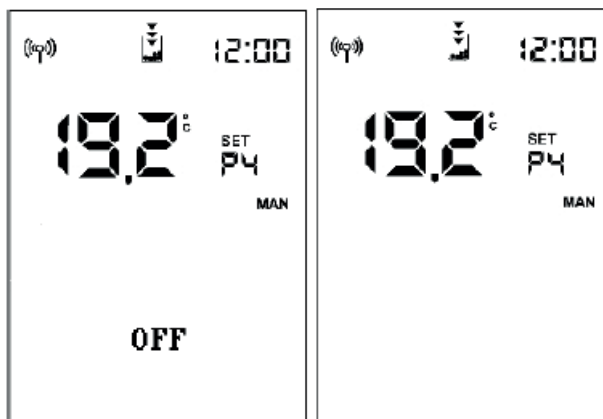

If the sensor intervenes:

- with the stove OFF or in Initial Cleaning mode (following manual emptying of the tank), the final symbol will immediately appear and the stove cannot be switched on;
- during the ignition phase, the ignition sequence will be completed even if it lasts more than the 20/30 minutes of residual autonomy.

If the pellets are not reloaded, the stove will then switch off.

During a switch-off following a **BLACKOUT**, the display will alternately show the words "Black-Out" and "OFF". Once the switch-off has been completed, the product will remain off and "Black-Out" will appear.

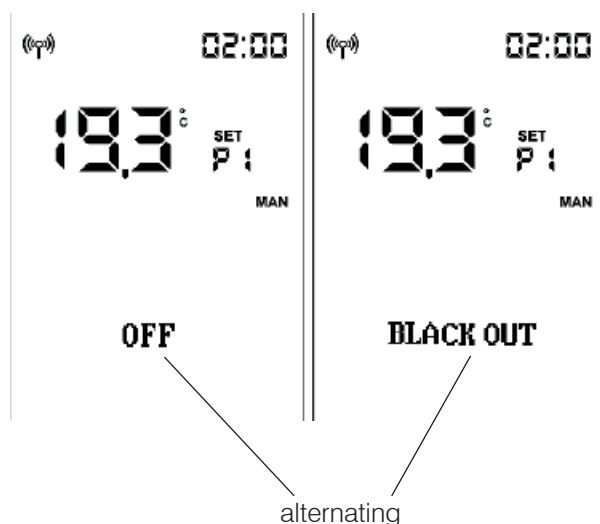



[illegible]



The names of Edilkamin official, authorised technical assistance centres (TAC) and distributors are available ONLY at  
[www.edilkamin.com](http://www.edilkamin.com)

