

PELLET STOVE

## KIRA EVO EVO VYDA



## CONTENTS

---

Introduction and who the manual is for	3
Safety information	4
Dimensions	5
Technical data	7
Unpacking	8
Installation	10
Fitting the cladding KIRA EVO	15
Fitting the cladding VYDA EVO	20
User instructions	26
Maintenance	64
Troubleshooting	69

---

*Edition in English translated from the original version in Italian*

The undersigned EDILKAMIN S.p.A., with registered office in  
Via Vincenzo Monti 47 - 20123 Milan (Italy) - Tax ID Code and  
VAT number 00192220192

Hereby declares, under its sole responsibility, that:  
The pellet stove mentioned below complies with EU  
Regulation 305/2011 and the harmonised EU standard  
EN 14785:2006

PELLET STOVE, trade name EDILKAMIN, model KIRA EVO  
- VYDA EVO

SERIAL NO.: Rating plate reference  
KIRA EVO - VYDA EVO : Performance declaration: (DoP - EK  
No. 202):

Moreover, the company hereby declares that:  
the KIRA EVO - VYDA EVO wood pellet stove satisfies the  
requirements of the following European directives:  
2014/35/EU - Low Voltage Directive  
2014/30/EU - Electromagnetic Compatibility Directive

Dear Sir/Madam

We thank you for and congratulate you on choosing our product. Before using it, we would ask you to read this manual carefully, so that you can make the most of all its functions in total safety.

This manual is an integral part of the product. We ask you to keep it for the entire lifetime of the product. If you lose it, you can request a copy from your dealer or download it from [www.edilkamin.com](http://www.edilkamin.com).

## Readers of the manual

This manual is addressed to:

- those who use the product at home ("USER");
- the technician who will install the product ("INSTALLER")

The target person of each page is indicated in a band at the bottom of the page (USER or INSTALLER).

## General information

After unpacking the product, check the condition and completeness of the contents.

In the event of error, immediately contact the retailer where the purchase was made, providing him with a copy of the warranty booklet and sales receipt.

The appliance must be installed and operated in compliance with local and national law and European regulations. For the installation, and for anything not specifically indicated in the manual, observe local regulations.

The diagrams provided in this manual are for illustration purposes only: they do not always strictly refer to your specific model, and are not binding in any way.

## Product identification and warranty.

The product is uniquely identified by a number, the "counterfoil", which is indicated on the warranty certificate.

Please keep:

- the warranty certificate accompanying the product
- the purchase receipt given to you by the retailer
- the declaration of conformity given to you by the installer.

The warranty conditions are given in the warranty certificate accompanying the product.

The warranty, however, covers only demonstrable manufacturing defects and not, for instance, problems resulting from improper installation or calibration.

### MEANING OF SYMBOLS

In some parts of the manual the following symbols are used:



#### PLEASE NOTE:

carefully read and understand the message in question, since failure to follow the instructions in it could cause serious damage to the product and put the safety of those using it at risk.



#### INFORMATION:

failure to comply with these requirements will compromise product use.



#### OPERATING SEQUENCE:

follow the instructions for the operations described.

- The product is not designed for use by people, including children, with limited physical, sensory and mental abilities.
- The appliance is not designed for cooking purposes.
- The appliance is designed to burn UNI EN ISO 17225-2 category A1 wood pellets, in the amounts and manner described in this manual.
- The appliance is designed for indoor use and in areas with normal humidity conditions.
- Keep the product in a dry place out of the weather.
- For the legal and company warranties, refer to the warranty certificate inside the product: specifically, neither Edilkamin nor the retailer are liable for damage resulting from incorrect installation or maintenance.

Safety risks may be caused by:

- Installation in non-suitable settings, in particular those that are subject to fire risks. **DO NOT INSTALL THE PRODUCT IN AREAS SUBJECT TO THE RISK OF FIRE.**
- Contact with fire and hot parts (e.g. glass panel and pipes). **DO NOT TOUCH HOT PARTS** and, when the stove is switched off and still hot, always wear the glove.
- Contact with live electrical equipment (internal). **DO NOT ACCESS THE INTERNAL ELECTRICAL EQUIPMENT WHILE THE APPLIANCE IS POWERED ON.** Electrocution hazard.
- Use of improper ignition aids (e.g. alcohol). **DO NOT IGNITE OR BOOST THE FLAME WITH FLUID SPRAYS OR A FLAME TORCH.** Serious risk of burns, damage and injury.
- Use of fuel other than wood pellets. **DO NOT BURN WASTE MATTER, PLASTIC OR MATERIALS OTHER THAN WOOD PELLETS IN THE COMBUSTION CHAMBER.** The product may become soiled, the flue may catch fire, and environmental damage may ensue.
- Cleaning the combustion chamber when hot. **DO NOT CLEAN WITH A VACUUM CLEANER WHEN HOT.** You could damage the vacuum-cleaner and risk the emission of smoke in the room.
- Cleaning the smoke duct with cleaning products. **DO NOT CLEAN THE PRODUCT WITH FLAMMABLE PRODUCTS.** Risk of fire or blowback.
- Cleaning the glass pane while hot or with unsuitable cleaning products. **DO NOT CLEAN HOT GLASS WITH WATER. ONLY USE RECOMMENDED GLASS CLEANING PRODUCTS.** Risk of cracking and permanent, irreparable damage to the glass.
- The storage of flammable materials at a distance which is less than the safe distances listed in this manual. **DO NOT PLACE LAUNDRY ON THE APPLIANCE. DO NOT PLACE DRYING RACKS WITHIN THE SAFETY CLEARANCE.** Keep flammable fluids away from the appliance. Fire hazard.
- Blocking the aeration vents and air intakes in the room. **DO NOT BLOCK THE AERATION VENTS OR FLUE.** Risk of smoke returning into the room with consequent damage and injury.
- Use of the product as a support or ladder. **DO NOT CLIMB ONTO THE PRODUCT OR USE IT AS A SUPPORT.** Risk of damage and injury.
- Use of the stove with the combustion chamber open. **DO NOT USE THE PRODUCT WITH ITS DOOR OPEN.**
- Incandescent material may come out from the open door. **DO NOT** throw incandescent material outside the appliance. Fire hazard.
- Use of water in case of fire. **CALL THE AUTHORITIES** if a fire breaks out.
- If you have doubts, please do not take any action, but contact the retailer or the installer.

For reasons of safety, read the user instructions included in this manual.

KIRA EVO - DIMENSIONS (cm)

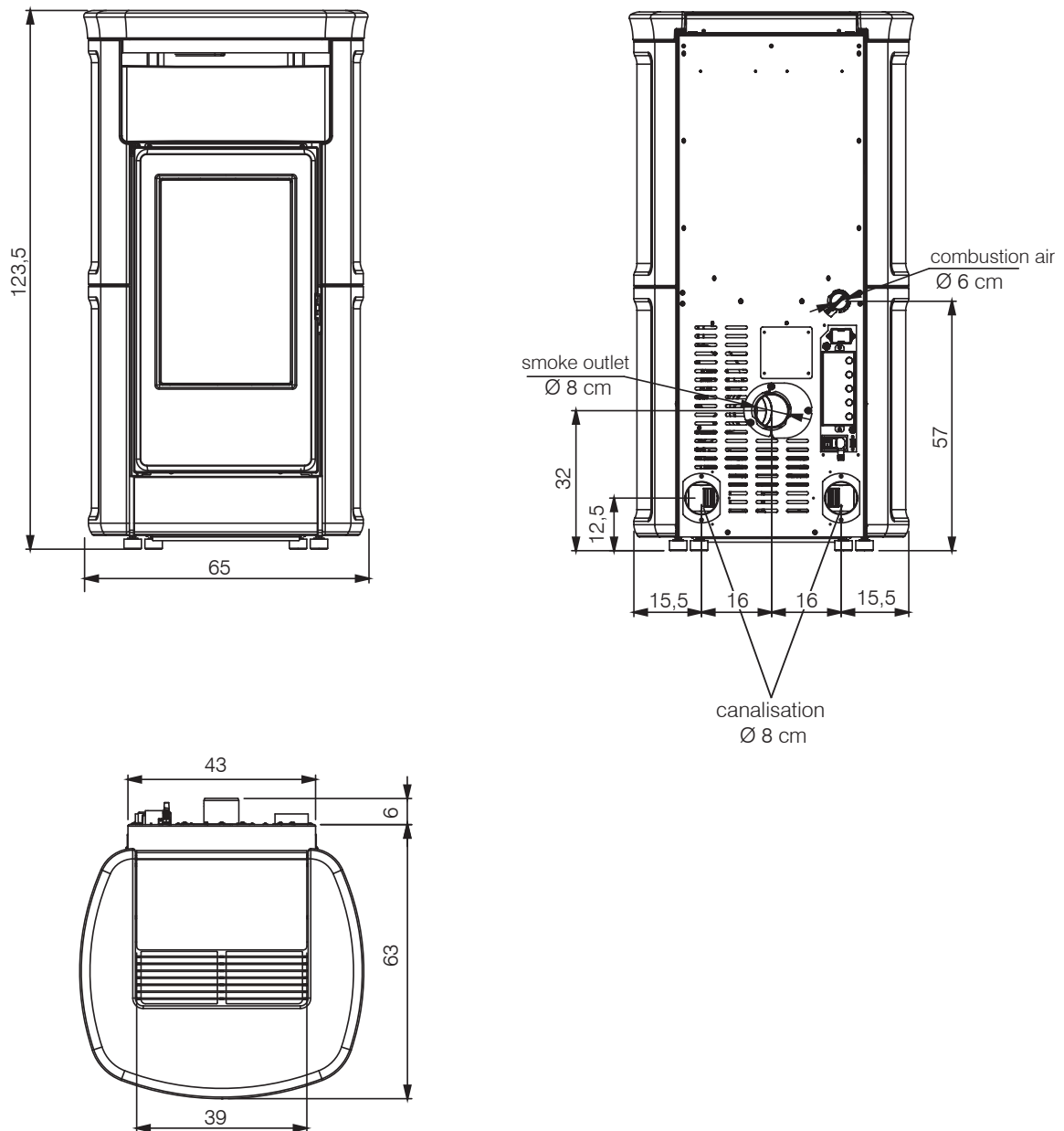

**DIMENSIONS****EDILKAMIN**

## VYDA EVO - DIMENSIONS (cm)

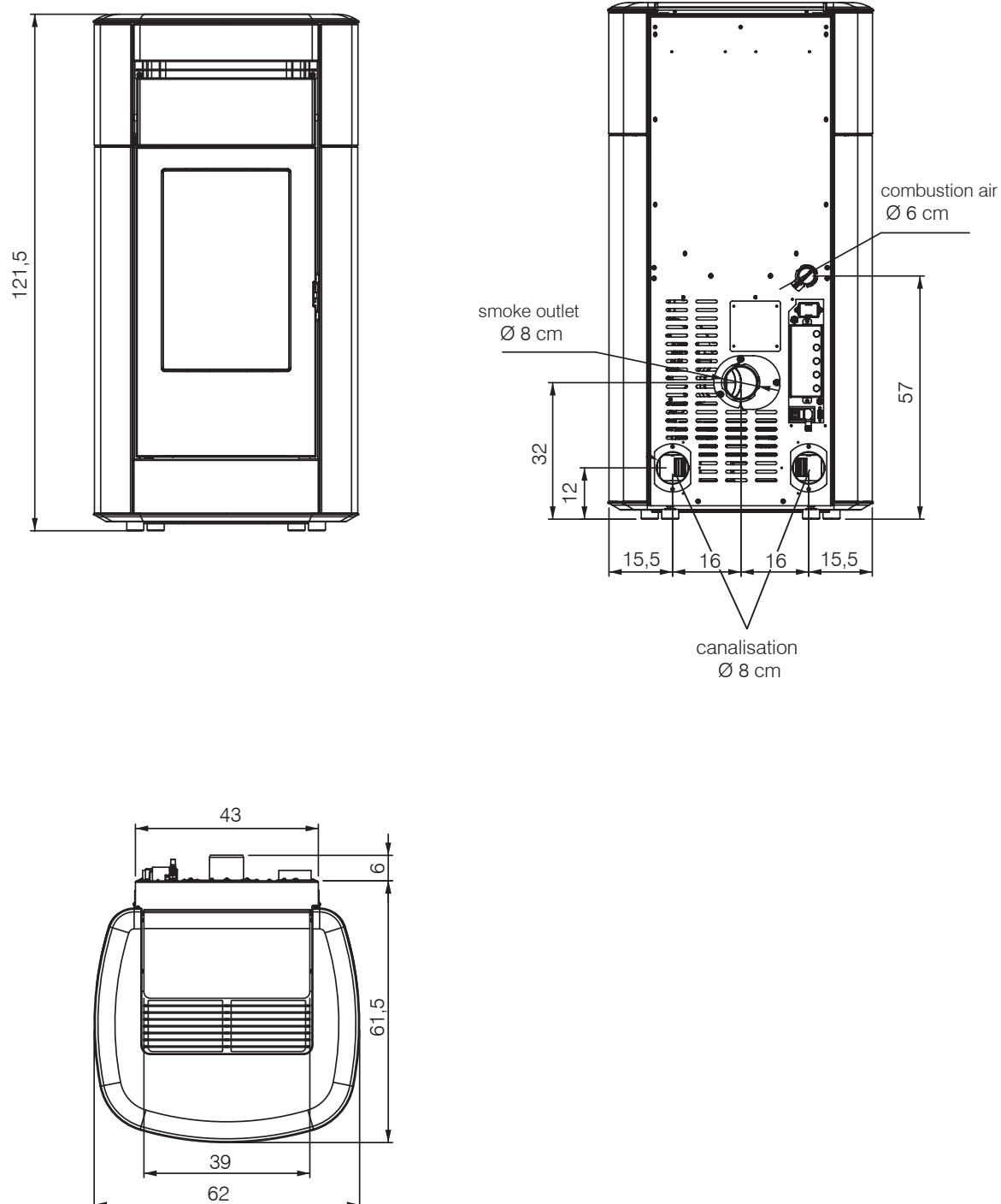
**USER/INSTALLER**

**TECHNICAL DATA EN 14785** in accordance with EN 14785 The data shown below refers to the actual installation and use and was taken during the certification phase by a notified body under the conditions.

	<b>KIRA EVO - VYDA EVO</b>		
	Nominal power	Reduced power	
Available power	14,8	4,8	kW
Efficiency	89,9	93,9	%
CO emissions at 13% O <sub>2</sub>	0,010	0,003	%
Fumes temperature	203	97	°C
Fuel consumption *	3,4	1,1	kg/h
Tank capacity	32		kg
Draw	12	10	Pa
Autonomy	9	29	ore
Heatable volume **	385		m <sup>3</sup>
Fumes outlet diameter	80		mm
Air intake diameter	40		mm
Ducting diameter	80		mm
Weight with packaging	267-180		kg
Energy efficiency class according to UE 2015-1186 regulation (Class A+ +/G)	A+		

\*A calorific value of 4,8 kW/Kg has been used to calculate consumption.

\*\* The heatable volume is calculated based on the assumption of a heating demand of 33 Kcal/m<sup>3</sup> hour.

The product can be used safely even with a higher depression.

Excessive draft, however, could lead to shutdown and / or high efficiency.

**TECHNICAL DATA FOR RATING THE FLUE**

which must in any case satisfy the requirements of this sheet and the installation instructions for the product

	Nominal power	Reduced power	
Fumes temperature at smoke outlet	244	116	°C
Minimum draw	0,01		Pa
Fumes flow rate	7,7	3,7	g/s

**ELECTRICAL SPECIFICATIONS**

Power supply	230 Vac +/- 10% 50 Hz
Nominal power absorbed	130 W
Reduced power absorbed	30 W
Power absorbed in stand by	2 W
Potenza assorbita in accensione	320 W
Remote control frequency (provided)	2,4 GHz
Protection rating	Fuse 4 AT, 250 Vac 5x20

**EDILKAMIN s.p.a. reserves the right to modify the product without notification in the interests of improvement.**

**PREPARATION AND UNPACKING**

The packaging materials are neither toxic nor noxious and do not require special disposal.

The user is responsible for storing, disposing of and recycling them in a regulatory fashion.



Always move the stove in an upright position with suitable equipment and in observance of safety regulations.

Do not turn the package over, and handle all parts requiring installation with care.

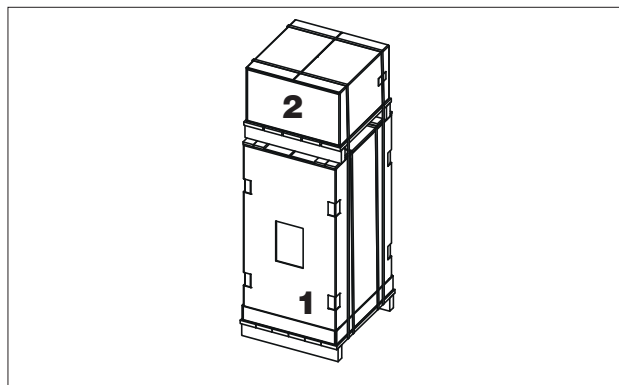
**PACKAGING** (further information in the paragraph on linings)

The delivery consists of two packages:

- one **(1)** with the structure of the stove
- one **(2)** with the ceramic or stone cladding

In the stove package you will find:

- warranty certificate,
- this manual,
- remote controlo;
- power cable,
- small parts for installing the lining \* (further details on the following page),
- grille of the top,
- protective lever (removable handle) for opening the combustion chamber door.

The metal grille of the top is contained in package (1) with the stove, provided with the small parts for its installation (three M4 screws for the ceramic parts and M6 for the stone parts, washers and rubber buffers to be applied on top of the grille)

\* Other small parts (for VYDA EVO and KIRA EVO )

- M4 screws with washers for fixing the ceramic parts
- M5 screws with washers for the ceramic sides of KIRA EVO
- M6 screws for fixing the stone parts
- cable glands for the terminal board on the rear

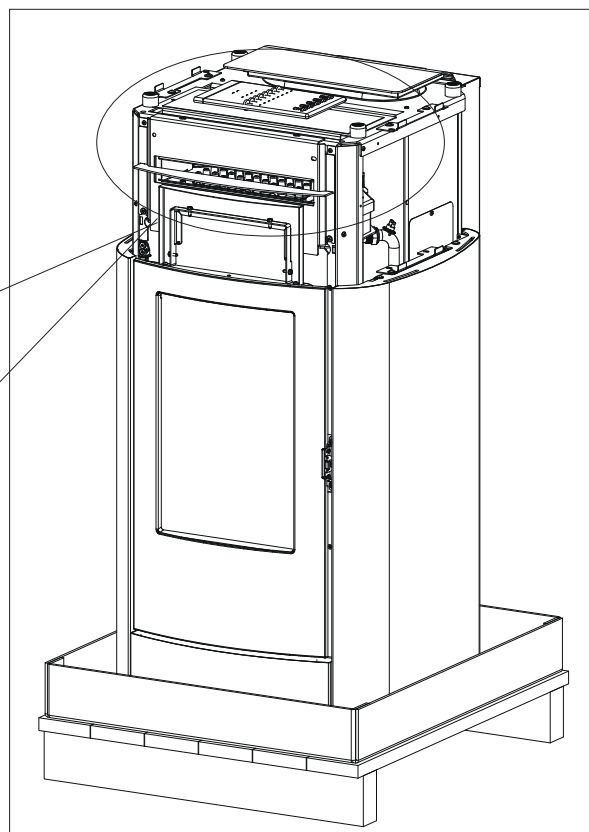
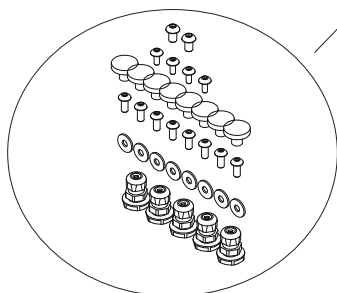
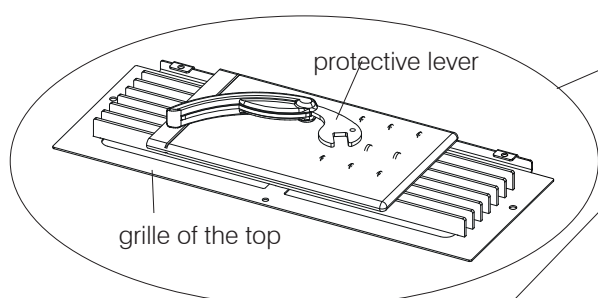

On the top of the stove there are the components described above



**TO REMOVE KIRA EVO FROM THE PALLET**

To remove the stove from the pallet you must (see figures below corresponding to instructions):

1. remove the two brackets (screwed) on the front
2. remove the two brackets (screwed) on the rear of the stove

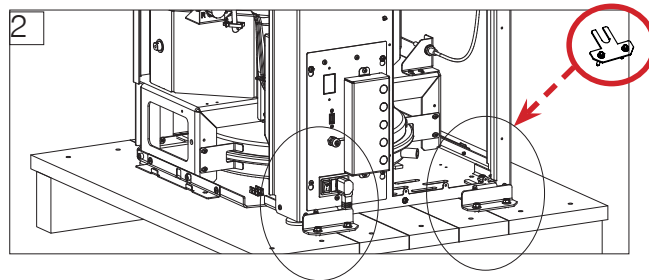
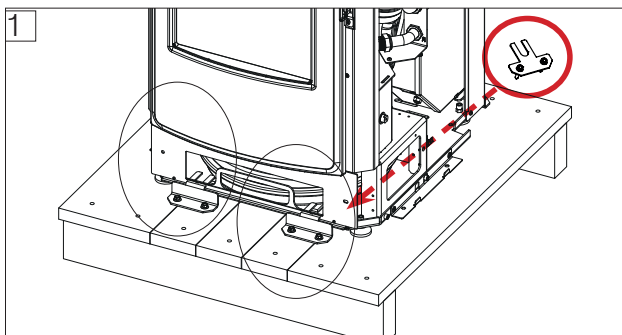
**TO REMOVE VYDA EVO FROM THE PALLET**

To remove the stove from the pallet you must (see figures below corresponding to instructions):

1. open the combustion chamber door; undo the two screws holding the bottom front panel and remove it to access the two screws which fix the product to the pallet
2. remove the two brackets (screwed) on the rear of the stove

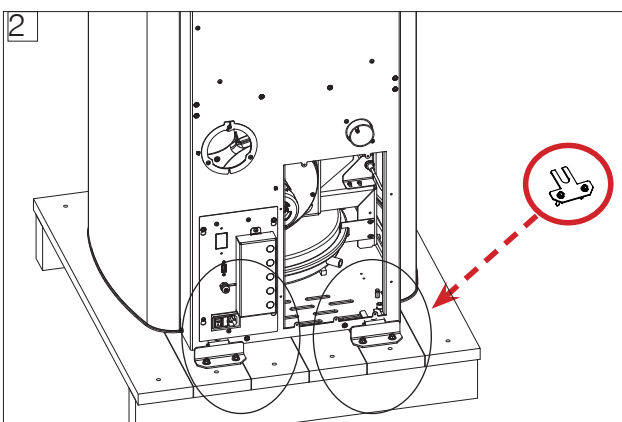
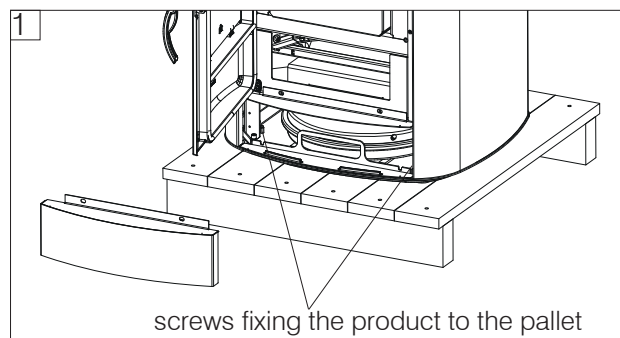
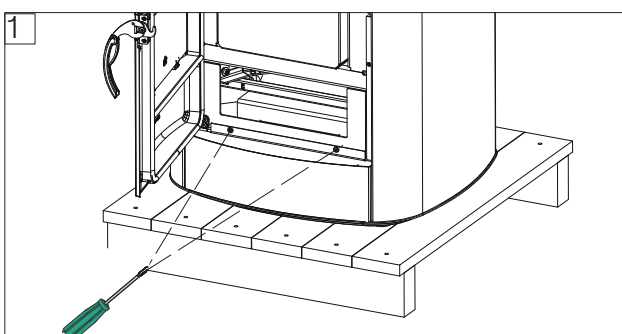

**THE DRAWINGS ARE FOR GUIDANCE ONLY,  
USEFUL FOR THE INSTALLATION, BUT THEY  
MAY NOT REFER TO THE SPECIFIC MODEL.**



DO NOT TRY TO REMOVE THE PRODUCT FROM THE PALLET WITHOUT HAVING OPENED THE COMBUSTION CHAMBER DOOR AND UNDONE THE SCREWS WHICH FIX IT TO THE PALLET

## REMARKS ON INSTALLATION

Note that:

- installation must be carried out by authorised technical personnel;
- The appliance must be installed and operated in compliance with local and national law and European regulations. The applicable Italian regulation is UNI 10683;
- If installed in a condominium, the appliance must be approved by the administrator.

We give some general instructions below, however these do not obviate the need to comply with local regulations and do not affect the installer's liability for the installation.

### Checking the suitability of the installation space

- The room must have a volume of at least 30 m<sup>3</sup>.
- The floor must be able to bear the weight of the product and its accessories.
- Level the appliance.
- The appliance may not be installed in a bedroom, bathroom or in the same room as other equipment which draws air for combustion from the room itself, or in any area with an explosive atmosphere. Any extraction fans operating in the same room or area as the product, may affect its draw.
- In Italy, check the compatibility pursuant to UNI 10683 and UNI 7129 in the presence of gas fired products.

### Protection from heat and safety clearances

The surfaces of the building adjacent to the product must be protected against overheating.

The insulation to be used will depend on the type of surface in question.

The appliance must be installed in accordance with the following safety instructions:

- minimum clearance at the sides and rear of 15 cm from flammable materials.

- no flammable materials may be kept closer to the front of the appliance than 80 cm.

If connected to a wooden or otherwise flammable wall, the flue must be insulated appropriately.

If installed on a flammable or combustible floor, or one incapable of bearing its load, use steel or glass plates under the stove to distribute the load.

Contact the retailer for such optional equipment

### Positioning the product

The product is designed to operate in all climatic conditions. In special circumstances, such as strong wind, its safety equipment may switch the appliance off.

Contact the authorised Edilkamin Technical Assistance Centre.

## FLUE SYSTEM

### (Smoke duct, flue and chimney pot)

This chapter has been drawn up pursuant to European regulations EN 13384, EN 1443, EN 1856 and EN 1457. The installer must observe both these and any other local regulations. This manual does not in any way substitute such regulations.

The product must be connected to a flue system which ensures that the smoke produced by combustion are discharged in complete safety.

Before positioning the appliance, the installer must check that the flue is suitable.

## SMOKE DUCT, FLUE

The smoke duct (which connects the combustion chamber's smoke outlet with the flue) and the flue itself must, among other regulatory requirements:

- receive the smoke from a single product (the outlets of multiple appliances cannot be conveyed into a single flue)
- be routed vertically for the most part
- have no downwards sloping sections
- preferably have a circular internal cross section, or with a ratio of the sides of less than 1.5
- terminate at roof level with a proper chimney pot: the flue may not discharge directly on the wall or into an enclosed space, even if the space in question is open to the sky
- be made of material rated in fire reaction class A1 as per UNI EN 13501 or analogous national regulations

- be certified, with a chimney plate if metal
- be of uniform cross section or vary in cross section only immediately after the outlet, not at some mid point of its length.

## THE SMOKE DUCT

Further to the general requirements for the smoke duct and flue, the smoke duct:

- may not be made of flexible metal material
- must be insulated, if routed through unheated areas or outdoors
- must not be routed through rooms where the installation of combustion heat generators is prohibited, there is risk of fire, or which cannot be inspected
- must enable the recovery of soot and be open for inspection
- have at most 3 bends with a maximum angle of 90°
- must have a single horizontal section with a length of no more than 3 metres, depending on the draw. Note, in any case, that long sections promote the accumulation of dirt and are harder to keep clean.

**THE FLUE:**

Further to the general prescriptions for the smoke duct and flue, the flue:

- must serve solely to discharge smoke
- must be correctly sized to satisfy the requirements of smoke discharge (EN 13384-1)
- should preferably be insulated, in steel with a circular internal section. If rectangular, the corners must have a radius of not less than 20 mm, with a ratio of the internal dimensions of  $<1.5$
- must normally be at least 1.5 metres in vertical length
- must have a constant cross section
- must be waterproof and thermally insulated to ensure a good draw
- must preferably have a collection chamber for non-combusted matter and any condensation.
- if pre-existing, must be clean, to prevent fire hazards
- in general, we recommend fitting a tube inside the existing masonry chimney if its diameter is greater than 150 mm.

**INTUBATED SYSTEM:**

Further to the general prescriptions for the smoke duct and flue, the intubated system:

- must operate in negative pressure
- must be open to inspection
- must observe local regulations.

**THE CHIMNEY POT**

- must be windproof
- must have an internal cross section equivalent to that of the flue and a smoke outlet at least double that of the interior of the flue
- for dual flues (which should be spaced at least 2 m apart) the chimney pot receiving the smoke from the solid fuel appliance or that from the higher storey, must be at least 50 cm higher than the other
- it must extend beyond the back flow zone (in Italy, refer to UNI 10683 point 6.5.8.)
- it must allow for maintenance of the chimney

**EXTERNAL AIR INTAKE**

In general, we suggest two ways to ensure a proper flow of combustion air.

**Indirect air intake**

Install an air outlet at floor level with an effective surface area (net of the screen or other protections) of at least 80 cm<sup>2</sup> (10 cm in diameter).

To prevent draughts, we recommend installing the air intake behind the stove or behind a radiator.

Installing it in front of the appliance will create unpleasant draughts.

**Direct air intake\***

Install an air intake with effective area (net of the mesh or other protective equipment) at least equal to that of the air intake at the rear of the product.

Connect the air intake to the appliance's air intake with a tube (which may also be flexible). Increase the diameter of the pipe if it is not smooth: assess its load loss.

A maximum length of 1 metres is recommended, without bends.

The air may be drawn from an adjacent room only if:

- the flow is taken from permanent and unobstructed openings communicating with the outdoors;
- the adjacent room is never in underpressure relative to the outdoors;
- the adjacent room is not a garage, subject to fire hazard, a bathroom or bedroom;
- the adjacent room is not a shared room in the condominium.

In Italy, UNI 10683 provides that ventilation is sufficient even if a pressure difference between the outdoors and indoors of no more than 4 PA is guaranteed (UNI EN 13384-1). The installer who issues the declaration of conformity is responsible for ensuring these conditions.

\*The direct connection of the air intake does not make the product airtight. It is therefore necessary to ensure an air recovery taken in the room by the product (i.e. for the glass cleaning)

### **Ducting of heating air**

To duct the warm air exiting the rear, you will find several optional extras at your dealer's.

#### **For Ø 6 cm ducting and with Edilkamin vents:**

- adapter from Ø 8 cm to Ø 6cm
- air duct pipe (3 metres, 6 cm diameter)
- "Y" junction for ducting pipe (6 cm diameter) to deliver the output air from an outlet hole in the stove to two rooms
- various models of ducting vents (Bent, Split, Origami, Sharp).

The instructions for connecting these vents are given in the manual provided with the vents.

#### **For Ø 8 cm ducting with Edilkamin Kit 12-12bis**

- kit 12 for ducting into an adjacent room (pipe Ø 8 cm -3 m in length, B4 terminal vent; clamp)
- kit 12bis for ducting into a distant room (pipe Ø 8 cm -6 m in length, B4 terminal vent; 2 clamps; 2 wall collars)

In the "Instructions for use" paragraph, we describe the fan settings and air directions.

## CHECKING THE ELECTRICAL CONNECTIONS (the power socket must be located in an easy to access position)

The stove is equipped with an electrical power cord or connection to a 230V 50 Hz socket, preferably with electromagnetic switch.

Variations in voltage of more than 10% can compromise the operation of the stove.

The electrical system must be compliant; check the operation of the earth in particular.

Edilkamin is not responsible for malfunctions resulting from an improperly earthed system.

The power line must be of adequate section for the power of the appliance.

The power cable must not come into contact with the flue or other hot parts of the stove.

Power up the stove by setting its switch from 0 to 1.

There is one 4 A fuse on the socket with switch located at the rear of the stove.

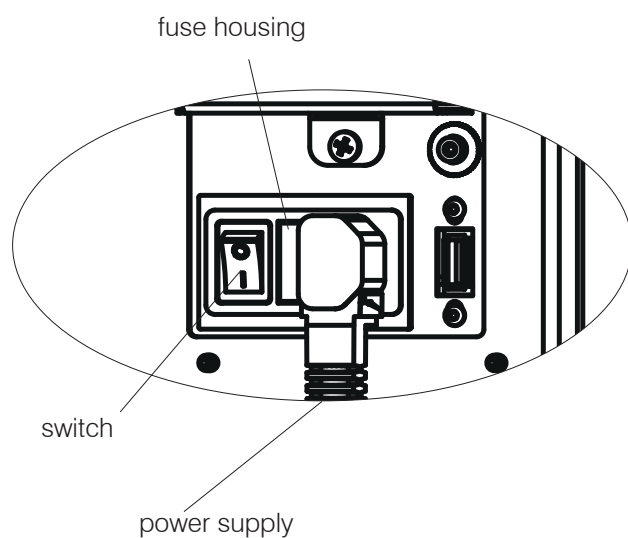

Description	Reference in Figures below	Quantity
Bottom front panel	(1)	n°1
Top front panel	(2)	n°1
Top right ceramic side	(3)	n°1
Lower right ceramic side	(4)	n°1
Lower left ceramic side	(5)	n°1
Top left ceramic side	(6)	n°1
Ceramic top	(7)	n°1

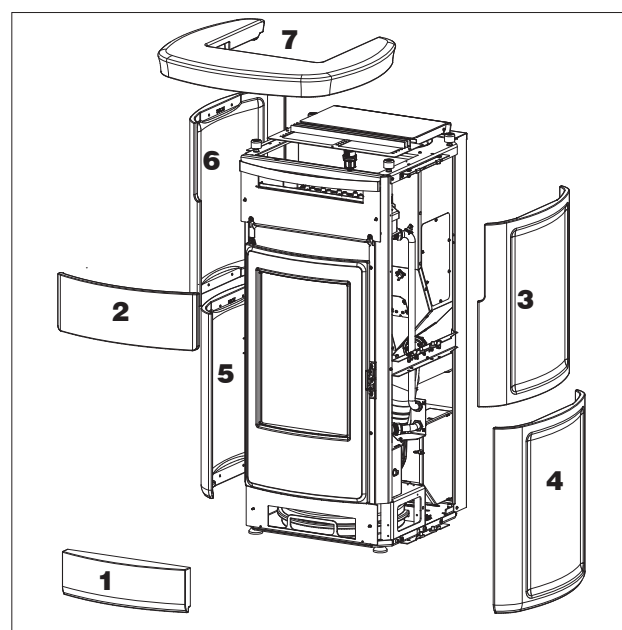
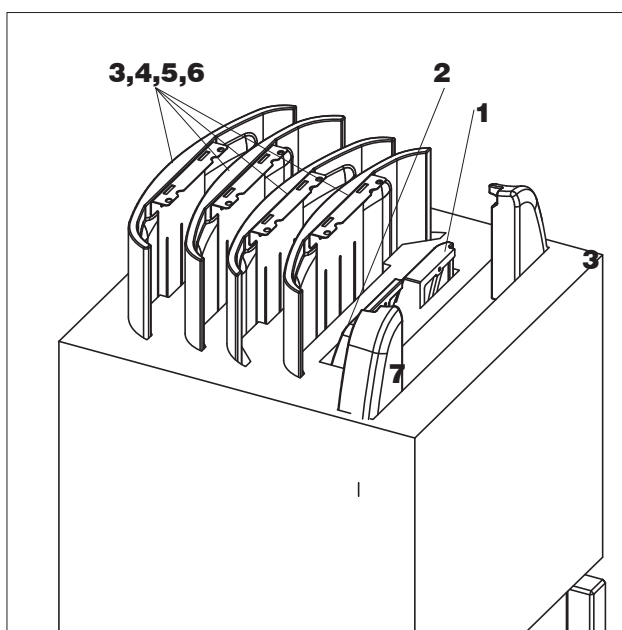

The position of each ceramic side is indicated on the interior part of each piece (example INF.DX means bottom right.)

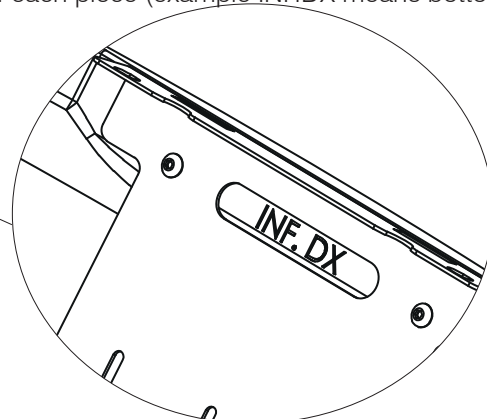
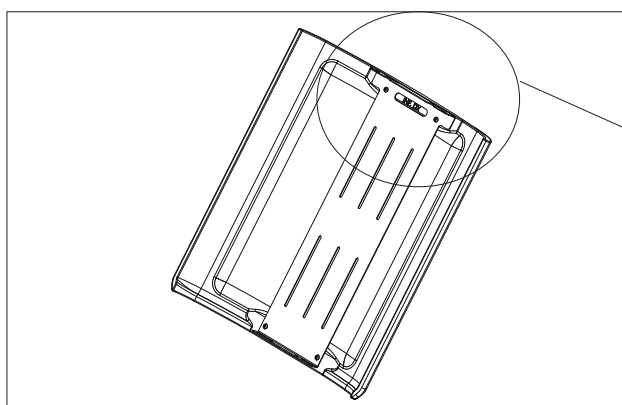

The metal grille of the top is in the package of the stove structure together with the M4 screws, fixing washers and the two rubber buffers to be applied on top of the grille

\* Small parts to be used for KIRA EVO :

- M4 screws with washers for fitting the ceramic front parts
- M5 screws and washers for fitting the ceramic sides
- cable glands for the terminal board on the rear

**THE DRAWINGS ARE FOR GUIDANCE ONLY, USEFUL FOR THE INSTALLATION, BUT THEY MAY NOT REFER TO THE SPECIFIC MODEL.**

**Fitting of the bottom front panel (1)**

**THE DRAWINGS ARE FOR GUIDANCE ONLY,  
USEFUL FOR THE INSTALLATION, BUT THEY  
MAY NOT REFER TO THE SPECIFIC MODEL.**

1. Open the combustion chamber door with the protective lever (removable handle P) and undo two screws to remove the bottom metal front panel

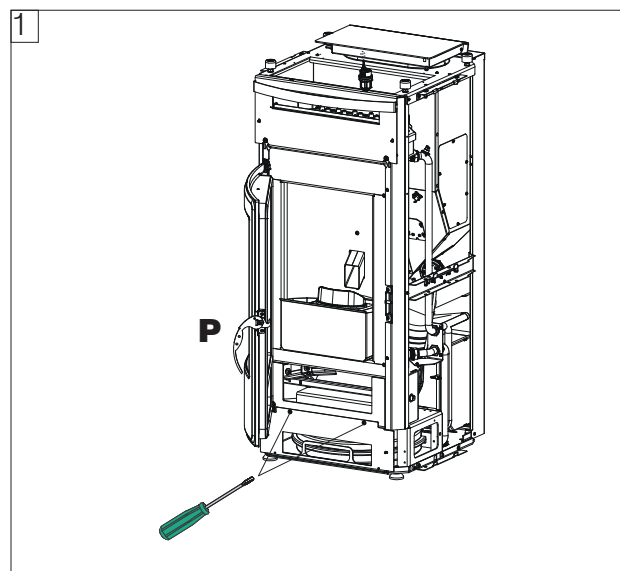

2. Fit the ceramic part on the bottom metal front panel using the M4 screws with washers

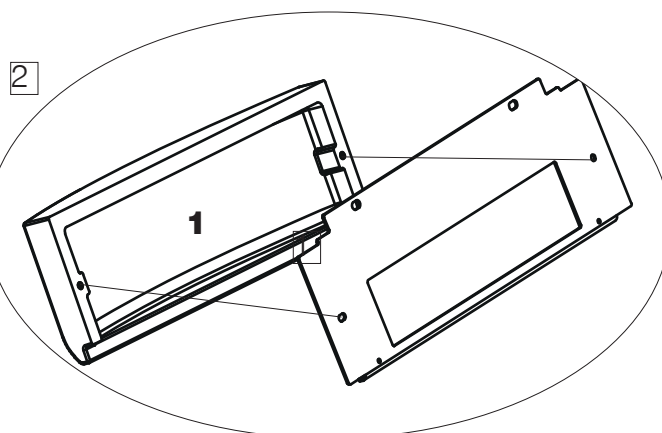

Do not force the screw into the pin, it may break

3. Screw the bottom metal front panel - **1** (with the bottom ceramic front panel already fitted) to the stove. You can adjust the position of the front panel horizontally to align it to the door, by moving the screws in the slots

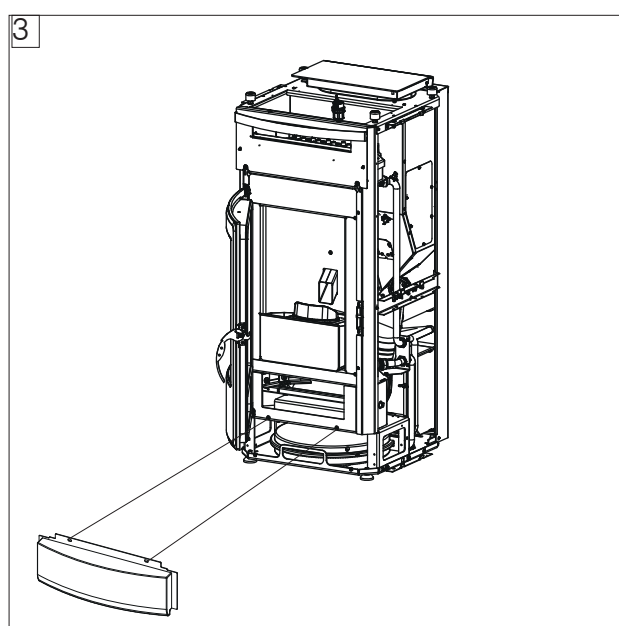
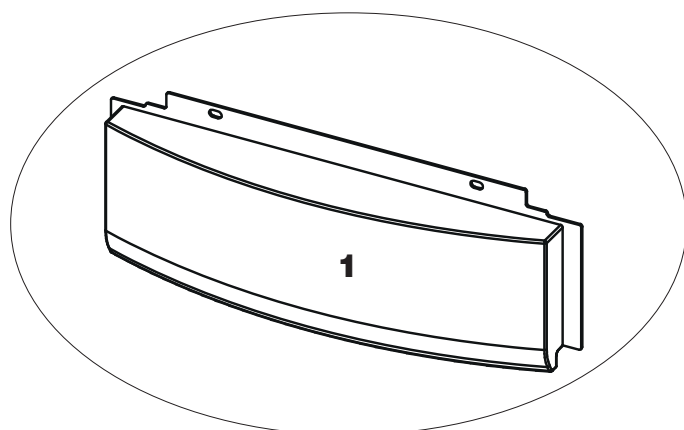



**Fitting of the top front panel (2)**

1. Undo the two upper screws.

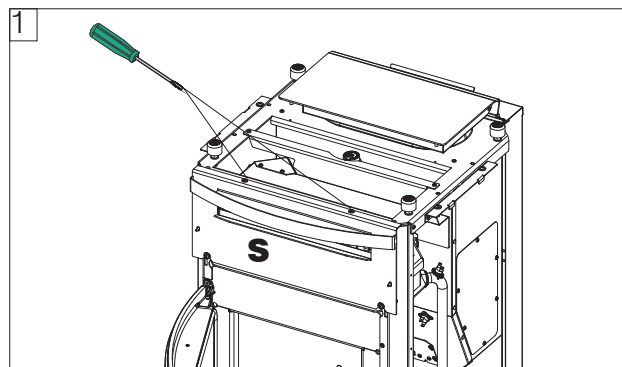

2. Remove the metal support (S).

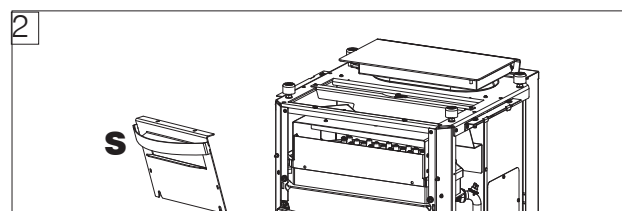

3. Place the top ceramic front panel (2) on the metal support (S).

Fit the front panel (2) with the M4 screws provided with washers

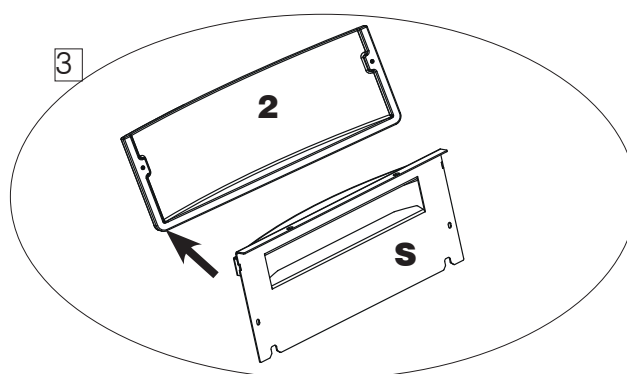

4. Replace the support with the ceramic part and screw it back to the structure by using the two screws removed in point 1

Close the combustion chamber door and check the alignments.

To make alignment adjustments between ceramic/ stone and the door, you can use the top screws. Left/right adjustments can be made.

**Fitting the ceramic sides (3,4,5,6)**

The sides are hooked and screwed on top  
Start from the bottom ceramic part of one of the two sides.

1. Place the rubber buffers and hook the bottom side ceramic part to the structure.

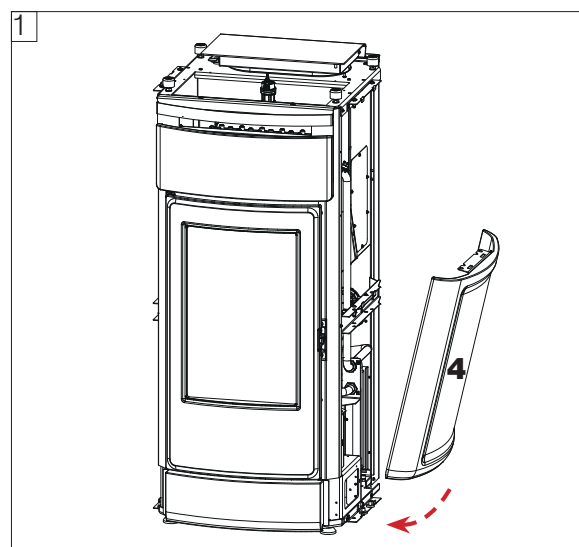
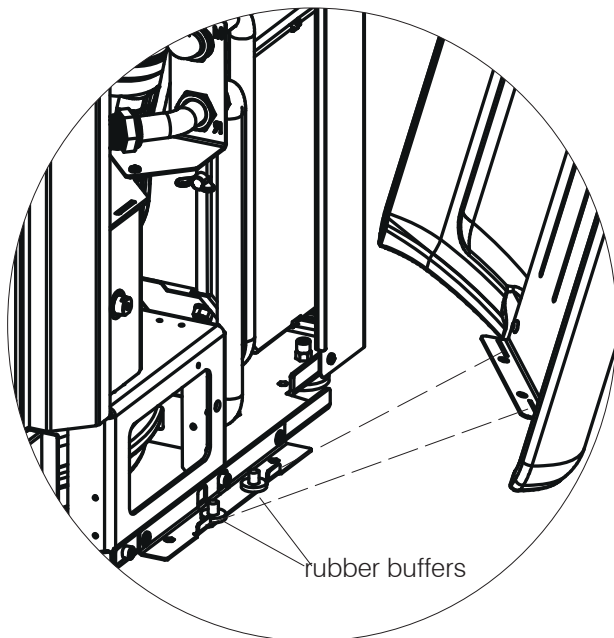

There are some other screws on the brackets that you can use for any adjustment

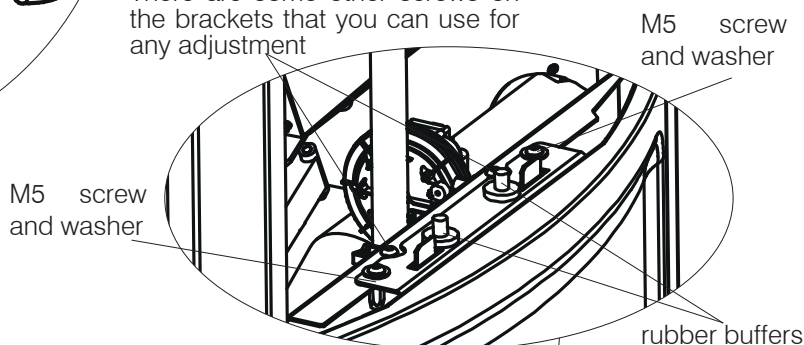

2. Screw on the sides from above with the M5 screws and the washers provided

To make alignment adjustments between ceramic/stone and the door, you can move the top or bottom screws in their slots.

The top screws allow the alignment with the top.

The bottom screws allow the alignment with the front panel and with the bottom side panel. If the ceramic or stone side is not aligned, remove it, adjust the screws and put it back.

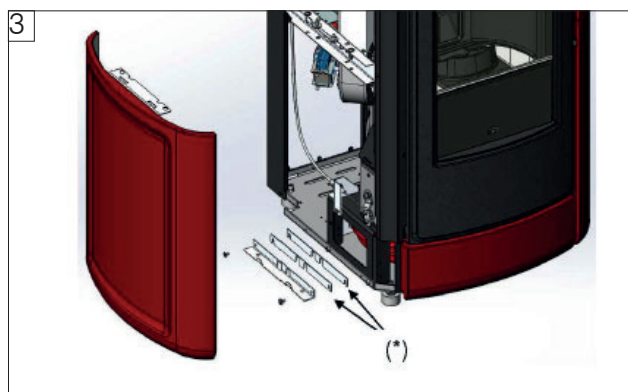
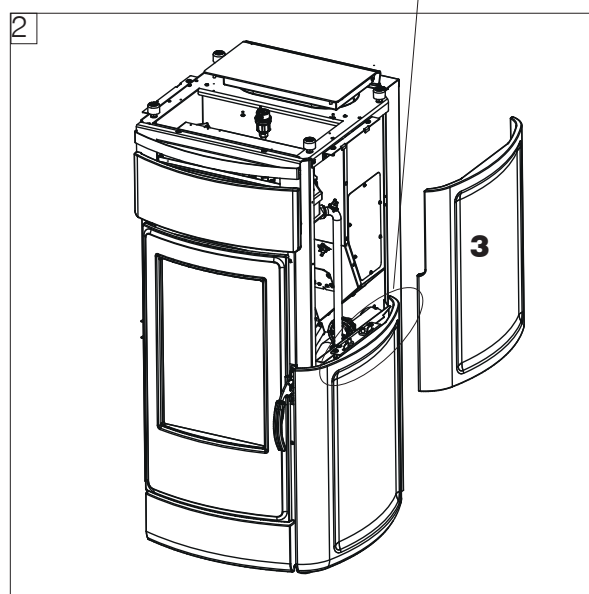

Take care that the side ceramic tile does not knock against the metal side when opening the door. If necessary adjust the setting to avoid breakage  
Please use 1(\*) - 2(\*) components if you need (image 3)

**Fitting the ceramic top (7)**

The top part of the lining consists of a grille (G) for the hot air output and the stone or ceramic top (4).

1. Fit the two rubber buffers provided on the top part of the grille. They can also be fitted after the grille has been matched with the top

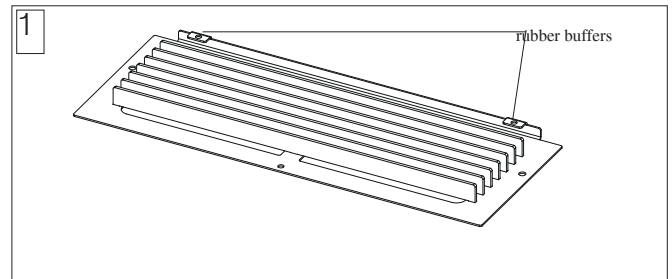

2. Place the grille under the ceramic or stone part and fit it with the M4 screws provided

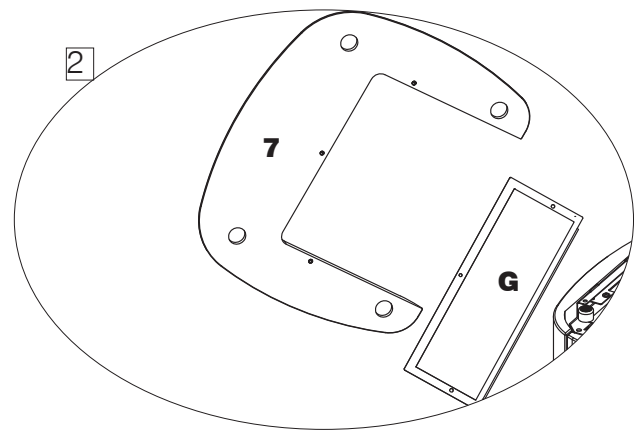

3. Open the lid of the pellet tank, place the grille and ceramic top (after screwing them together) onto the stove

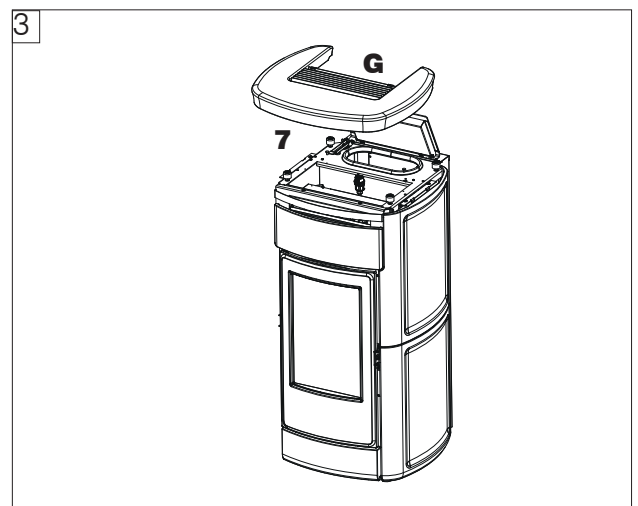

Adjustments can be made by adjusting the feet supporting the top, or the screws under the sides, as shown in the fitting of the sides (with top and side removed)

Description	Reference in the Figure below	Quantity
Front panel above the door (ceramic or stone)	<b>(1)</b>	1
Top front panel (ceramic or stone)	<b>(2)</b>	1
Left or right interchangeable sides (ceramic or stone)	<b>(3)</b>	2
Top (ceramic or stone)	<b>(4)</b>	1

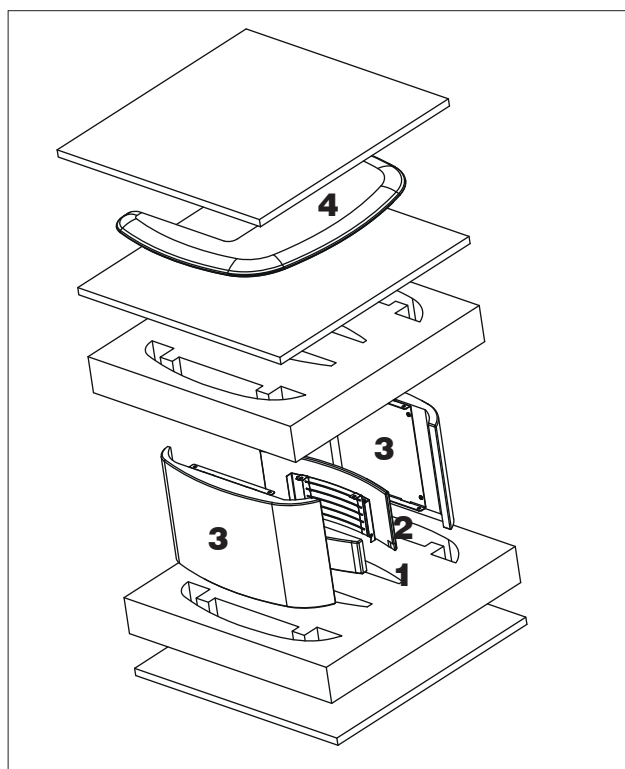

**THE DRAWINGS ARE FOR GUIDANCE ONLY, USEFUL FOR THE INSTALLATION, BUT THEY MAY NOT REFER TO THE SPECIFIC MODEL.**

The metal grille of the top is in the stove structure package together with the M4 screws (and M6 for the stone top), the fitting washers and the two rubber buffers

\* Small parts to be used for VYDA EVO :

- M4 screws with washers for fixing the ceramic parts
- M6 screws for fixing the stone parts
- cable glands for the terminal board on the rear

# **Fitting of the stone or ceramic front panel above the door (1)**

**THE DRAWINGS ARE FOR GUIDANCE ONLY, USEFUL FOR THE INSTALLATION, BUT THEY MAY NOT REFER TO THE SPECIFIC MODEL.**

1. Open the combustion chamber door with the protective lever (removable handle P) and undo two screws to remove "aesthetic cover".

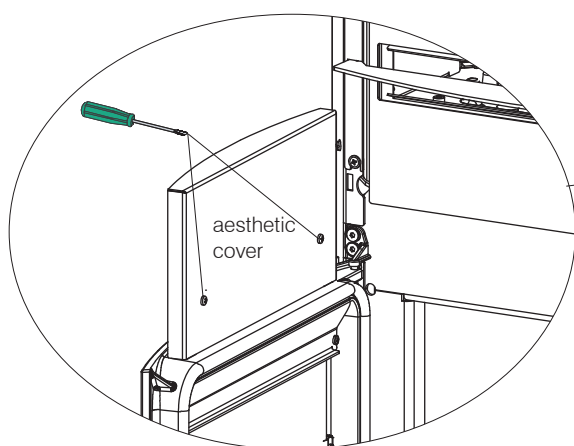

2. Unscrew the two upper screws, insert the ceramic or stone front panel (1) in the metal support above the door.

It is snapped into position on the side parts and screwed on the top part.

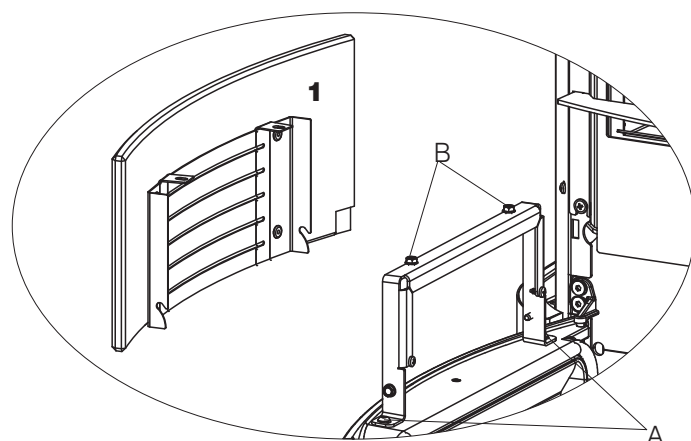

To make alignment adjustments between ceramic/stone and the door, you can use the screws A and B  
Screw A can be used to adjust "backwards/forwards"  
Screw B can be used to adjust the inclination

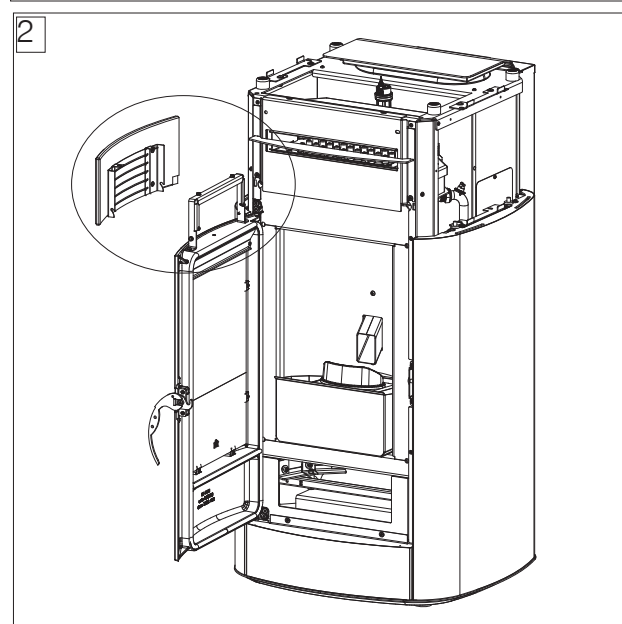
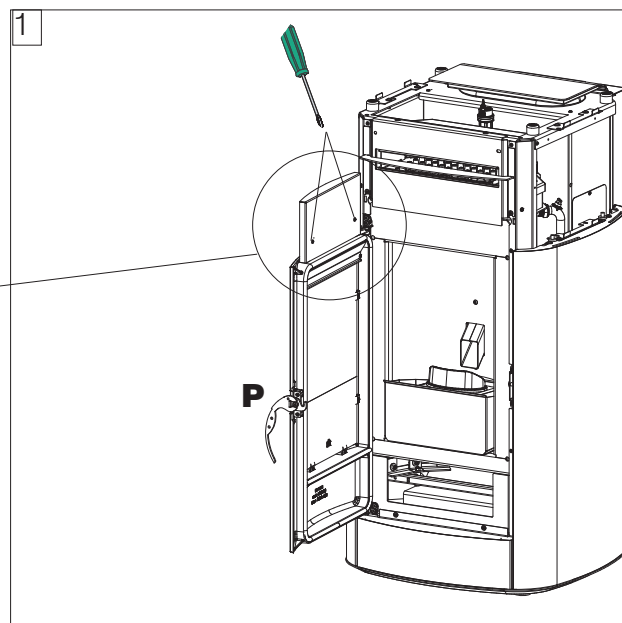

3. Refit the "aesthetic cover"

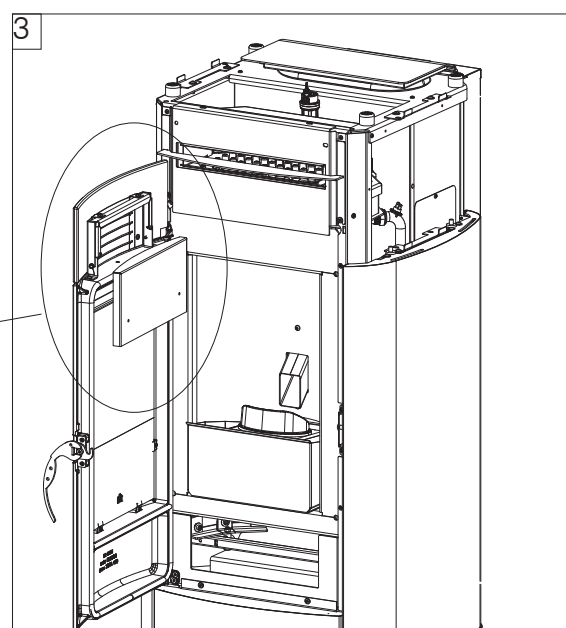
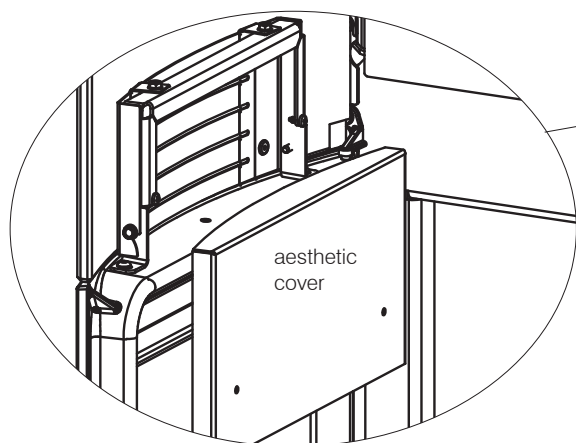

4. Screw it back with the two screws removed in point 1

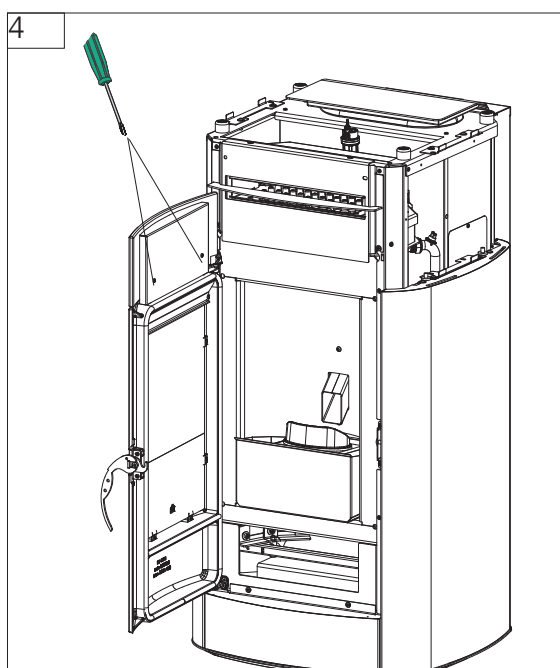

## Fitting of the stone or ceramic top front panel (2)

1. undo the two upper screws

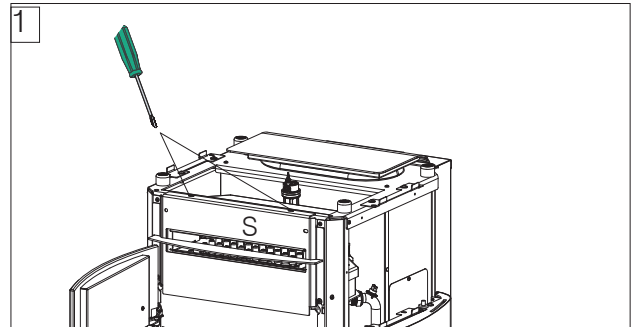

2. remove the metal support (S)

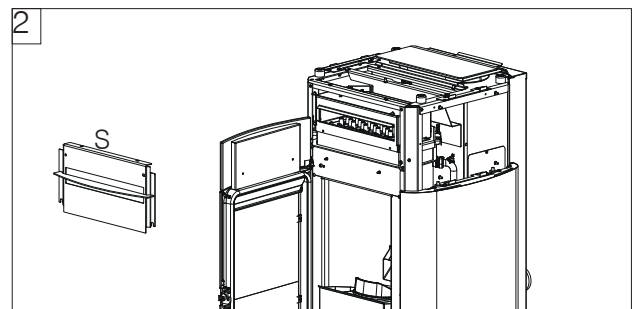

3. Place the top ceramic or stone front panel (2) on the metal support (S).

Fit the front panel (2) with the screws provided:

M4 with washers for the ceramic front panel;

M6 for the stone front panel.

Adjustments can be made by using the screws behind the front panel (S).



Do not force the screw into the pin, it may break

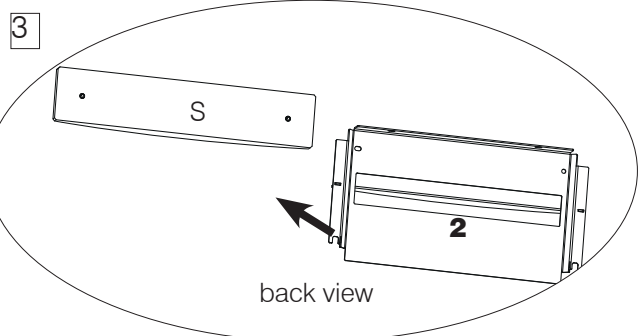

4. Replace the support with the ceramic part and screw it back to the structure by using the two screws removed in point 1.

Close the combustion chamber door and check the alignments.

To make alignment adjustments between ceramic/stone and the door, you can use the top screws. Left/right adjustments can be made.

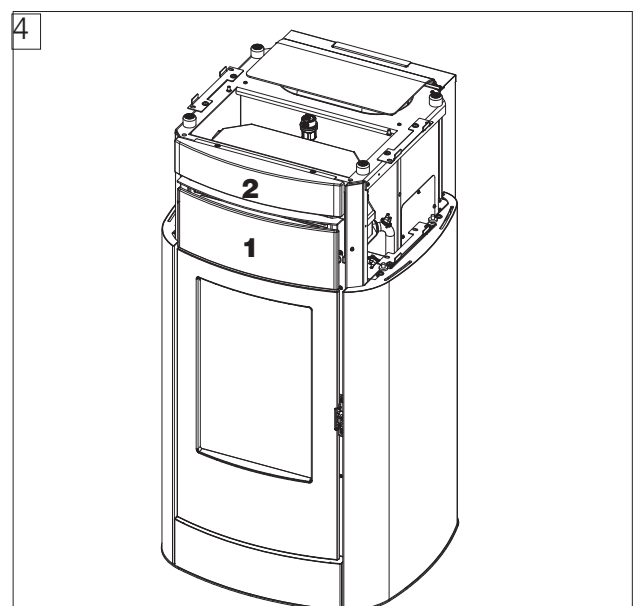

## Fitting of the stone or ceramic sides (3)

The sides (3) are only hooked on.

1. Place the rubber buffers and hook the sides to the structure

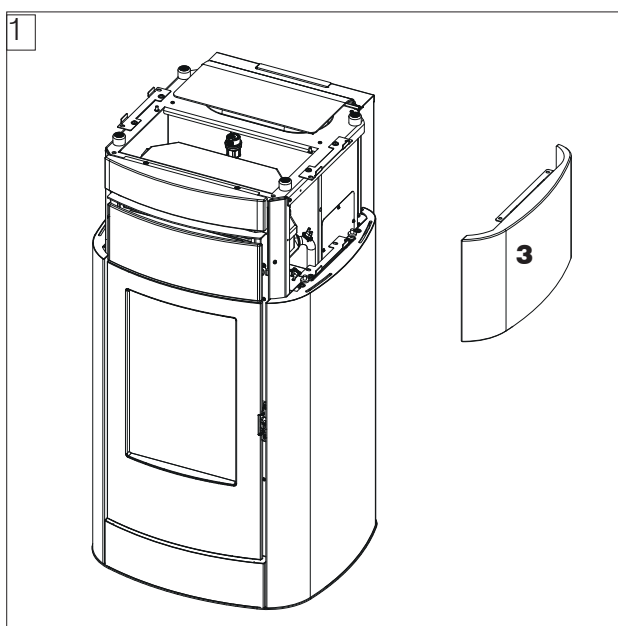
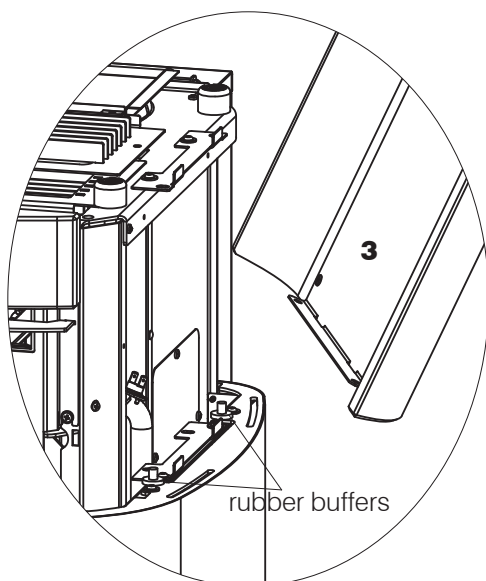

Note: see the diagram for correct installation of the ceramic tile

To make alignment adjustments between ceramic/stone and the door, you can move the top or bottom screws of the bracket fixed to the structure.

The top screws in their slots allow the alignment with the top.

The bottom screws in their slots allow the alignment with the front panel and with the bottom side one.

If the ceramic or stone side is not aligned, remove it, adjust the screws and put it back.



### Fitting of the stone or ceramic top (4)

The top part of the lining consists of a grille (G) for the hot air output and the stone or ceramic top (4).

1. Fit the two rubber buffers provided on the top part of the grille. They can also be fitted after the grille has been matched with the top.

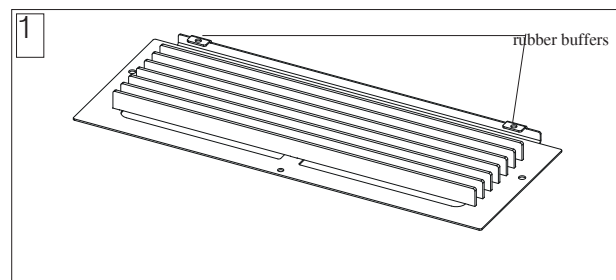

2. Place the grille under the ceramic or stone part and screw it (M6 screws for stone and M4 screws for ceramic).

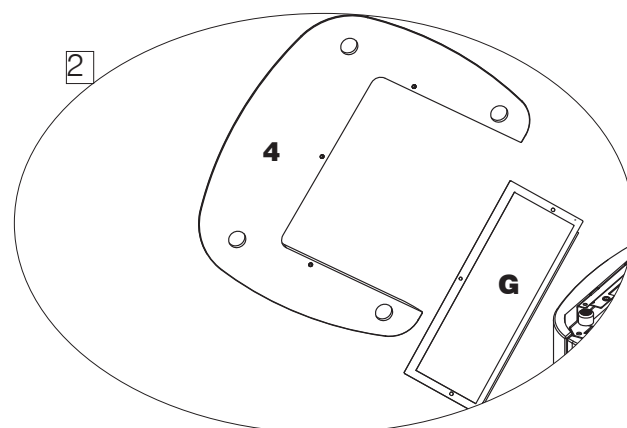

3. Open the lid of the pellet tank, place the grille and ceramic top (after screwing them together) onto the stove.

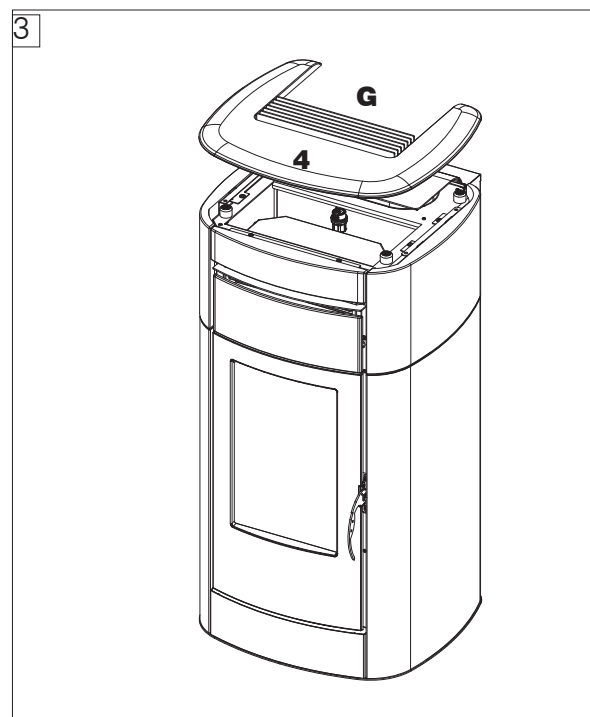

Adjustments can be made by adjusting the feet supporting the top, or the screws under the sides, as shown in the fitting of the sides (with top and side removed).

## FIRST IGNITION (COMMISSIONING)

### PHASES

- Make sure you have read and understood this manual.
- Remove all flammable materials from the appliance (manuals, labels, etc.). In particular remove any labels from the glass.
- Make sure that the technician performs the first ignition and the first loading of the pellet tank. Refer to the "Various Menus" chapter, paragraph



On first ignition, there may be a slight smell of paint, which will disappear in a short time.

### FUEL

Use UNI EN ISO 17225-2 category A1 wood pellets or similar regulatory products with the following characteristics.

diameter 6 mm

length 3-4 cm

humidity <10 %

For reasons of safety and environmental compatibility, DO NOT burn plastic, painted wood, coal, bark or other such materials in the stove.

Do not use the stove as an incinerator.



Caution

Using fuels other than those specified can damage the appliance

## LOADING THE PELLETS INTO THE TANK.

To access the tank, open the lid.



When the stove is hot, DO NOT MAKE CONTACT between the pellet bag and the top grille.

Use the gloves when loading the stove while it is operating and hence hot to the touch.

Make sure not to touch the smoke discharge pipe if hot.

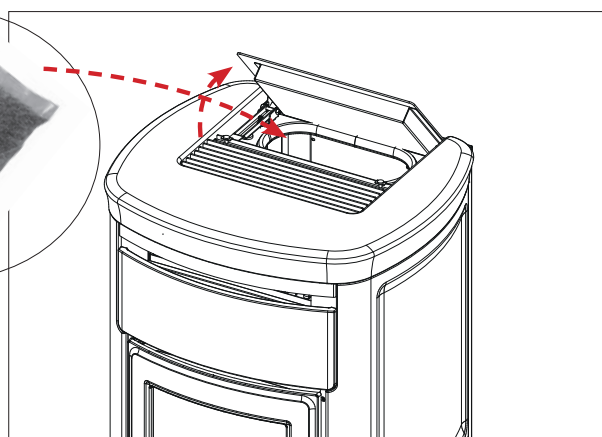
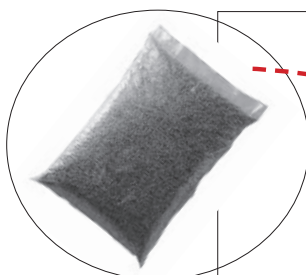
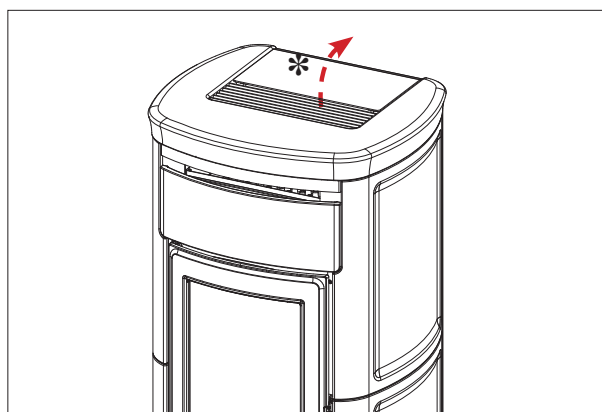

To close the lid of KIRA EVO, unhook the hook as shown in the figure below.

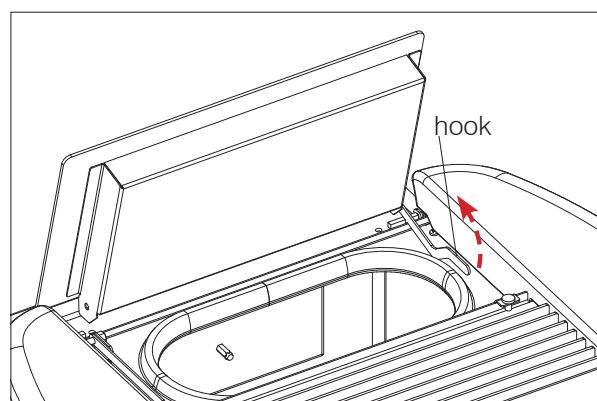

## OPERATION

Mode	Size settings
MANUAL	<ul style="list-style-type: none"> <li>power level</li> <li>ventilation level (the three fans can be adjusted separately) *</li> </ul>
AUTOMATIC	<ul style="list-style-type: none"> <li>desired room temperature</li> <li>ventilation level *</li> </ul>
CRONO	<ul style="list-style-type: none"> <li>desired room temperature, selected per day of the week</li> <li>ventilation level*</li> </ul>

\* when lowering the ventilation the stove also automatically modulates its power to maintain maximum efficiency.

The stove also has the following supplementary functions.

Function	In which mode it can be activated	What it does
STAND BY	automatic crono	when the desired temperature is reached, the stove shuts off and turns on again when the temperature drops
RELAX	manual automatic crono	enables natural convection mode (fan off), thus reducing the power
NIGHT	manual automatic	allows you to set the stove to go out after a given number of hours

## OPTIONAL CONNECTIONS

The technician can supply, on request:

- external thermostat;
- telephone dialler;
- probes/thermostats for managing the ducting fans (if present on the purchased model)

## SIMPLIFIED IGNITION BUTTON ON THE REAR OF THE STOVE

The user interface is the remote control but, if this is not available, you can control the stove with the button on the back (see figure)

### 1. WITH THE STOVE OFF

press the button for 2" to turn the stove on.

### 2. WITH THE STOVE ON

press the button for 2" to turn the stove off.

### 3. WITH THE STOVE ON IN MANUAL MODE

by pressing the button once and releasing it immediately, you can increase the operating power.

**REMOTE CONTROL**

The remote control has specific functions for three distinct figures:

- user of the product (operations not protected by password)
- installer (operations with dedicated password because any errors can jeopardise the product's operations and SECURITY)
- Edilkamin technical assistance centre (operations with dedicated password because any errors can jeopardise the product's operations and SECURITY)

**Characteristics:** Module for RF transmission and reception with 2.4 GHz frequency - Recommended power supply 3 x AA slimline 1.5 VDC batteries (with at least 1600 mAh capacity).



Risk of explosion if the batteries are replaced with other batteries of an incorrect type.

**If at the first switch-on operation** the language is not set, the adjacent language selection screen will appear. Choose the language with the +/- buttons and confirm with OK.

### REMOTE CONTROL POWER SAVING

After 20" of non-use the backlighting decreases and after a further 10" the display switches off.

If any button is pressed with the display on, the counter resets.

If any button is pressed with the display off, the display and the backlighting will switch on and the counter will reset. This only refers to the remote control, not the product itself.

In normal use, the remote control's batteries should last a year. This duration is for illustrative purposes only. Edilkamin and the reseller will not consider claims for battery life under any circumstances.





Bluetooth communication present between the stove and the circuit board. If there is no communication, the symbol disappears.



Wi-Fi communication of the product towards the router. If there is no communication, the symbol disappears.



On only if the battery is running out. The power level supplied by the batteries is near the limit for powering the remote control.



Maintenance necessary symbol.  
Appears after a certain number of hours of operation.



The relative function is active (Relax – airKare – EasyTimer – Crono).

**EasyTimer and Crono cannot be activated simultaneously.**



°C/F. Indicates the unit of measurement of the displayed temperature: degrees centigrade (°C) or Fahrenheit.



Reserve indicator It switches on if the function is active. The arrows switch on in sequence to signal that the tank must be filled.



Presence of flame and stove power

SWITCH-ON

POWER 1

POWER 2

POWER 3

POWER 4

POWER 5





Visualisation of the status of the fan(s).  
If the activation fume temperature has not been reached, it will not display any symbol.

- SPEED OFF
- SPEED 1
- SPEED 2
- SPEED 3
- SPEED 4
- SPEED 5
- AUTOMATIC



The stand-by function (where present and active) has caused the product to switch off.  
It does NOT indicate that the function is enabled.



Automatic or Manual mode: the product's air power depends on the room temperature or is set by the user.



Setting. Indicates that the remote control is in the setting mode.  
The settable value will appear in the bottom bar.



Digits for SET-POINTS. Setting of the various SET-POINTS: temperature, power, fan speed.  
Number of the parameter in the parameter setting section.

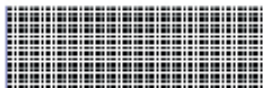

Bottom bar for weekly scheduling and messages.

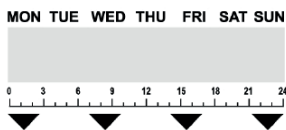

The days of the week and time bar will only appear if the timer (Crono) is activated.

**POSSIBLE STATUSES** of the product**- OFF STATE**

The product is “deactivated” and will not produce heat due to manual switching off using the ON/OFF button on the remote control or due to an external contact (timer, telephone dialler).

From the OFF page, press the ON/OFF button for 3 seconds to access the ON page.

**- ON STATUS**

The product is “active” and can fulfil the heating requests.

**- ALARM STATUS**

In case of a stoppage due to an alarm.

**- ON STATUS Stand-by activated**

The product is momentarily off because there are no heating requests.



# POWER ON/POWER OFF

These operations will take a few minutes, during which the flame must appear or switch off. Simply wait without taking any action.

The ON/OFF button is used to manually start the on or off phase.

## During the switch-on,

the display will show the status (CLEANING; SWITCH-ON; etc.)

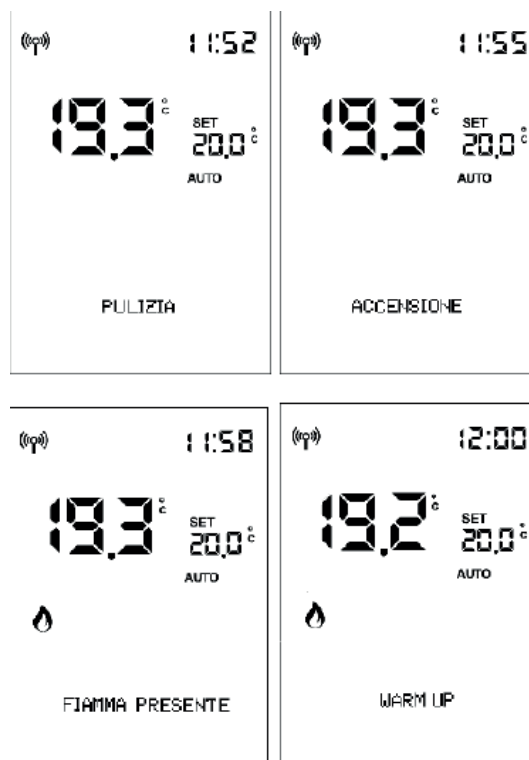

**During the switch-off,** the display will show the word "OFF".



**If time scheduling is active,** the status bar will alternately show (3 seconds) the status and the programming:

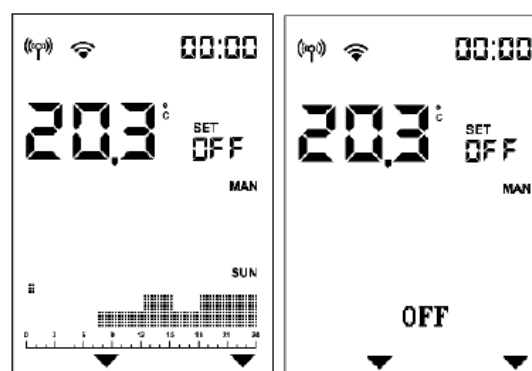

## AUTOMATIC and MANUAL setting

Press the AUTO/MAN button for a few seconds to switch from manual to automatic mode or vice versa.

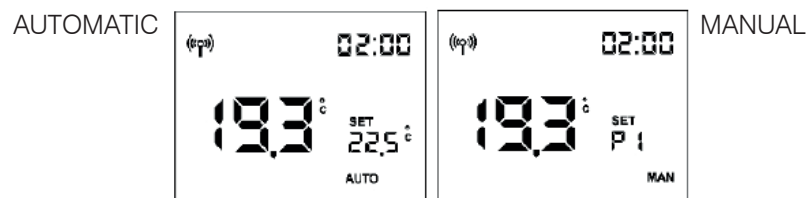

### In AUTOMATIC mode:

**Setting of the room temperature** (read by the remote control, which should be located in the room where the product is installed). Modify the desired temperature using the “+” and “-” buttons.

For example: press any button and the display will activate, then press the button 

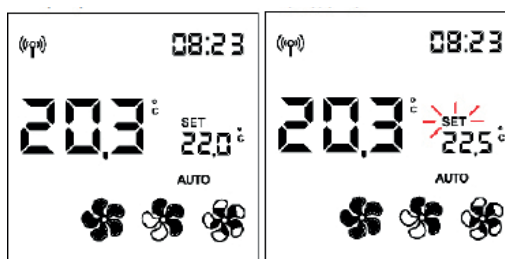

### In MANUAL mode:

#### Setting of the power

Modify the power level (displayed by the flame symbol) using the “+” and “-” buttons.

For example: press any button and the display will activate, then press the button 

“flame”  
symbol

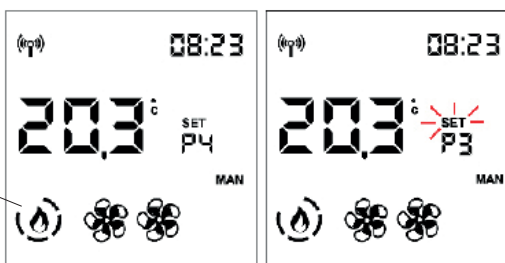

The setting can be confirmed with the  button or by waiting 5" without pressing any button.  
After confirming, SET will stop flashing.



#### NOTE

With Timer and product “off », it is not possible any regulation (power nor temperature)

## - FAN ADJUSTMENT

The setting can be made with the stove turned OFF or ON.

If the backlight is switched off, it can be activated by pressing any button.

Pressing the  or  button will make SET flash and, instead of the room set-point, the number of the fan being modified will appear (F1). Simultaneously, the fan speed can be increased or decreased in the following sequence:  
 AUTO - 1 - 2 - 3 - 4 - 5 for the front fan (1)  
 OFF - AUTO - 1 - 2 - 3 - 4 - 5 for the ducted fans (2 and 3)

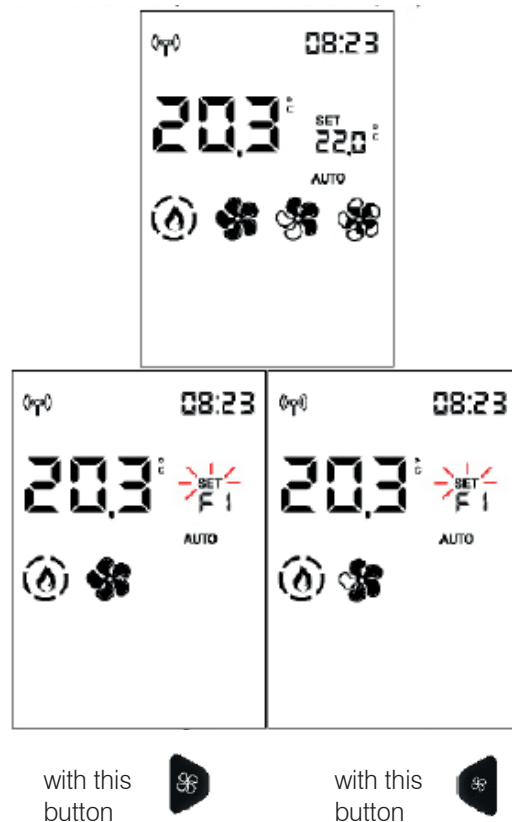

The ventilation is adjusted in sequence for the various fans (if present). If the product is not ducted, only one fan will be present (F1).

The fan speed can be increased or decreased in the following sequence:

AUTO – 1 – 2 – 3 – 4 – 5 for the front fan (1)

OFF – AUTO – 1 – 2 – 3 – 4 – 5 for the ducted fans (2 and 3)

**for PLUS versions**

Pressing the  button to confirm will take you to the next fan (Fan 2), if present.



Pressing the  or  button modifies the fan speed.

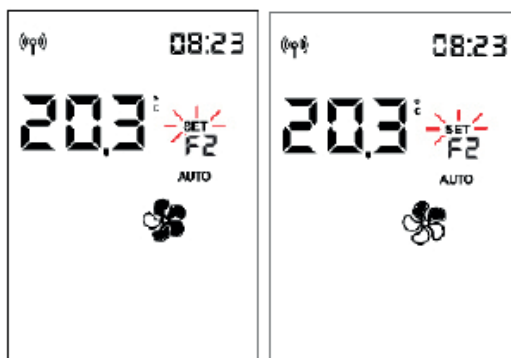

You can confirm the setting with the  button and then move to the next fan, if present, otherwise you can exit the fan setting page and "SET" will stop flashing.

Otherwise, wait 5" without pressing any button to exit the fan setting, and SET will stop flashing, even if there are other fans.

Pressing the  button to confirm will take you to the next fan (Fan 3), if present.

Waiting 5" without pressing any button takes you back to the home page with the modified SET.



**for PLUS versions with optional room probe**

**DUCTED ZONES 2 AND 3 ROOM SET-POINT**

The setting can only be made with ducted-air stoves.

If two or more optional room probes are connected and activated, it is possible to set the relative room set-point and display the room temperature.

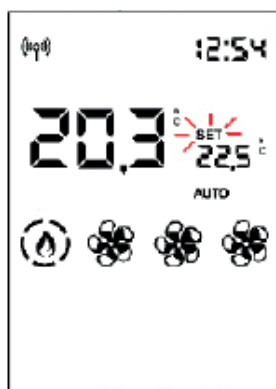

After setting the installation room temperature (or with the room power in manual mode), wait 5" without pressing any button and "SET" will flash then you will exit the settings page.

Otherwise, if you confirm with the  OK button, you can set the room set-point of zone 2 (if the probe is present and active) indicated on the bottom bar.



Press OK to move to the next zone (zone 3), if present, or exit.

## - RELAX FUNCTION

Natural convection function (without ventilation) with automatic power limiting.

This function is available in all modes: automatic, manual and timer-based.

Press and hold the  button to activate the Relax function.

Its activation on the display will be signalled by the arrow relative to the Relax button.

Prolonged pressing of the button  will deactivate the function.

The product reduces its power output and after a few minutes switches the fan off too.



## • AIRKARE FUNCTION

This function is available as a standard feature on certain models and as an optional feature on other models: check which model you have.

The function, if available, can be activated with the stove either on or off, in any mode (except in alarm mode).

The airKare can be activated by pressing the dedicated button



Its activation on the display will be signalled by the arrow relative to the airKare button.



## - EASY TIMER (deferred switching on/off)

This function switches the product on/off after a set period from activation of the function.

This is convenient if you go to bed and want the product to switch on/off after a few hours (maximum 12 hours).

The Easy Timer function can be activated by pressing the dedicated button.



By activating the Easy Timer function with the product on, the switch-off time can be set with ½ hour intervals.

By activating the Easy Timer function with the product off, the user sets the switch-on time.

Pressing the OK button or after 5" without pressing any button, the countdown will start with 5-minute intervals.

Example: Switch-off in 30 minutes' time.



The bar will continue Countdown can be read until the product switches on or off.

The Easy Timer function can be deactivated by pressing the dedicated button

The display will show an arrow above the button and the countdown.

To change the timer before the switching on or off, it must be deactivated and then reset.



## **TIMER**

Timer regulation is possible by MENU

If the product is in automatic mode, the product works at room temperature otherwise it works with the power.

Pressing the  button allows for switching from Temperature Timer to Power Timer and vice versa.

Pressing the  button activates or deactivates the timer (pre-programmed from the app or remote control).

### **NOTE**

Timer regulation is possible by MENU. « Crono » key is only used to turn off/on Crono

## - MENU

It can be accessed by pressing the  button and the first Menu item will appear.

The menu items can be scrolled with the  and  buttons and the item can be entered with the  button.

The menu items appear in the following order:

- 01 STAND-BY
- 02 PELLET LOAD
- 03 CHRONO PROG. (TIMER)
- 04 T1-T2
- 05 DATE-HOUR (TIME)
- 06 C/F
- 07 LANGUAGE
- 08 DISPLAY
- 09 INFO
- 10 SOFTWARE
- 11 DATA
- 12 ALARMS
- 13 AUGER MOT. ON-OFF (SCREW FEEDER)
- 14 PLT LVL SENS (PELLET LEVEL SENSOR)
- 15 TECHNICAL MENU

The set-point digits contain the progressive number of the menu item, while the status bar includes the description of the menu item in large letters.

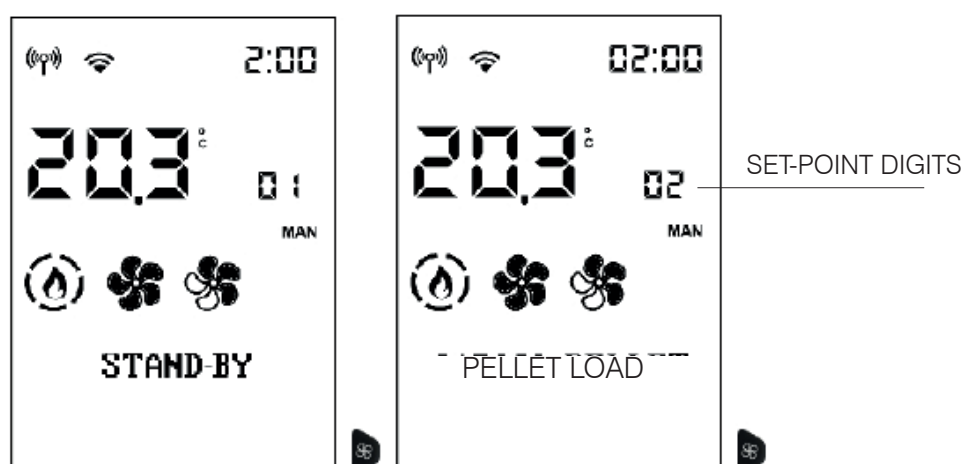

To exit the menu, press .

## - STAND-BY

When the Stand-by function is active, in the automatic and timer modes, the product switches off once the temperature set-point is reached and turns on again when the room temperature drops below the chosen value.



When the Stand-by function is not active, the product sets itself to minimum power when the temperature set-point is reached.

To access the function from the main menu (as indicated in the Menu section above), press the MENU button.

The menu items can be scrolled with the  and  buttons and the item can be entered with the  button.

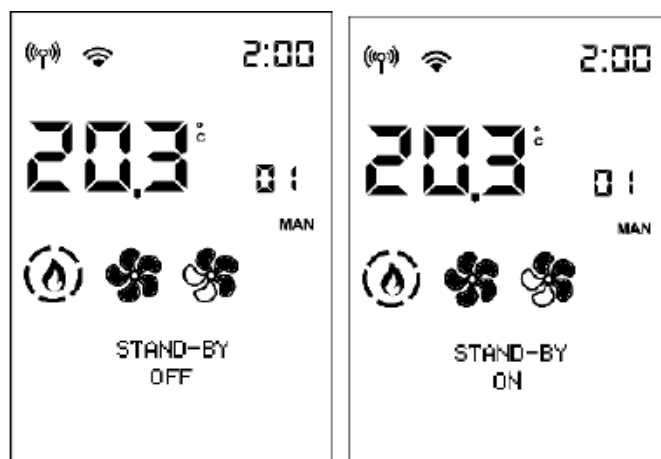
After entering the Stand-by function, the display will show the name of the function on the first line of the status bar and the current value on the second line (OFF if deactivated, ON if active).



The  and  buttons can be used to modify the value from Off (function deactivated) to On (activated) and the  button can be used to confirm.

Pressing the  button with the value ON activates the function and the display will propose to choose how many minutes must pass before the devices switches off in stand-by mode.  
(es: 5 minutes)

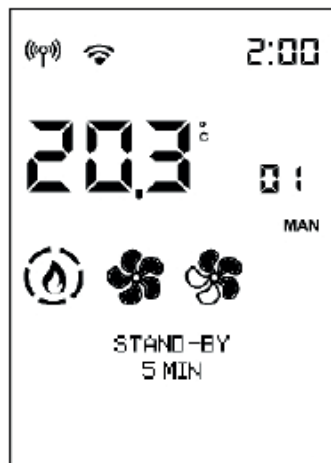

The  and  buttons can be used to modify the time and the  button to confirm.

Pressing the  button automatically takes you to the first level.



## - PELLET LOAD

Allows you to load pellets after the screw feeder has emptied.

Useful for the technician during the initial start-up.

Available only in the OFF status. Any attempt to activate the function in other statuses will not be allowed.



To access the function from the main menu (as indicated in the Menu paragraph above), press the M button. Scroll using the +/- buttons and select the function by pressing OK.

To access the function from the main menu (as indicated in the Menu paragraph above), press the MENU button.

The menu items can be scrolled with the  and  buttons and the item can be entered with the  button.

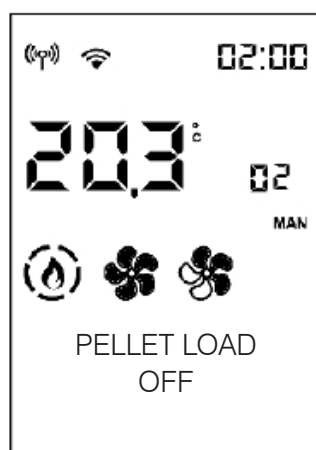
After entering the Screw Feeder Manual Loading function, the display will show the name of the function on the first line of the status bar and the current value (OFF if deactivated, ON if active).





The  and  buttons can be used to modify the value from Off (deactivated) to On (activated) and vice versa, while the "+" and "-" buttons can be used to adjust the value.

Pressing the  button automatically takes you to the first level.

## **- CHRONO PROG. (TIMER)**



To access the function from the main menu (as indicated in the Menu section above), press the MENU button.

The menu items can be scrolled with the  and  buttons and the item can be entered with the  button.

Choose the day of the week by scrolling the  and  buttons (you will simultaneously see the programme for that day) and confirm with the  button.



The cursor (rectangular and 2 pixels wide) positions itself on 00:00.  
The time at the top RH shows the start of the time slot.  
The word SET appears with the pre-set level for that time slot.

Use the  and  buttons to scroll the time with 1/2-hour steps, by moving the cursor and displaying the pre-set level.

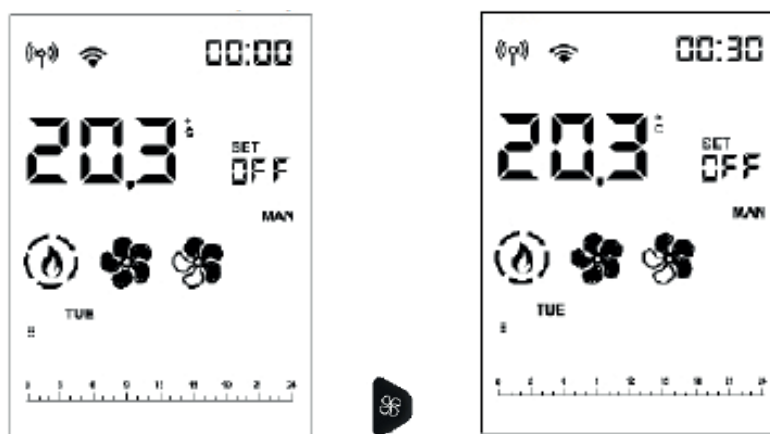

The **+** and **-** buttons can be used to modify the temperature levels (OFF – T1 and T2) or the power levels (OFF – P1 and P5).



After reaching 23:30 you must go backwards.

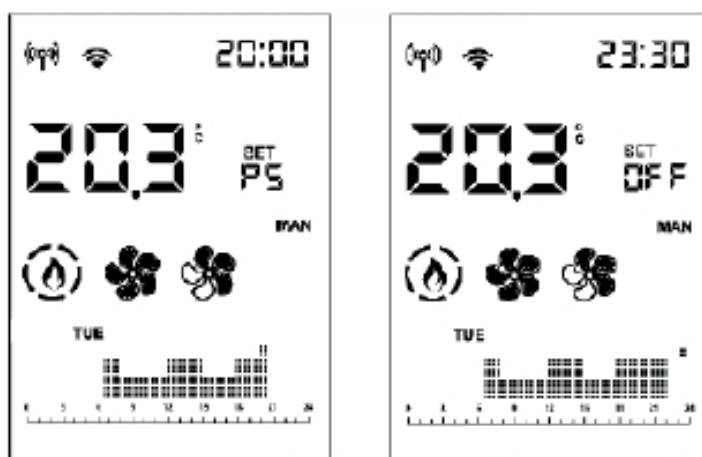

If you shift by pressing and holding the **←** and **→** buttons for more than 2", you copy the previous level onto the next level with a 1/2 h frequency per second. The level can be copied also with backward shifts.

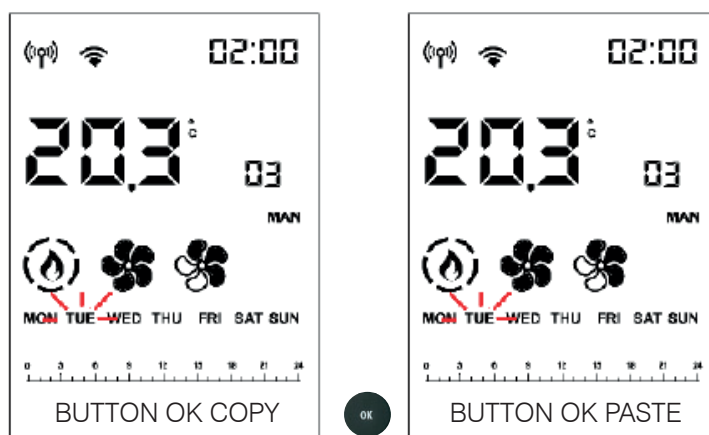

After setting the entire day, confirm with the following button





The day of the week will flash again and you can move to the next day  et 

Confirm with the following button 

Pressing the  button briefly allows you to exit the programming, but the programme will not activate.

To activate it, you must briefly press the button  again from the main page.

#### NOTE



The switching on and off of the product can be forced with the Timer active, by pressing the ON/OFF button for 2". Only if stand by is on the product switch on at the reached temperature.

## - TEMPERATURE SETTING FOR TIMER T1 - T2

To access the function from the main menu (as indicated in the Menu section above), press the MENU button.

The menu items can be scrolled with the  and  buttons and the item can be entered with the  button.

After entering the T1-T2 function, the display will show the name of the function on the first line of the status bar and the current value of T1 on the second line. T1 is the lowest temperature, T2 the highest.

Use the  and  buttons to move to set-point T2 setting.

Modify the values with the  and  buttons and confirm with the  button.

Pressing the  button automatically takes you to the first level.





## - DATE AND HOUR (TIME)

Can be used to set the current date and time.



To access the function from the main menu (as indicated in the Menu section above), press the MENU button.

The menu items can be scrolled with the  and  buttons and the item can be entered with the  button.

After entering the Date-Time function, the display will show the name of the function on the first line of the status bar and the current value of the first setting (12/24 hours) on the second line.

You can move from 12 to 24 hours using the  and  buttons and confirm with the  button.



The hours will then flash and can be modified using the  and  buttons and confirmed with the  button.

The minutes will then flash.



If the product is connected to the cloud, the date and time can be set from the Web and in the menu, after accessing the function, a message like "Date -Time from Web" will appear.

If the product is connected to a smartphone, the date and time can be set using the app.

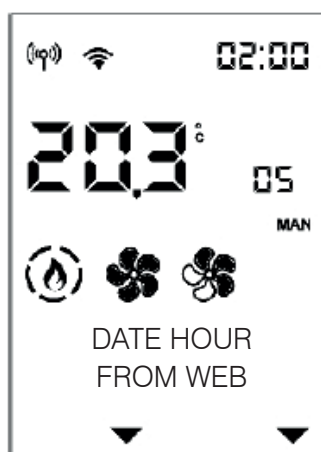



## · °C/°F SETTING of the temperature scale (centigrade or Fahrenheit degrees)

To access the function from the main menu (as indicated in the Menu section above), press the MENU button.

You can scroll the menu items with the  and  buttons and enter the item with the following button .

After entering the °C/°F function, the name of the function appears on the first line of the status bar and the current value on the second line.



You can switch from °C to °F using the  and  buttons and then confirm with the  button and exit. Pressing the OK button automatically takes you back to the first level.

## - LANGUAGE SETTING



Selects the language.

To access the function from the main menu (as indicated in the Menu section above), press the MENU button.

You can scroll the menu items with the  and  buttons and enter the item with the following button .

After entering the Language Menu item, the name of the function appears on the first line of the status bar and the current value on the second line ITALIANO that means Italian.



You can modify the language with the  and  buttons, confirm and then exit with the following button . Pressing the OK button automatically takes you back to the first level.

**- DISPLAY**

It allows you to choose the background of the display,

## - INFO

These readings should only be done when requested by the technician.

The technician understands the diagnostic meaning of the messages and values, and may ask you to read them to him/her if you experience problems.

To access the function from the main menu (as indicated in the Menu paragraph above), press the MENU button.

You can scroll the menu items with the  and  buttons.

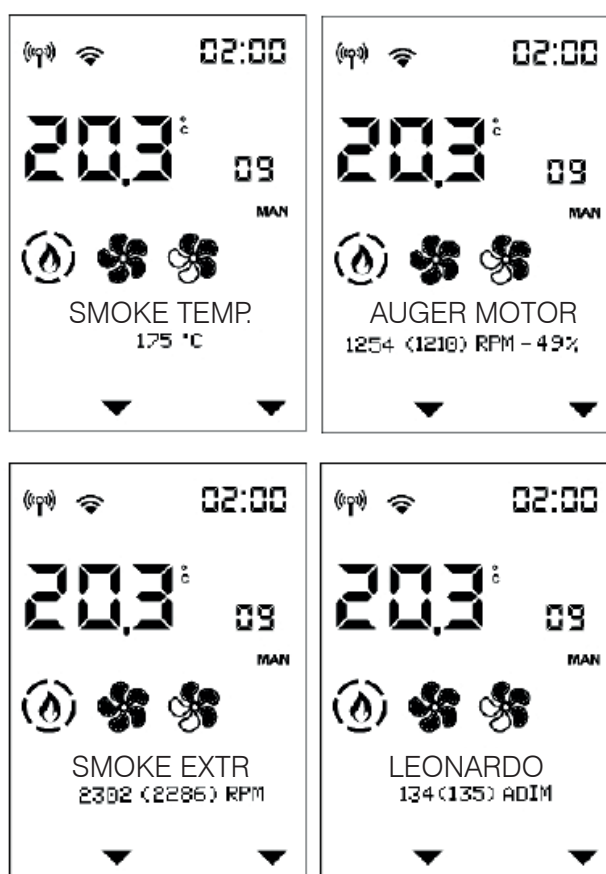

Exit with the following button



## - DATA

Information of the product's operation log can be scrolled with the  and  buttons.

To access the function from the main menu (as indicated in the Menu paragraph above), press the MENU button.

The menu items can be scrolled with the  and  buttons and the item can be entered with the  button.

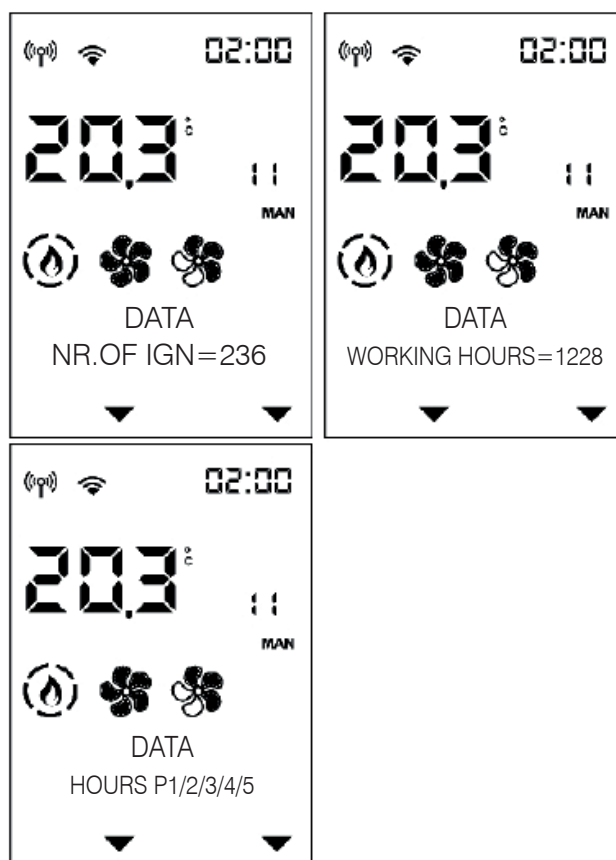

Exit with the following button 



## - ALARM LOG

Information of the product's operation log can be scrolled with the  and  buttons.

The alarms are arranged from the most recent to the oldest.

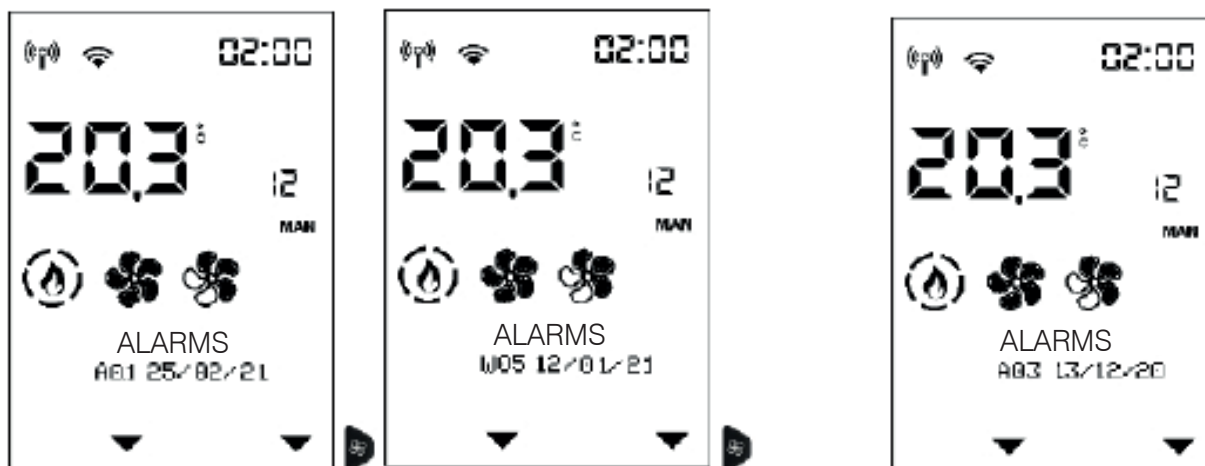

Exit with the following button



## - SCREW FEEDER ON-OFF FOR THE TECHNICIAN ONLY (ON INDICATION OF THE AFTER-SALES DEPARTMENT)

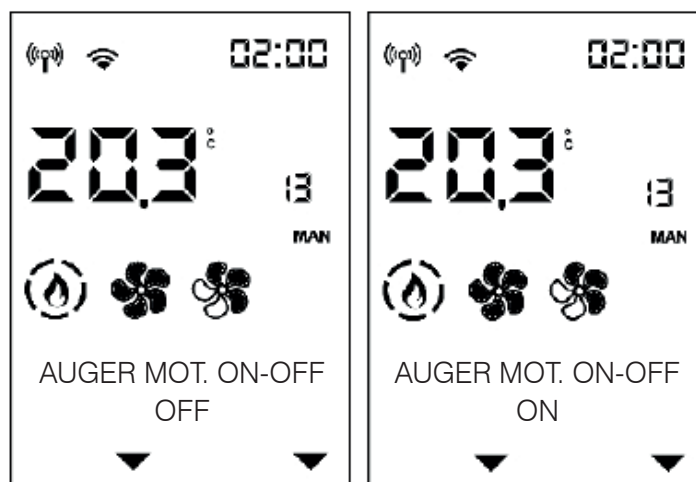

## - PELLET LEVEL SENSOR FOR THE TECHNICIAN (ENABLING)

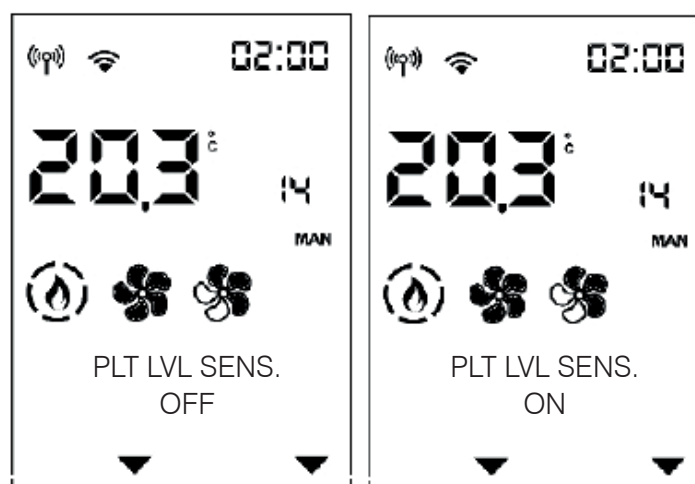

## - TECHNICAL MENU (for TECHNICIANS ONLY)

Accessible only to an authorised technician with the appropriate password.

You must enter with the installer password (1111) and access the installer parameters/settings only

- Flame type (INST)
- Pellet type (INST)
- Chimney sweep function (INST)
- Cold test
- Parameters (INST )
- Reset hours
- Smoke probe correction



### NOTES

inappropriate changes can cause the product to seize up

## - FLAME TYPE FOR THE TECHNICIAN

After entering the Technical Menu the first item “FLAME TYPE” appears

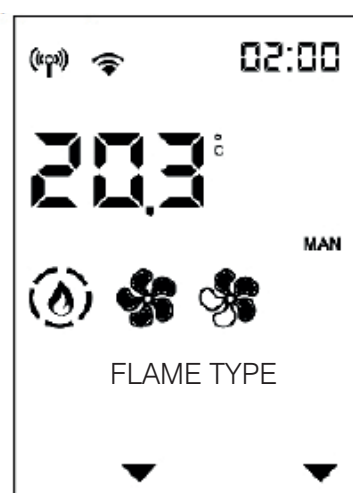

You can enter the Type of Flame setting with the 

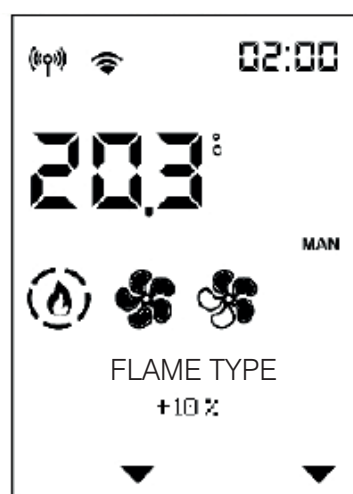

button and then modify the correction value with the  and  buttons.

Use the  button to exit and return to the Technical Menu

## - PELLET TYPE

You can scroll the Technical Menu items with the  and  buttons until you reach "PELLET TYPE"

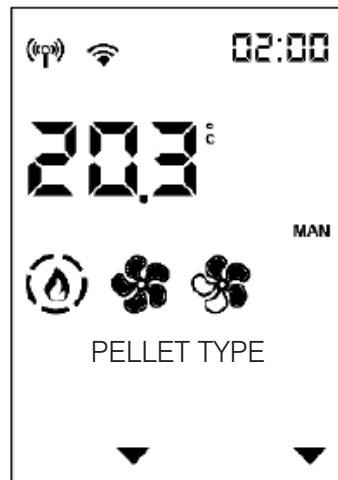

You can enter the Pellet Type setting with the following button 

and modify the value with the  and  buttons.

Use the  button to exit and return to the Technical Menu

# - CHIMNEY SWEEP FUNCTION (ONLY WITH THE PRODUCT ON)

It can be used to conduct the requested checks agreed upon with the technician

Scroll between the Nominal (Max) or Minimum (Min) function using the  and  buttons and modify the value from OFF to ON with the  and  buttons.

Use the  button to confirm the value and return to the Technical Menu

If you confirm the ON value, the chimney sweep function activates, otherwise you can deactivate it.

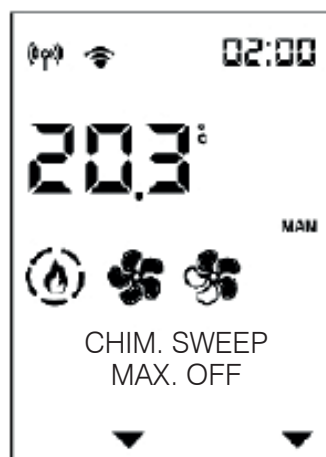
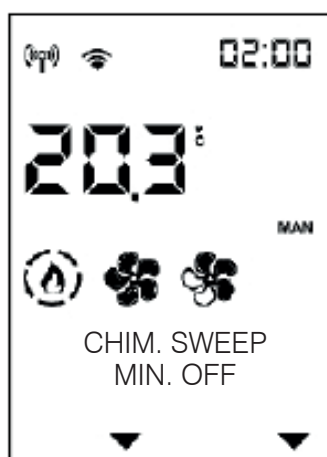



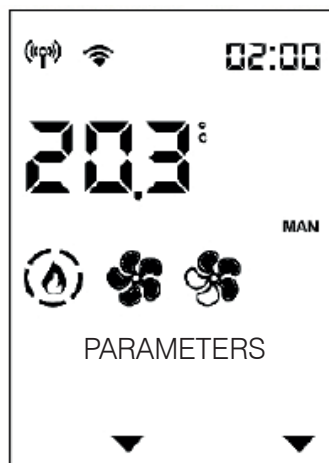

## - PARAMETERS PLEASE REFER SERVICE SUGGESTIONS

You can scroll the Technical Menu items with the  and  buttons until you reach "PARAMETERS".

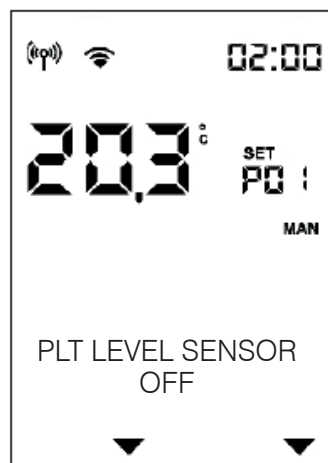

Enter the Parameters section with the  button: the first parameter will be displayed.



Scroll the parameters with the  and  buttons and modify the value with the  and  buttons.

If you entered the Technical Menu with the installer password, only the installer parameters will appear, otherwise all the other parameters will be shown.

Use the  button to exit the parameter modification section and return to the Technical Menu.



SAVE PANEL can temporarily make up for the absence of a remote control or smartphone, or other product management systems.

Controls the product starting from the pressing of the buttons.

When the remote control or smartphone re-establishes the communication and sends a command to the product, the remote control or smartphone will once again resume control of the product.

The display will ONLY appear if the product is controlled via the SAVE PANEL.

## FUNCTIONS

**To switch on the product:** press the On-Off button for a few seconds.





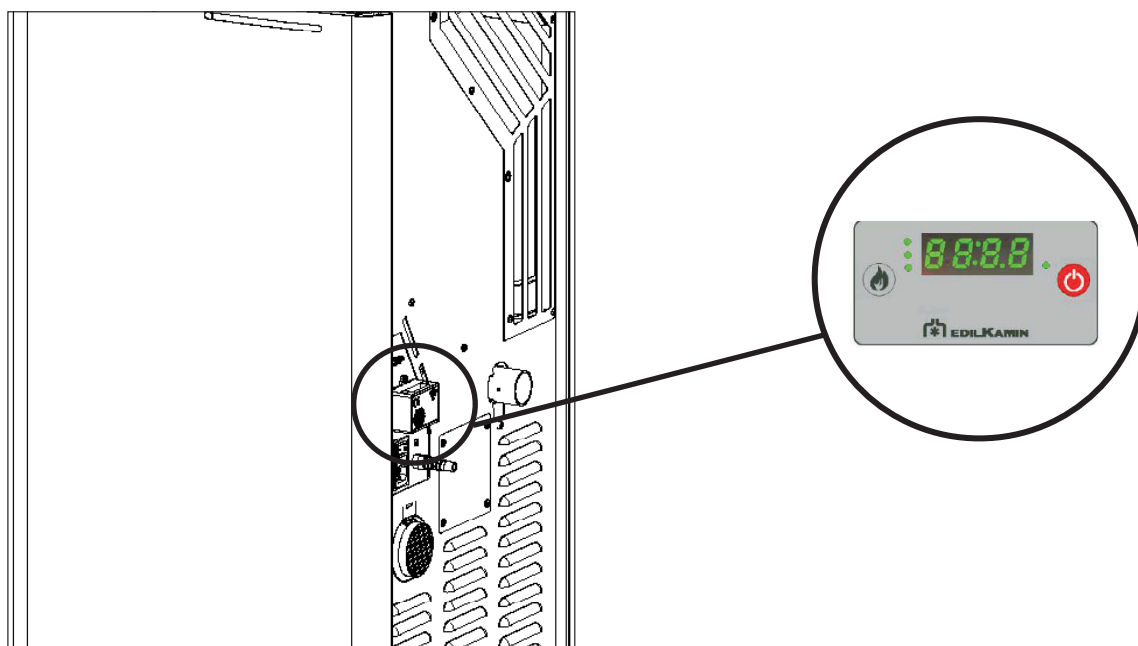

**To set the power level with the product on:** press the "power" button once. Pressing it repeatedly will cause the power to increase, with the following setting appearing on the display: "P1" – "P2" – "P3" – "P4" – "P5" – "P1" – "P2" – ... The ventilation of all room fans will automatically follow the product's power level without it being possible to adjust them.

**To switch off the product:** press the On-Off button for a few seconds.

**To unlock the product that has been locked due to an alarm:** press the On-Off button for a few seconds.

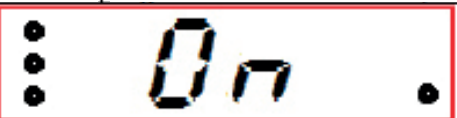
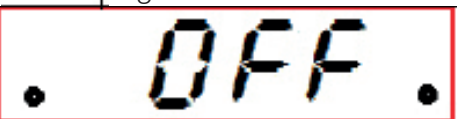
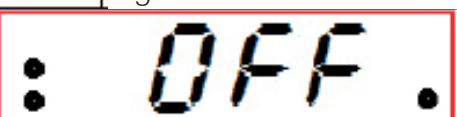
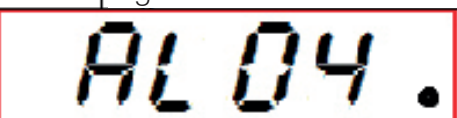

The three LEDs on the left indicate the status of the product associated with the display.

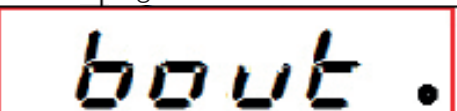
Panel without control unit	Active: LED1 (network present)
	
Stove off	Digits = "OFF" active: LED1
	
Stove being switched on	Digits = "ON" active: LED1 and LED2
	
Stove running	Digits = "ON" active: LED1, LED2 and LED3
	
Stove in cleaning mode in work mode	Digits = "ON" active: LED1, LED2, LED3 and LED4
	
Stove cooling	Digits = "OFF" active: LED1 and LED2
	
Stove cooling	Digits = "OFF". Active: LED1, LED2 and LED3
	
Stove in alarm mode	Digits = "AL XX" active: LED1
	
Stove in warning mode	Digits = "W:XX" active: LED1
	
Stove off due to blackout	Digits = "bout" active: LED1
	

**Disconnect the product from the power supply.**  
**Failure to service the product properly will prevent it from working properly.**  
**Any problems due to failure in servicing the stove will void the warranty.**



**Using the stove without cleaning the grate can cause the gas in the combustion chamber to ignite and detonate.**

### DAILY MAINTENANCE

These operations must be done with the product off, cold and preferably disconnected from the mains.

A suitable vacuum cleaner is required.

The entire procedure takes just a few minutes.

1. Open the combustion chamber door (P) using the protective lever (removable handle)
2. Empty the ash tray (B) and the grate (C) into a non-flammable container (the ashes may still contain embers and/or hot parts, or clean using a vacuum cleaner if cold. Vacuum out the interior of the fireplace, the bed, and the compartment around the grate into which the ash falls.
3. Scrape the grate with the provided scraper and clean out any obstructed holes.
4. Clean the glass (when cold) if necessary, by using a suitable product (such as Glasskamin) available at the retailer..

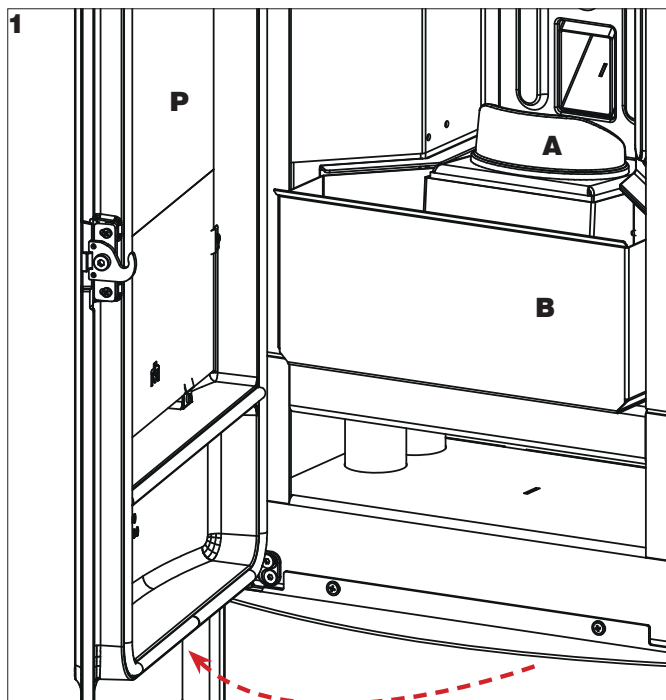



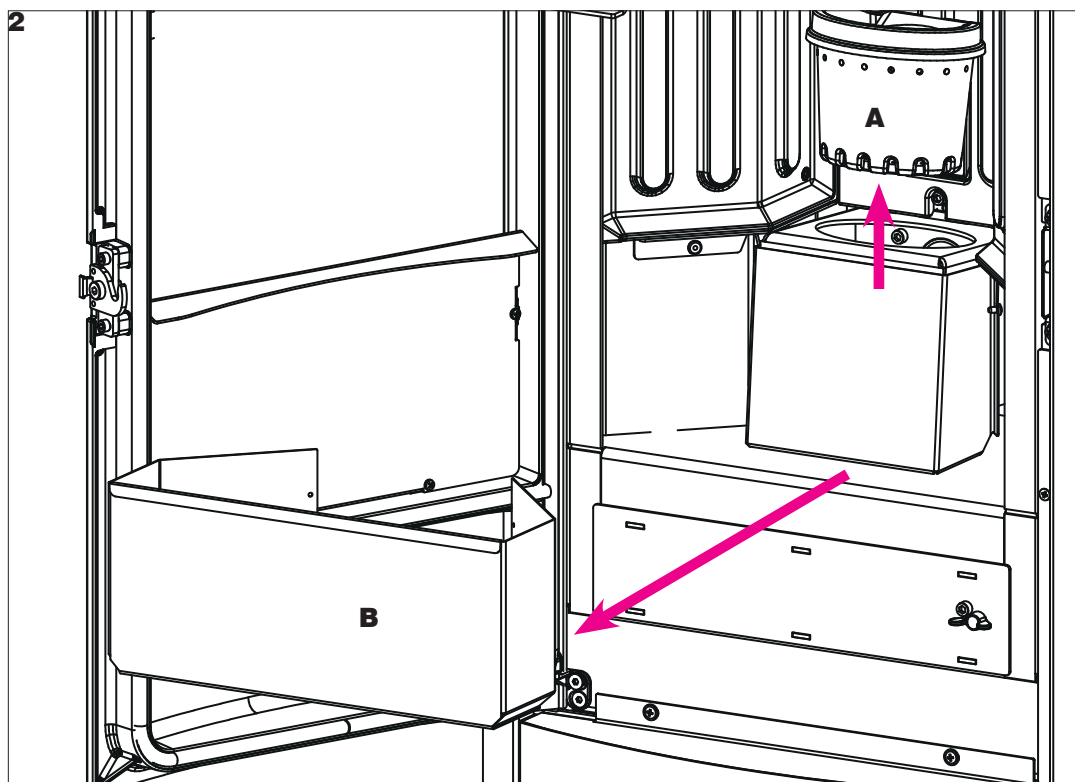

- Do not dump the cleaning residue into the pellet tank.
- Once it is refitted, make sure that the ash tray is properly placed in its housing, to avoid glass breakage when closing.
- Make sure that the grate is properly placed in its housing after maintenance operations, if not, the stove may have ignition problems.

# WEEKLY MAINTENANCE

When the product is off and cold, after having routine maintenance, you should vacuum the inspection plate under the combustion chamber (\*)

To do so:

- Remove the protection, by turning the winget nut (V).

Put back the protection after cleaning.

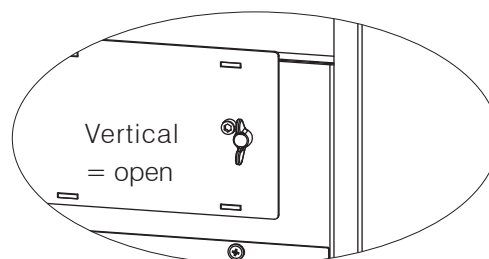
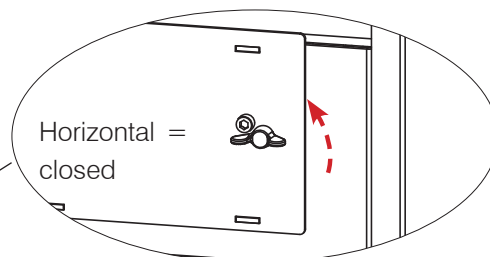
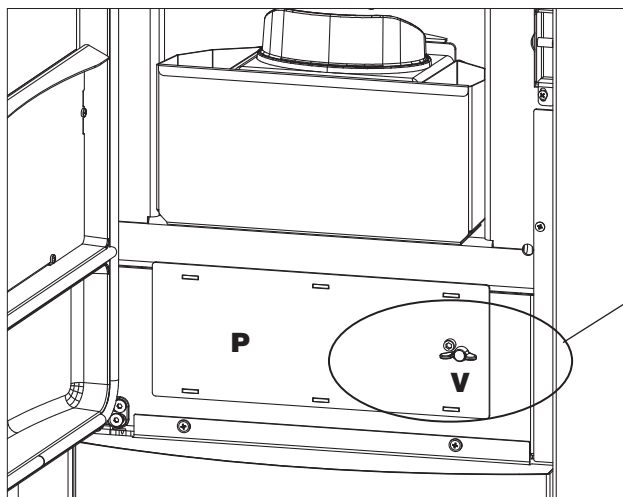

Remove the deflector and vacuum clean. Put back in position with care by placing it in its housing.

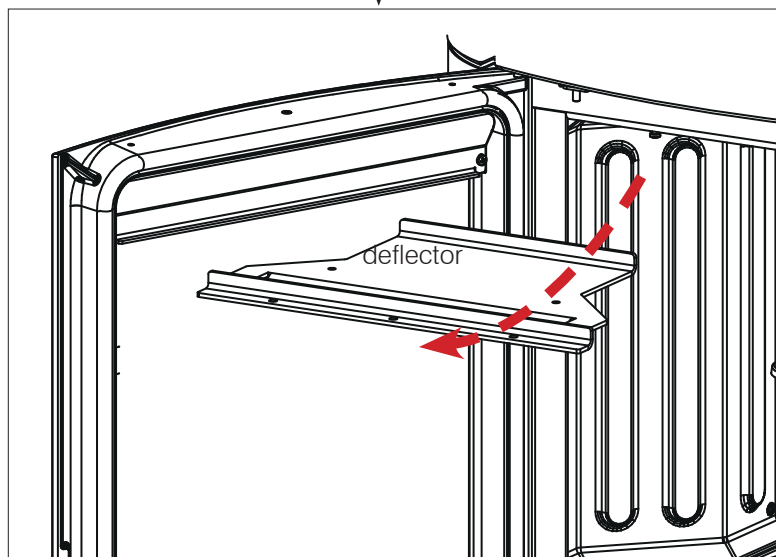
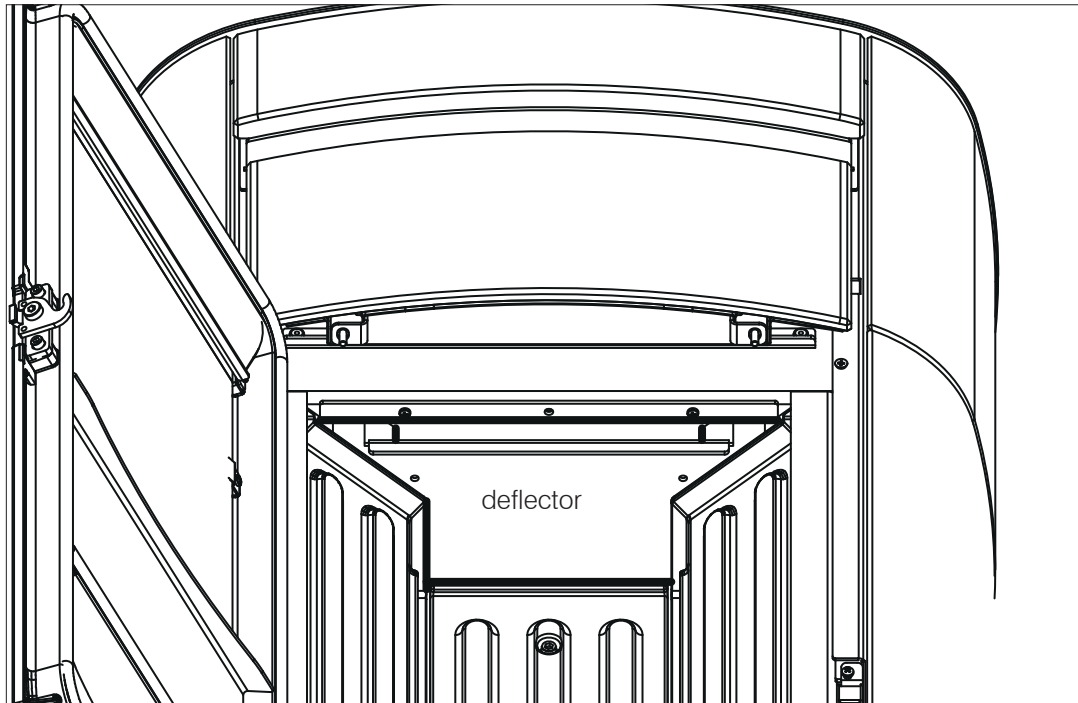

## SEASONAL MAINTENANCE

**(to be carried out by the technical assistance centre)**

This consists in cleaning the stove inside and out.

**If the product is used intensively, we recommend cleaning the smoke duct and flue every 3 months.**

You should clean the chimney system at least once a year (check local regulations for details).

If you fail to regularly clean and inspect the system, there is an increased risk of the chimney pot catching fire.

We recommend against using compressed air to clean the combustion air inlet.

## SUMMER SHUTDOWN

During the period of disuse, keep the stoves doors, hatches and lids closed.

We recommend emptying out the pellet tank. Place the package of dessicating salts inside the combustion chamber.

## SPARE PARTS

for any spare parts, contact your reseller or technician. Using non-original spare parts may damage the appliance and relieves Edilkamin of all liability for damage resulting there from.

**Do not make unauthorised modifications**

## DISPOSAL

At the end of its service life, dispose of the product as required by regulations.



In accordance with art. 26 of Legislative Decree no. 49 of 14th March 2014, "Implementation of Directive 2012/19/UE on the disposal of electrical and electronic devices (RAEE)".

The crossed-out dustbin symbol displayed on equipment or its packaging indicates that the product at the end of its life must be collected separately from other waste.

At the end of its useful life, the user should therefore deliver the product to a suitable local sorted collection centre for electrical and electronic devices.

Sorted collection for recycling, treatment and environmentally compatible scrapping contributes to the prevention of negative effects on the environment and health, and promotes the re-use and recycling of the materials of which the equipment is made.

If problems occur, the product shuts itself off automatically.

The display will show the reason (see below).

Do not disconnect from the power supply.

To restart the product, wait for the switch-off sequence to terminate and then press the ON/OFF button of the remote control or the simplified switch-on button.



Before starting the product up again, check the reason for the shutdown and CLEAN the burning pot.

The product is equipped with the necessary safety devices but, if the burning pot is not cleaned regularly as explained above, ignition may involve a slight detonation. If white smoke forms in the combustion chamber for a long time, disconnect the mains supply and wait 30 minutes before opening the door and emptying out the burning pot.

## SHUTDOWN MESSAGES AND THEIR SOLUTIONS:

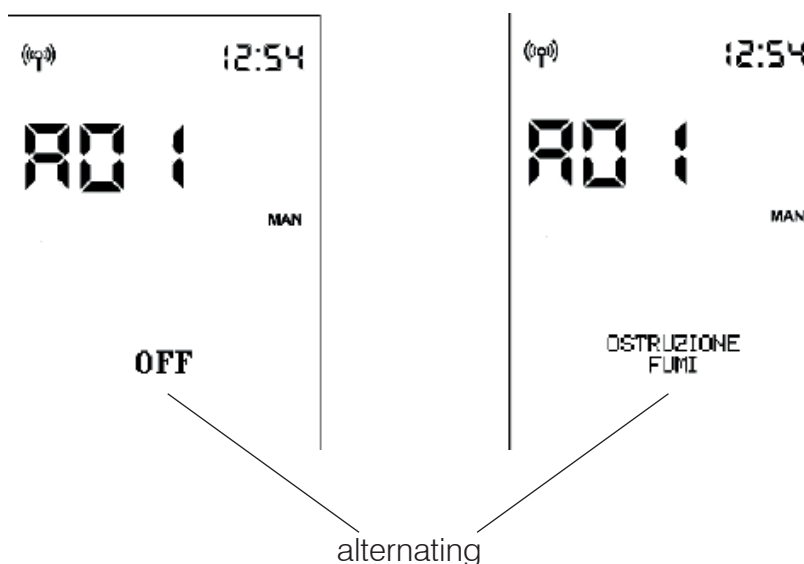

In case of an alarm, an alarm code will appear instead of the room temperature.

While the product switches off, the status bar will alternately show "OFF" in large letters and the description of the alarm in small letters.

If the alarm occurred with the timer active, only the timer's activation arrow will remain displayed, while the day's time schedule will disappear.

Once the switch-off sequence terminates, only the alarm description will remain.

## IN THE EVENT OF PROBLEMS

EDILKAMIN

MESSAGE	PROBLEM	SOLUTION
<b>A01</b>	displays when the combustion air intake is below the set level	<ul style="list-style-type: none"> <li>• Check that the combustion chamber door is closed</li> <li>• Check the regular maintenance of the product</li> <li>• Check that smoke discharge and combustion air ducts are clean.</li> </ul>
<b>A02</b>	displays when the logic board is not detecting the right fumes fan speed	<ul style="list-style-type: none"> <li>• Contact the technician</li> </ul>
<b>A03</b>	displays when the thermocouple detects a fume temperature lower than the set value and interprets this as the absence of flame	<ul style="list-style-type: none"> <li>• Check that there are pellets in the tank</li> <li>• Contact the technician</li> </ul>
<b>A04</b>	displays when ignition times out unsuccessfully	<p>There are two possibilities: NO flame:</p> <ul style="list-style-type: none"> <li>• Check that the burning pot is seated properly and clean</li> <li>• Check that there are pellets in the tank and burning pot</li> <li>• Try switching it on with a solid ecological igniter (contact the technician beforehand and follow the instructions of the igniter supplier very carefully).</li> </ul> <p>The operation must be regarded purely as a trial under the technician's guidance.</p>
<b>A05</b>	Shutdown due to air flow rate sensor breakage	<ul style="list-style-type: none"> <li>• Contact the technician</li> </ul>
<b>A06</b>	displays when the logic board determines that the fumes thermocouple is broken or disconnected	<ul style="list-style-type: none"> <li>• Contact the technician</li> </ul>
<b>A07</b>	Shut-down due to exceeding maximum fumes temperature.	<ul style="list-style-type: none"> <li>• Check the type of pellet (contact the technician if in doubt)</li> <li>• contact the technician</li> </ul>
<b>A08</b>	Switching OFF due to excessive overheating of the product	<ul style="list-style-type: none"> <li>• see A07</li> </ul>
<b>A09</b>	Shutdown due to gearmotor failure.	<ul style="list-style-type: none"> <li>• Contact the technician</li> </ul>
<b>A10</b>	Switching OFF due to circuit board overheating.	<ul style="list-style-type: none"> <li>• Contact the technician</li> </ul>
<b>A11</b>	Switching OFF due to the intervention of the safety pressure switch.	<ul style="list-style-type: none"> <li>• Ensure the product and flue are clean</li> <li>• Contact the technician</li> </ul>

MESSAGE	PROBLEM	SOLUTION
<b>A12</b>	Room temperature probe failure. The product is operating in manual mode.	<ul style="list-style-type: none"> <li>• Contact the technician</li> </ul>
<b>A14</b>	Ducting room temperature probe (if present) fault. The product is operating in manual mode.	<ul style="list-style-type: none"> <li>• Contact the technician</li> </ul>
<b>A20</b>	Gearmotor fault switch-off	<ul style="list-style-type: none"> <li>• Contact the technician</li> </ul>

**MESSAGES WHICH DO NOT SHUT THE STOVE DOWN, BUT ARE SIMPLY WARNINGS****LOW REMOTE CONTROL BATTERY LEVEL:**

The battery symbol displays on the remote control display if the battery is low.

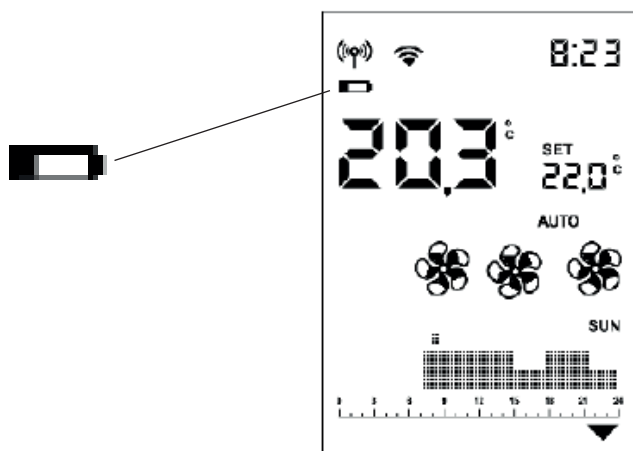
**MAINTENANCE:**

A spanner symbol will appear on the display after 2,000 hours of operation.

The product is working, but it must be serviced by an authorised Edilkamin technician.

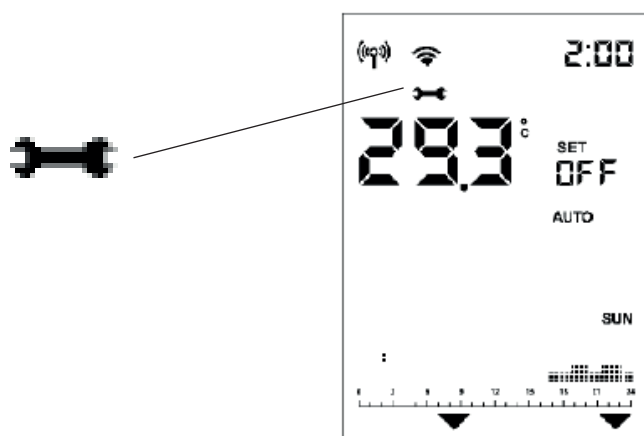
**LACK OF COMMUNICATION:**

In case of a prolonged lack of communication between the stove and the remote control, the Bluetooth transmission icon will disappear as well as the icons transmitted by the circuit board to the remote control. Only the room temperature and the time will remain visible.



The Wi-Fi transmission icon will only be present if there is a connection between the circuit board and the Wi-Fi router.



**PELLETS RESERVE INDICATOR:**

The function is only available if the pellet level sensor is installed and has been activated.

When the level sensor intervenes, the circuit board emits a single “beep” (in any switch-on or work status) and the moving reserve symbol will appear on the display.

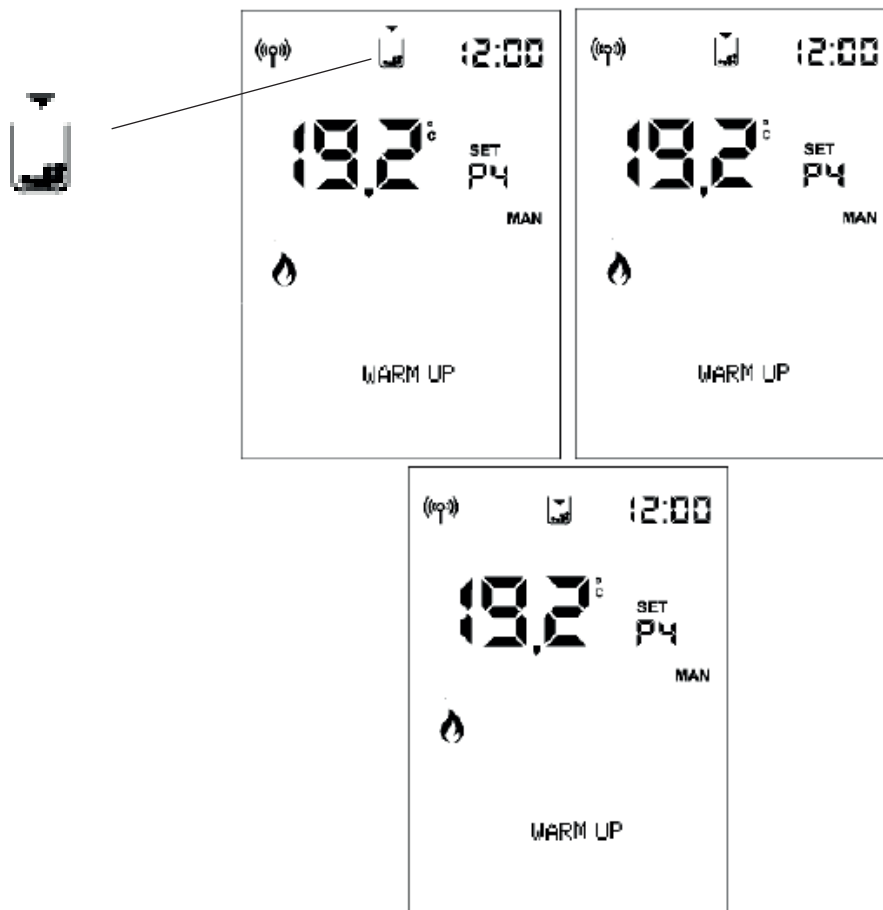

The arrows will light up in sequence to signal the need for pellet loading.

The ignition frequency is roughly 0.5 seconds.

After an interval of roughly 20/30 minutes, which varies depending on the model, the stove switches off due to a shortage of pellets.

If the user reloads the stove before the start of the switch-off procedure, the symbol disappears and the stove resumes its normal operation.

If the user fails to reload the stove before the start of the switch-off procedure, the stove switches off and the tank symbol remains steady lit with the 3 arrows on until the next reloading operation.

When the reserve symbol is present, the stove cannot be restarted.

After reloading the pellets, the stove must be restarted manually.

If the pellets are reloaded and there is an ignition request coming from the timer, the stove will restart.

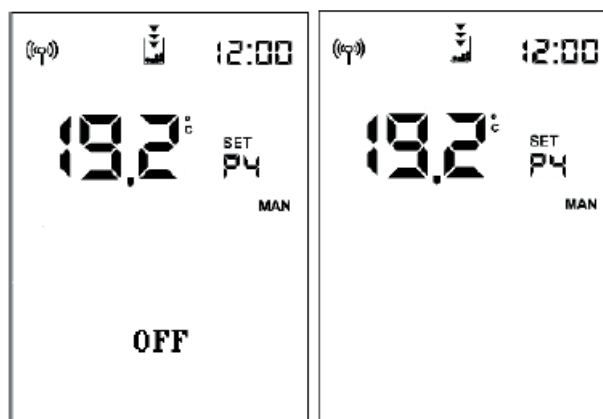

If the sensor intervenes:

- with the stove OFF or in Initial Cleaning mode (following manual emptying of the tank), the final symbol will immediately appear and the stove cannot be switched on;
- during the ignition phase, the ignition sequence will be completed even if it lasts more than the 20/30 minutes of residual autonomy.

If the pellets are not reloaded, the stove will then switch off.

During a switch-off following a **BLACKOUT**, the display will alternately show the words "Black-Out" and "OFF". Once the switch-off has been completed, the product will remain off and "Black-Out" will appear.

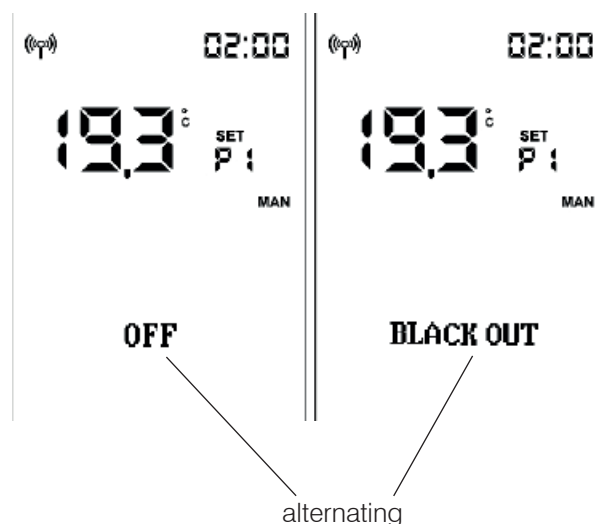





**EDILKAMIN**  
TECNOLOGIA DEL FUOCO

[www.edilkamin.com](http://www.edilkamin.com)

cod. 942218-GB

03.21/A